

SHORELINE SURVEY MAP
LOT 1-D
BEING A PORTION OF R. P. 4481,
L. C. AW. 7713, AP. 2, PART 7 TO V. KAMAMALU

At Hanamaulu, Lihue, Kauai, Hawaii
Date: November 26, 2024
Tax Map Key: (4) 3-7-003: 014
Owner: Kauai Beach Villas
Address: 4330 Kauai Beach Drive
Lihue, HI 96766

- LEGEND:**
- cmu concrete masonry unit
 - conc concrete
 - crm concrete rubble masonry
 - cslab concrete slab
 - dia diameter
 - ht height
 - lp light post
 - smh sewer manhole
 - sw sidewalk
 - sp spread

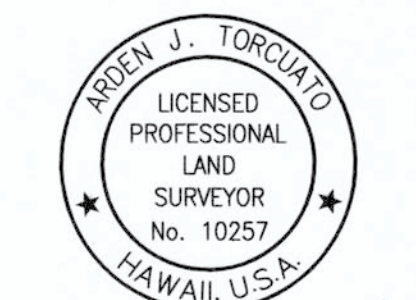

This map was prepared by me or under my direct supervision
Andren J. Torcuato

LICENSED PROFESSIONAL LAND SURVEYOR
CERTIFICATE NUMBER 10257 - Exp. 4/30/2026
LEAPS & BOUNDARIES, INC.
2016 WATERHOUSE ST., STE. 101 PH. (808) 484-5701
HONOLULU, HI 96819 EMAIL: SURVEYS@LEAPSANDBOUNDARIES.COM

NOTE:
① Picture Number & Direction