



Photo 1
SL-1
November 19, 1:05 p.m.

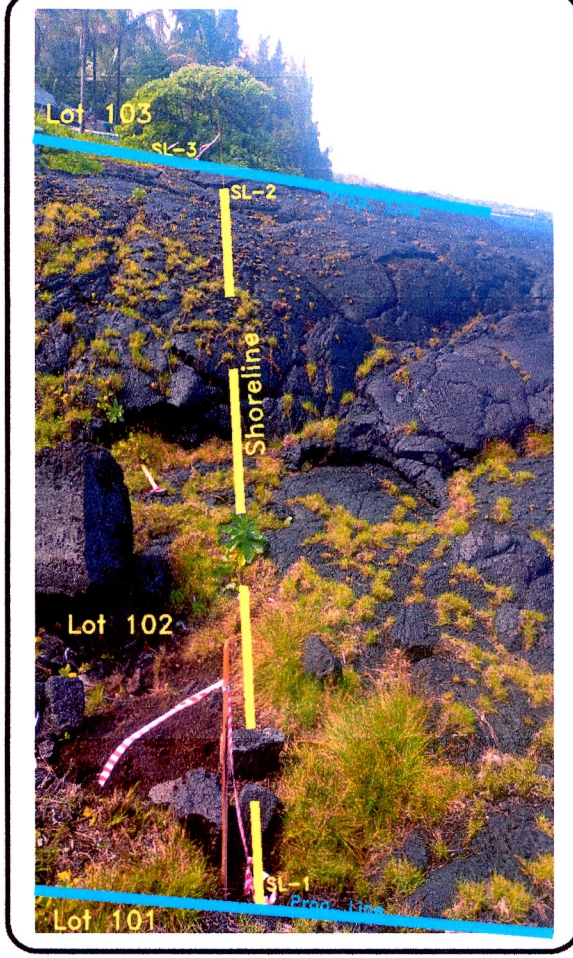

Photo 2
SL-1 LOOKING WNW
November 19, 1:05 p.m.



Photo 3
SL-2 LOOKING MAUKA
November 19, 1:05 p.m.

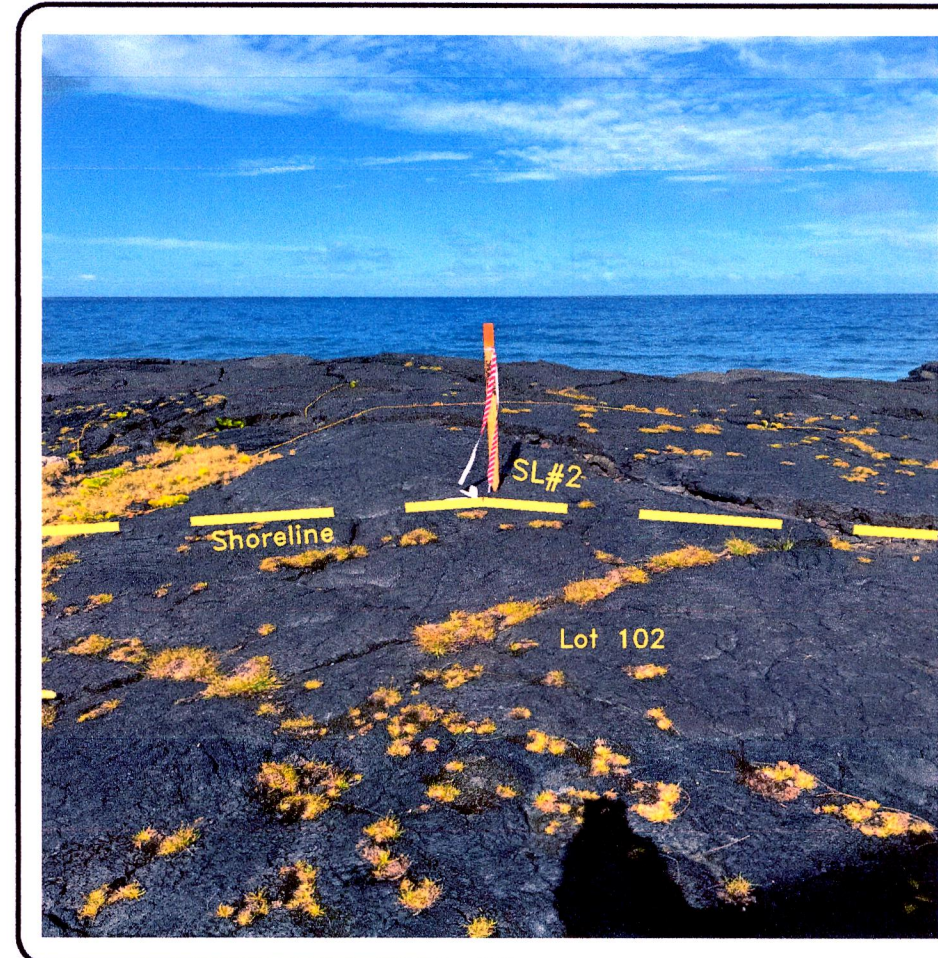

Photo 4
SL-2 LOOKING MAKAI
November 19, 1:05 p.m.

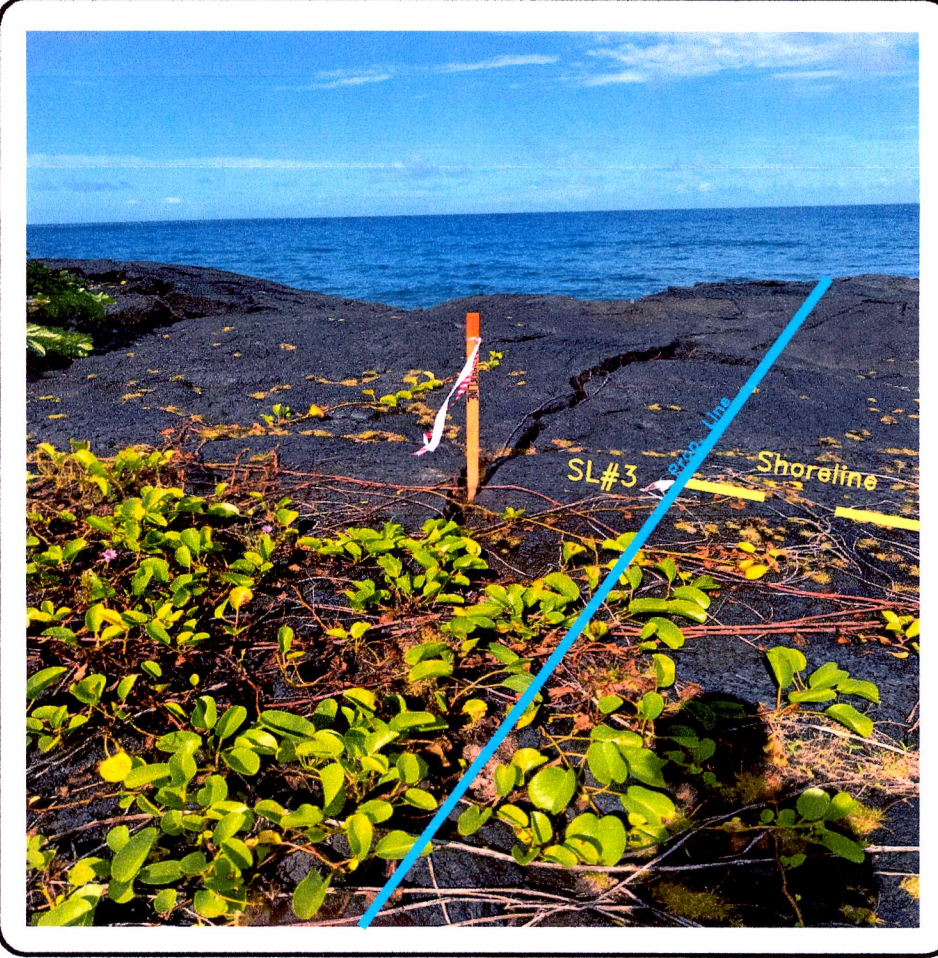

Photo 5
SL-3 LOOKING MAKAI
November 19, 1:05 p.m.

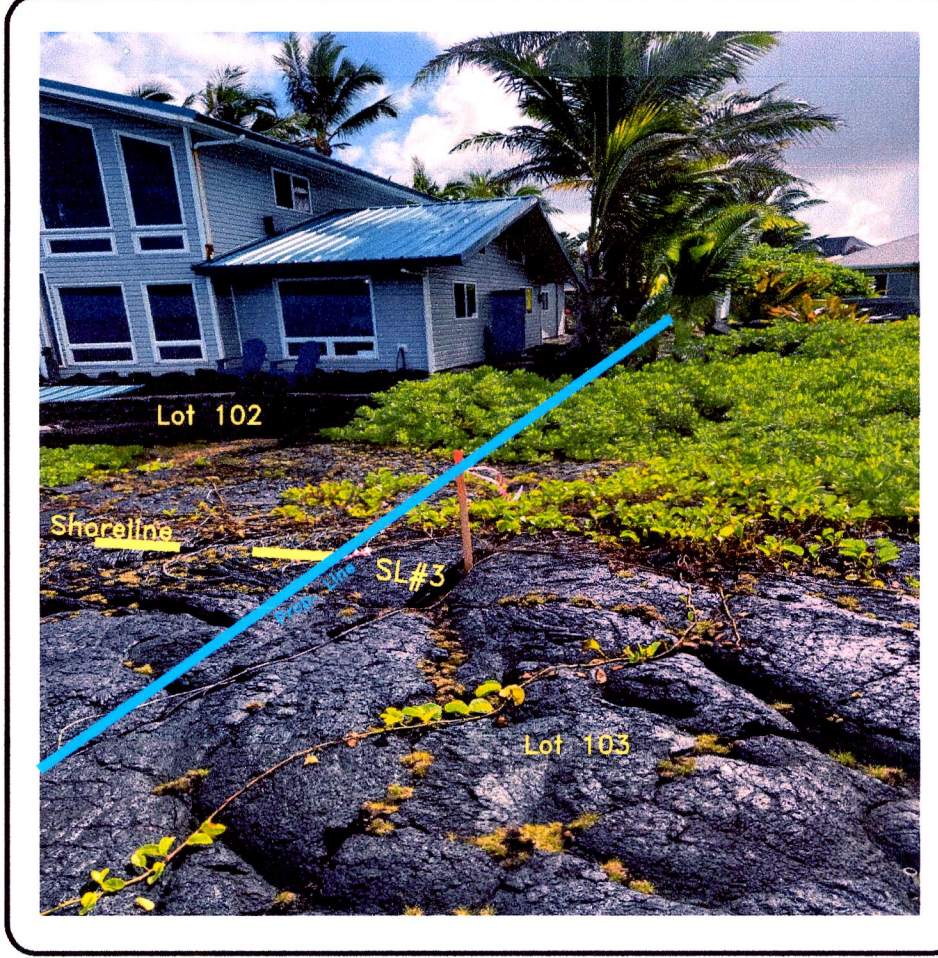

Photo 6
SL-3 LOOKING MAUKA
November 19, 1:05 p.m.

Property Situs:
15-1075 Ala Heiau Road
Pahoa, HI.

Owners:
Robert E Drew & Merris Leann Gold-Drew,
HC 3 Box 10003,
Keaau, Hawaii 96749-9201

NOTES:

1. Field survey dated November 13, 2024.
2. Boundary courses are record per Hawaiian Paradise Park Subdivision, Land Court Appl. 1053, Map 66.
3. Shoreline defined by highest wash of the waves as determined from vegetation and debris line.
4. Areas:
Lot 102
0.45 ac. 19,602 sq.ft.
Shoreline Area.
0.087 ac. 3,783 sq.ft.
Net area:
0.363 ac. 15,819 sq.ft.



Indicates photo location and orientation on map sheet.

Certified Shoreline Survey
Of Lot 102, Block 11,
Hawaiian Paradise Park Subdivision,
Keaau, Puna,
Island and County of Hawaii, Hawaii.
TMK(3) 1-5-031: 072



This work was prepared by me or under my direct supervision.
Daniel L. Berg
Daniel L. Berg
Licensed Professional Land Surveyor
License Number 11245



P.O. 49-2281 Keaau, HI 96749
Ph. 966-4206
www.dlbandassoc.com