

FARRINGTON HIGHWAY

296°02'30" → 80.00

(LOT 5)

(LOT 4)

(LOT A)

DEED: KAMEHAMEHA IV TO J. ROBINSON AND COMPANY DATED MAY 13, 1857 AND RECORDED IN LIBER 9, PAGE 233

EASEMENT 20

EASEMENT 21

PARCEL 4

PARCEL 3
15,393 SQ. FT.
(10,834 SQ. FT.)

PARCEL 21

(LOT 237)

(LOT 238)

(LOT 1636)

LAND

COURT

APPLICATON

SHORELINE AS CERTIFIED ON JUNE 17, 2017
AND JUNE 16, 2020 ALONG VEGETATION LINE
AND RELOCATED ON AUGUST 1, 2024

1/2" pipe
point on line

1/2" pipe
point on line

203.06

205'48"

60.82

291°07' → 15.84

290°02' → 15.00

278°00' → 13.94

285°40' → 14.17

282°00' → 11.70

253°20' → 14.51

62.01

181.77

25'48"

82.70

101°07'30"

EROSION AREA
(4559 SQ. FT.)

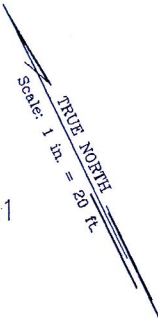

S E A

SHORELINE MAP

PARCEL 3

Makaha, Waianae, Oahu, Hawaii

Date: August 1, 2024

Tax Map Key: (1)8-4-03: 3

Owner: Wei Ling Fung

This work was prepared by me
or under my supervision

Wesley T. Tengan EXP. 4/26
WESLEY T. TENGAN
LICENSED PROFESSIONAL LAND SURVEYOR
Certificate Number 6958

Note: denotes position and direction of photograph