



Photo 1
October 25, 8:05 a.m.

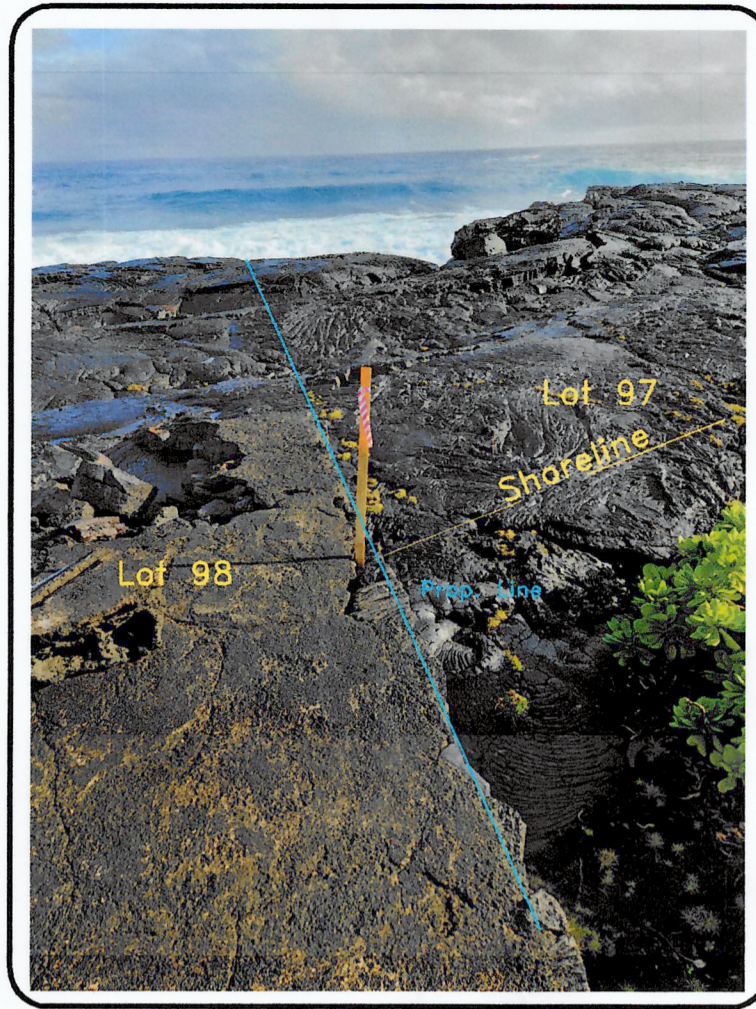

Photo 2
October 25, 8:05 a.m.

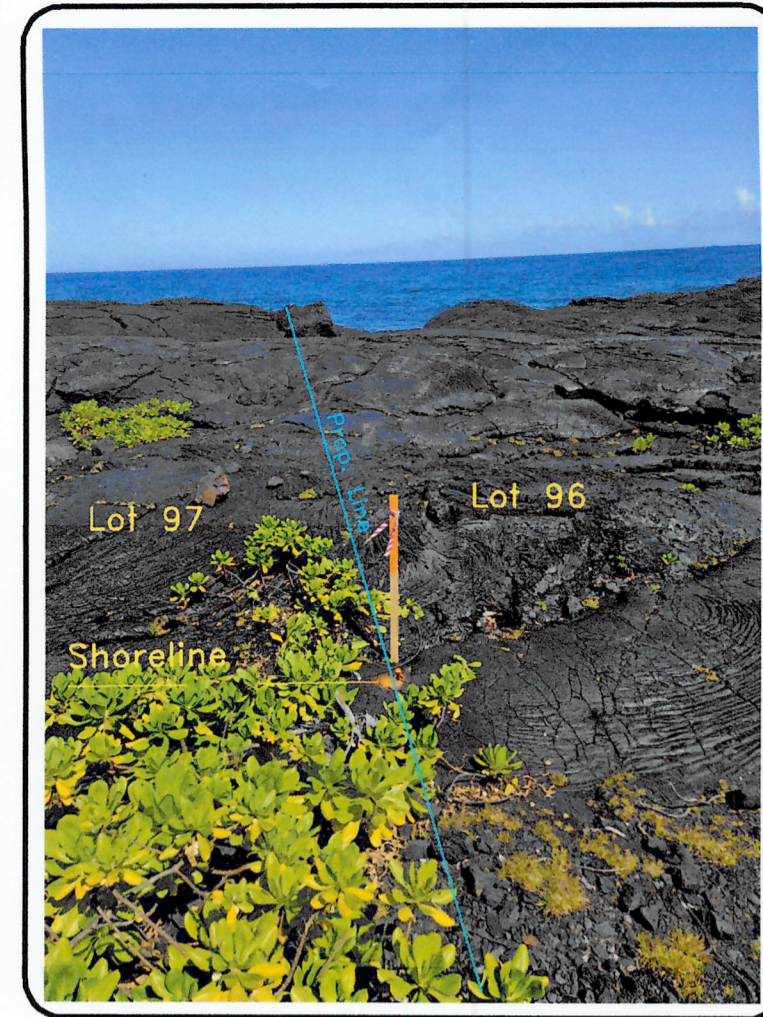

Photo 3
October 21, 11:05 a.m.

Property Situs:
15-1091 Ala Heiau Rd.

Owners:
Johnson, Kermit
279 Akolea Rd.
Hilo, HI. 96720-6714

NOTES:

1. Field survey dated October 21, 2024.
2. Boundary courses are record per Hawaiian Paradise Park Subdivision, Land Court Appl. 1053, Map 66.
3. Shoreline defined by highest wash of the waves as determined from vegetation and debris line.
4. Areas:
Lot 97
0.64 ac. 27,878 sq.ft.
Erosion area, makai of shoreline.
0.135 ac. 5,894 sq.ft.
Net area:
0.505 ac. 21,954 sq.ft.

Certified Shoreline Survey
Of Lot 97, Block 11,
Hawaiian Paradise Park Subdivision,
Keaau, Puna,
Island and County of Hawaii, Hawaii.
TMK(3) 1-5-031: 067



This work was prepared by me or
under my direct supervision.
Daniel Berg
Daniel L. Berg
Licensed Professional Land Surveyor
License Number 11245

dlb & Associates
LAND SURVEYING • MAPPING • CONSULTING

P.O. 49-2281 Keaau, HI 96749
Ph. 966-4206
www.dlbandassoc.com