

EXISTING VEGETATION LINE SEA

SHORELINE FOLLOWS ALONG TOP BANK AS CERTIFIED MARCH 13, 1997 AND SURVEYED APRIL 29, 2024

Photo Label and Direction

302° 17' 40" 106.90'

LOT 1180
0.955 Acres

LOT 260
(MAP 22)

LOT 262
(MAP 22)

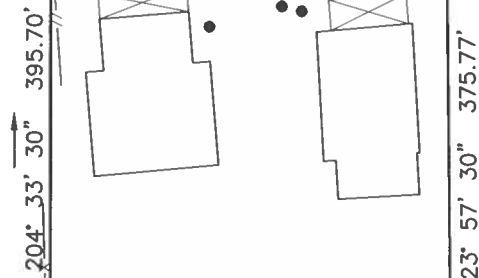

L A N D C O U R T A P P L I C A T I O N 1 0 9 5

111° 39' 30" 110.00'

KAMEHAMEHA HIGHWAY

SURVEY MAP

LOT 1180
MAP 142, LAND COURT APPLICATION NUMBER 1095

AT KOOLAULOA, CITY AND COUNTY OF HONOLULU,
STATE OF HAWAII

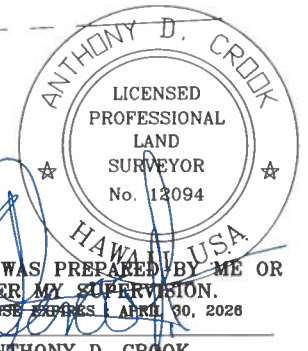

THIS MAP WAS PREPARED BY ME OR UNDER MY SUPERVISION.
MY LICENSE EXPIRES 1 APRIL 30, 2028

ANTHONY D. CROOK
LICENSED PROFESSIONAL LAND SURVEYOR
CERTIFICATE No. 12094

Owner: Steven & Carla Lenhoff
Address: 56-155D Kamehameha Hwy
Kahuku, HI 96731