

Note: Residential dwelling and swimming pool at North side of Lot 60-A not shown on map.

LEGEND	
	sand bags

LINE	SOUTH AZ	HORIZ DIST
L1	45°22'44"	7.49'
L2	18°23'48"	15.19'
L3	92°06'34"	22.14'
L4	98°19'29"	26.79'
L5	97°37'11"	42.05'

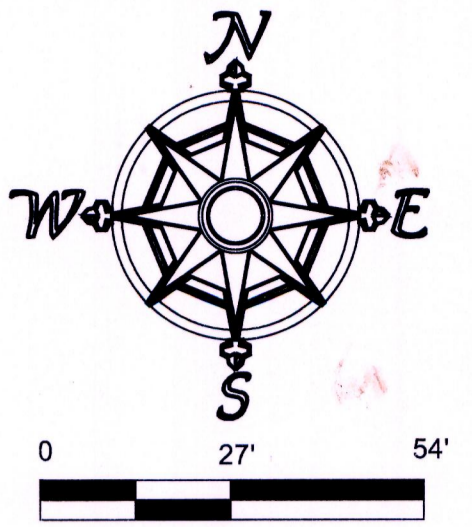

KAUMUALII HIGHWAY

Lot 61-A

LOT 60-A
Total Area 1.216 Acres
Less Erosion 0.156 Acre
Net Area 1.060 Acres

272°00'00"
218.05'

317°28'00"
LC=28.28'
R=20.00'

32°00'00"
LC=40.00'
R=40.00'

found 1/2" pipe

32°00'00"
LC=40.00'
R=40.00'

found 1/2" pipe

99°16'08"
98.79'

KIKIAOLA PLACE

Lot 61-B

Lot 60-B

Lot 60-C

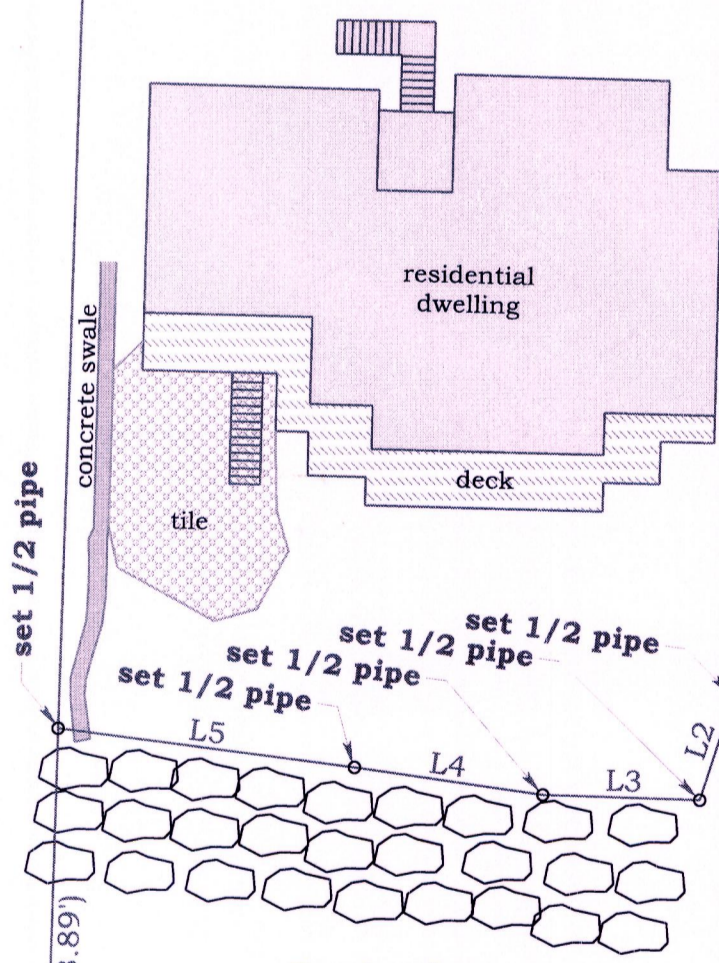

Erosion Area
0.103 Acre

Erosion Area
0.053 Acre

shoreline follows along top slope and vegetation line as located on November 11, 2023

shoreline follows along top bank and vegetation line as located on January 16, 1992

boundary follows along vegetation and/or debris line as of June 30, 1983

SHORELINE SURVEY OF LOT 60-A

Lnd. Ct. App. 1076, Map 31
Kikiaola, Waimea, Kauai, Hawaii
Tax Map Key: (4) 1-2-013: 031

SEA



THIS WORK WAS PREPARED BY ME
OR UNDER MY DIRECT SUPERVISION.

ROGER M. CAIRNES
Licensed Professional Land Surveyor
Certificate Number 7919
Expires 04/30/24

CLS - HAWAII
Land Surveying & Mapping
PO Box 777
Kalaheo, Kauai, Hawaii 96741