

PHOTO LABEL AND DIRECTION

TMK 5-5-002-090

255° 00' 00" 81.50'

EASEMENT "D"



1" = 20'
GRAPHIC SCALE

0 10 20

Shoreline follows along the edge of vegetation as certified 8/27/1975 and survey 6/11/2022

KAMEHAMEHA HWY

TMK 5-5-002-023

772

TMK 5-5-002-065
(11,019 S.F.)

180° 28' 00" 65.66'

225° 28' 00"

28.28'

R=20.00'

APPLICATION

178° 06' 45"

12.01'

R=1,067.10'

COURT

270° 28' 00" 44.72'

LOT 104-B
(10,911 S.F.)

OCEAN

348° 31' 30" 122.04'

90° 28' 00" 168.02'

TMK 5-5-002-024

SHORELINE MAP

TMK 5-5-002-065

BEING ALL OF LOT 104-B

LAND COURT APPLICATION 772, MAP 29

AND A PORTION OF ROYAL PATENT 7494,

LAND COMMISSION AWARD 8559-B, APANAS 35 AND 36

TO WILLIAM C. LUNALILO

AT LAIE, KOOLAULOA, OAHU, HAWAII

MAP DATED: August 4, 2022

Owner: Property Reserve, Inc
c/o Jeffrey Tyau
55-510 Kamehameha Hwy
Laie, HI 96762

Property Address:
55-381B Kamehameha Hwy
Laie, HI 96762

AILANA SURVEYING & GEOMATICS LLC
PHONE (808)346-1818
INFO@AILANASURVEYING.COM

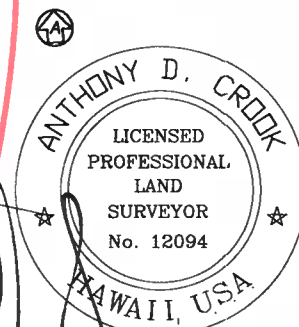

THIS MAP WAS PREPARED BY ME OR UNDER MY SUPERVISION.
MY LICENSE EXPIRES APRIL 30, 2024

ANTHONY D. CROOK
LICENSED PROFESSIONAL LAND SURVEYOR
CERTIFICATE No. 12094

TMK(1) 5-5-002-065