

KUHIO BAY

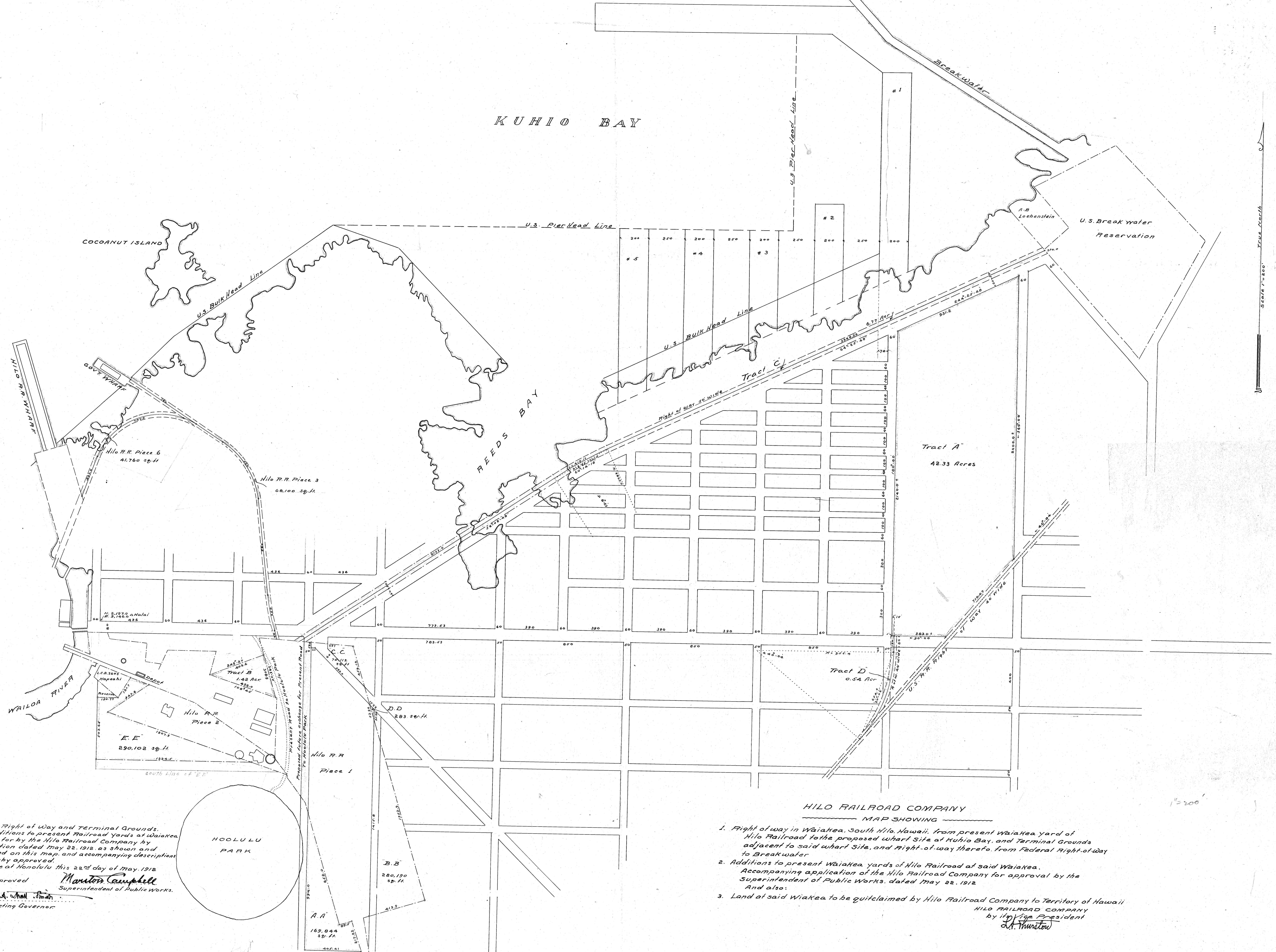

Scale 1" = 200'

HILO RAILROAD COMPANY
MAP SHOWING

1. Right of way in Waiakea, South Hilo, Hawaii, from present Waiakea yard of Hilo Railroad to the proposed wharf site of Kuhio Bay, and Terminal Grounds adjacent to said wharf site, and Right-of-way therefor from Federal Right-of-way to Breakwater
 2. Additions to present Waiakea yards of Hilo Railroad of said Waiakea. Accompanying application of the Hilo Railroad Company for approval by the Superintendent of Public Works, dated May 22, 1912. And also:
 3. Land of said Waiakea to be quitclaimed by Hilo Railroad Company to Territory of Hawaii
- HILO RAILROAD COMPANY
By *J. H. Thurston*, President

The Right of Way and Terminal Grounds, and additions to present Railroad Yards at Waiakea, applied for by the Hilo Railroad Company by application dated May 22, 1912, as shown and described on this map, and accompanying descriptions are hereby approved.

Done at Honolulu this 22nd day of May, 1912

Approved: *Marston Campbell*
Superintendent of Public Works.

S. A. Smith
Acting Governor