

Hilo Railroad  
Section A  
Approved July 21, 1909

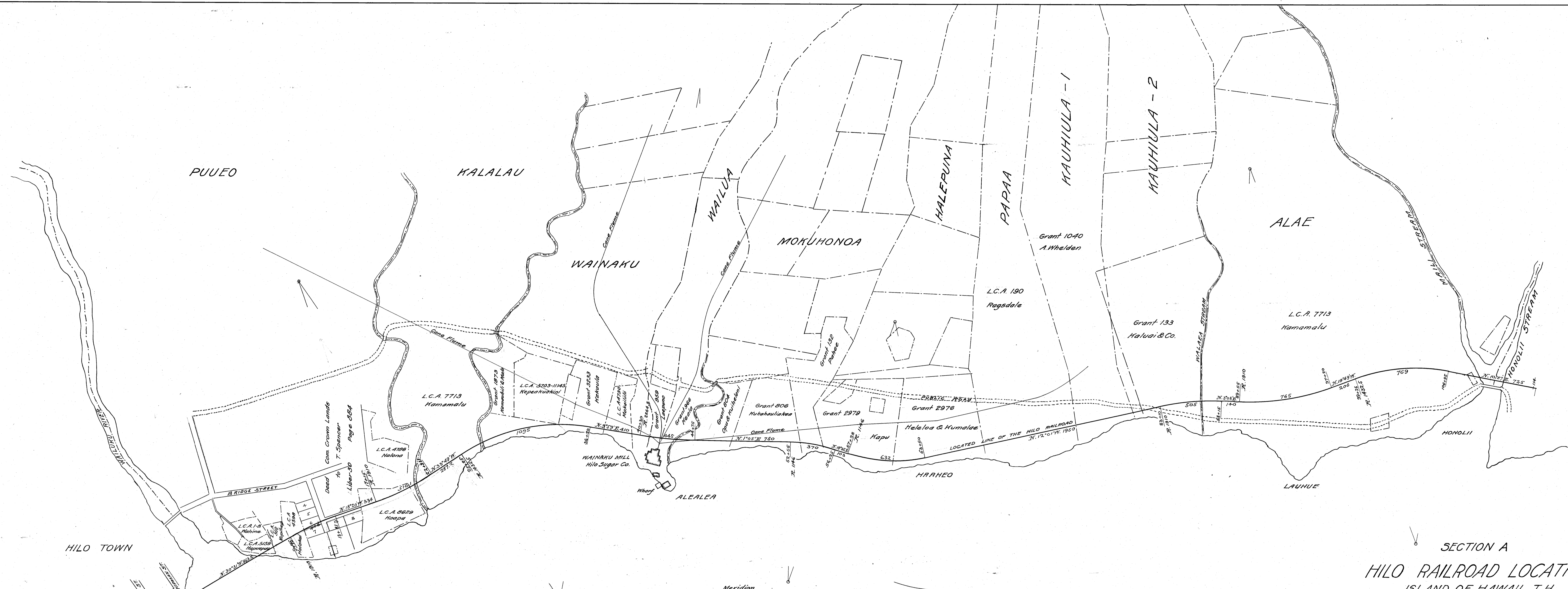

SECTION A  
HILO RAILROAD LOCATION  
ISLAND OF HAWAII, T.H.

C. N. Kluegel  
Chief Engineer

SCALE 300 FT. TO 1 INCH  
L. A. Thurston  
President Hilo Railroad Co.

Approved July 21, 1909  
Marston Campbell  
Superintendent of Public Works

Approved July 24, 1909  
W. A. Peary  
Governor, Territory of Hawaii

P. F. Posters  
No. 1 10 1  
R 35.1

Hilo Railroad  
Section A  
Approved July 21, 1909

8  
15-21

114