

Lots 349-350

Olaa Reservation Lots

Dr. W. L. Moore

Gr 4346

349

350

349

350

File in Carton 186

For Grant to Dr. W. L. Moore
 Purchase Price \$ 471.8

Notes of Survey and Plan
of Oloa Reservation Lots Nos 349 and 350.

Part of Leases Nos 53-122 to

Dr. W. L. Moore

Beginning at the East corner of Lot No 349 at junction of Side Road with the Volcano Road; which point is S 34° 12' N (True) 30 feet from the South corner of Lot No 344, the coordinates of said South corner of Lot No 344 being 45.210.32 feet South and 36.205.54 feet West of Oloa Trig Point; and running:-

N 55° 48' W True	3630.	feet along Side Road;
S 34° 12' N	1200.	" " Lot No 351;
S 55° 48' E	3532.	" " " " 359. and 360;
N 33° 50' E	300.	" " The Volcano Road;
N 56° 10' W	150.	" " Forest Reservation;
N 33° 50' E	416.	" " " " " ;
N 55° 10' E	280.	" " " " " ;
N 34° 12' E	112.	" " " " " ;
S 55° 48' E	150.	" " " " " ;
N 34° 12' E	100.	" " The Volcano Road to the point of beginning,

Containing 95.30 Acres

Hilo Hawaii
April 1st 1849

E. W. Baldwin
 Surveyor

022-283-320
 Old Mrs. ...
 D. M. ...
 2437

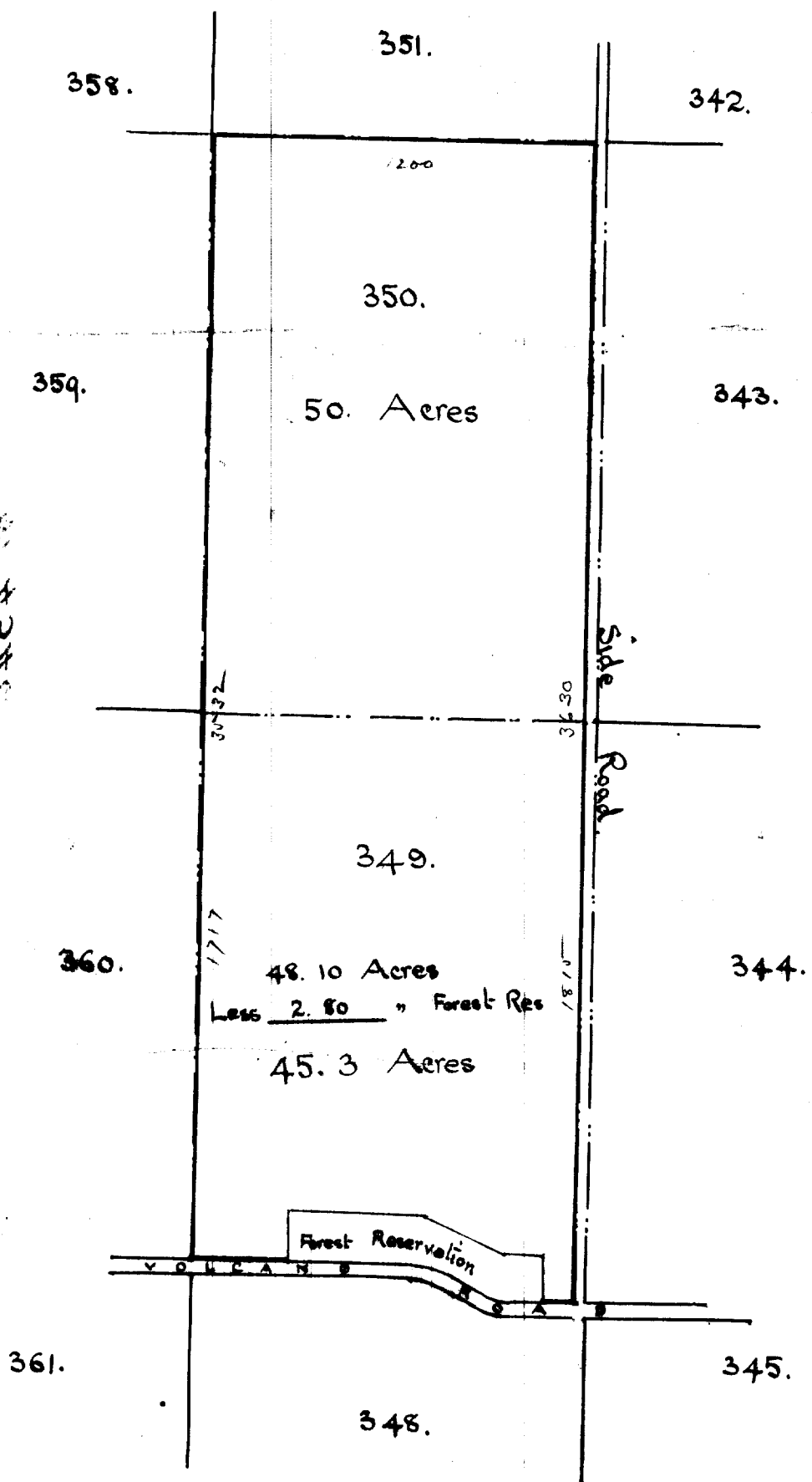

Scale
 500 feet = .1 inch