

LOT 28

Manuel Gosmas.

4.05 acres at

Manhua

Copy Furnished for Grant

April 21, 1899

Grant No. 11316

(Reg Map 1988)
CO 8-34

See Reg Map 7187
(CO 15-31)

CARTON 134

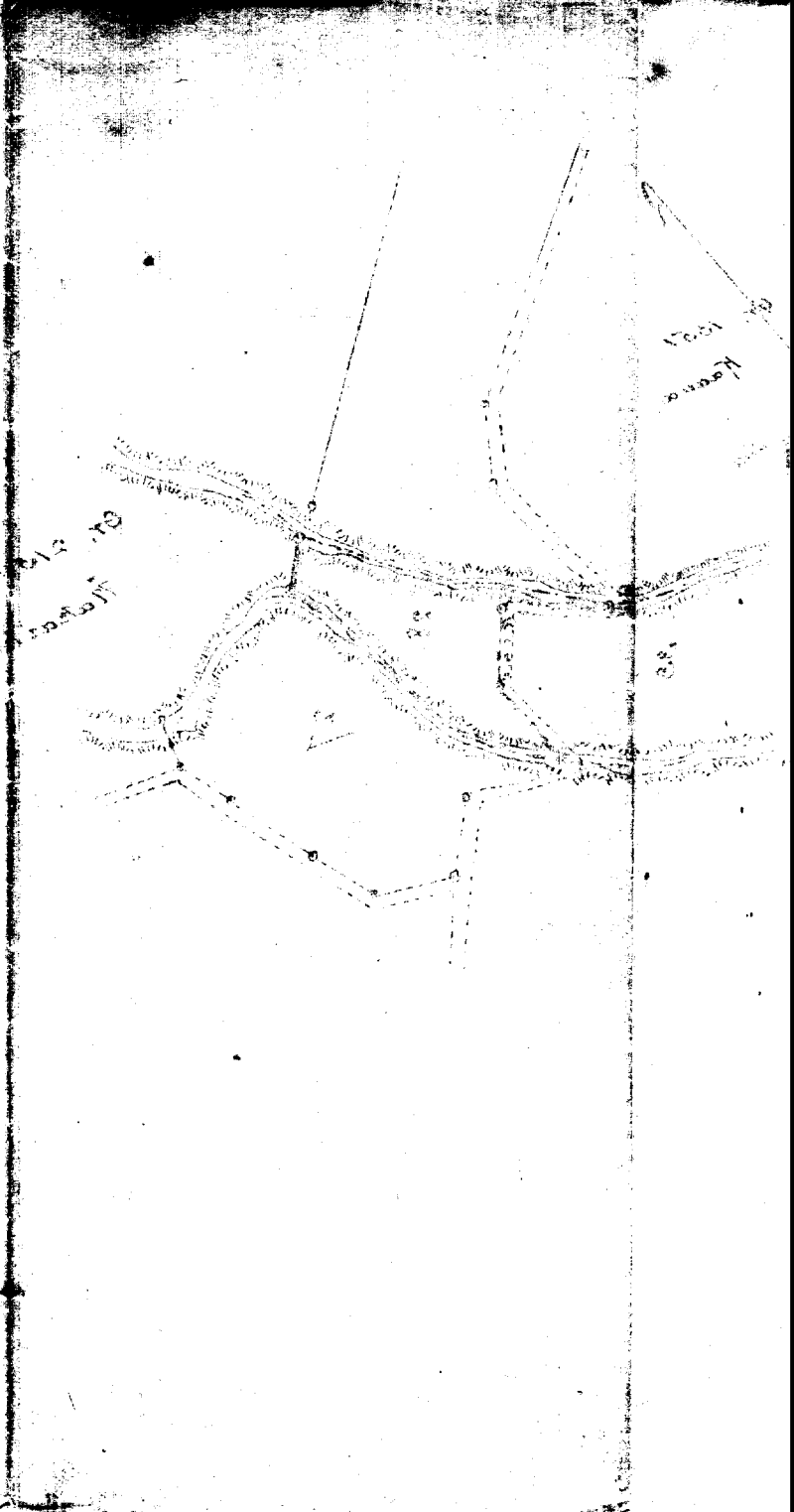

beginning at a point marked 27, crossing
 at North edge of the Government road at turn of same out
 of the Ahole patch, - and from which point the Heiau Govt
 Survey Sta. "Puu Ohai" bears $N 88^{\circ} 50' W$ "true, the distance
 being 158.8 ft. North and 1023.8 ft. East from said station, the
 boundary runs by the true meridian

- 1- $N 61^{\circ} 37' W$. - 222 ft. along North or outer edge of Govt road to a point
 marked 27 - at turn of road into the Kulanohii patch
- 2- $S 42^{\circ} 55' W$. - 271 ft. along outer edge of road to rock Δ at which
 crossing in middle of Kulanohii stream
- 3- $N 28^{\circ} 45' E$. - 305 ft. - along middle of stream
- 4- $N 61^{\circ} 00' E$. - 574 to marked rock
- 5- $S 61^{\circ} 35' E$. - 104 along South boundary Dr. 2550. Kapaehaone
 to marked rock in middle Ahole stream
- 6- $S 24^{\circ} 10' W$. - 538 along middle Ahole stream
- 7- $S 34^{\circ} 52' W$. - 245 to rock Δ at
 road crossing
- 8- $N 5^{\circ} 42' E$. - 288 along outer edge of road up bank of stream
 to point of beginning .

Containing an area of 4.05 acres.

A. B. Lockenham Surveyor

March 27-1898

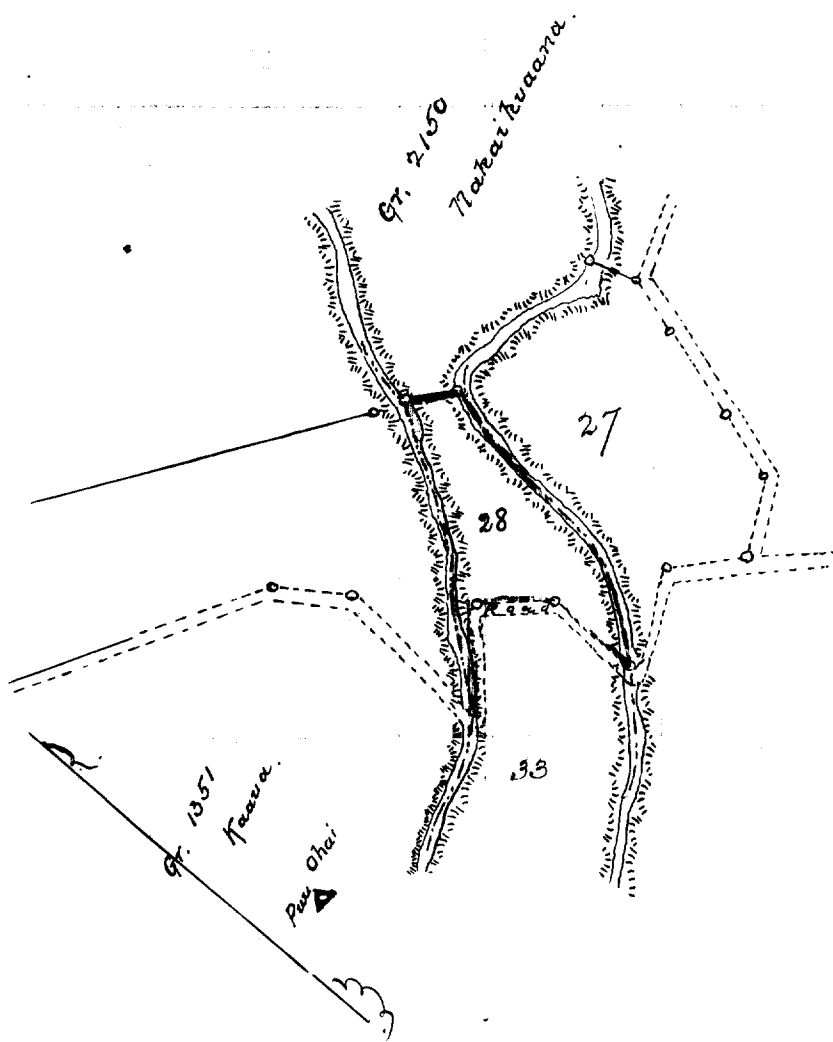

Scale 1: 6000