

Lots 120-122-123

Old New Tract

Gr. A386

C. W. Hill

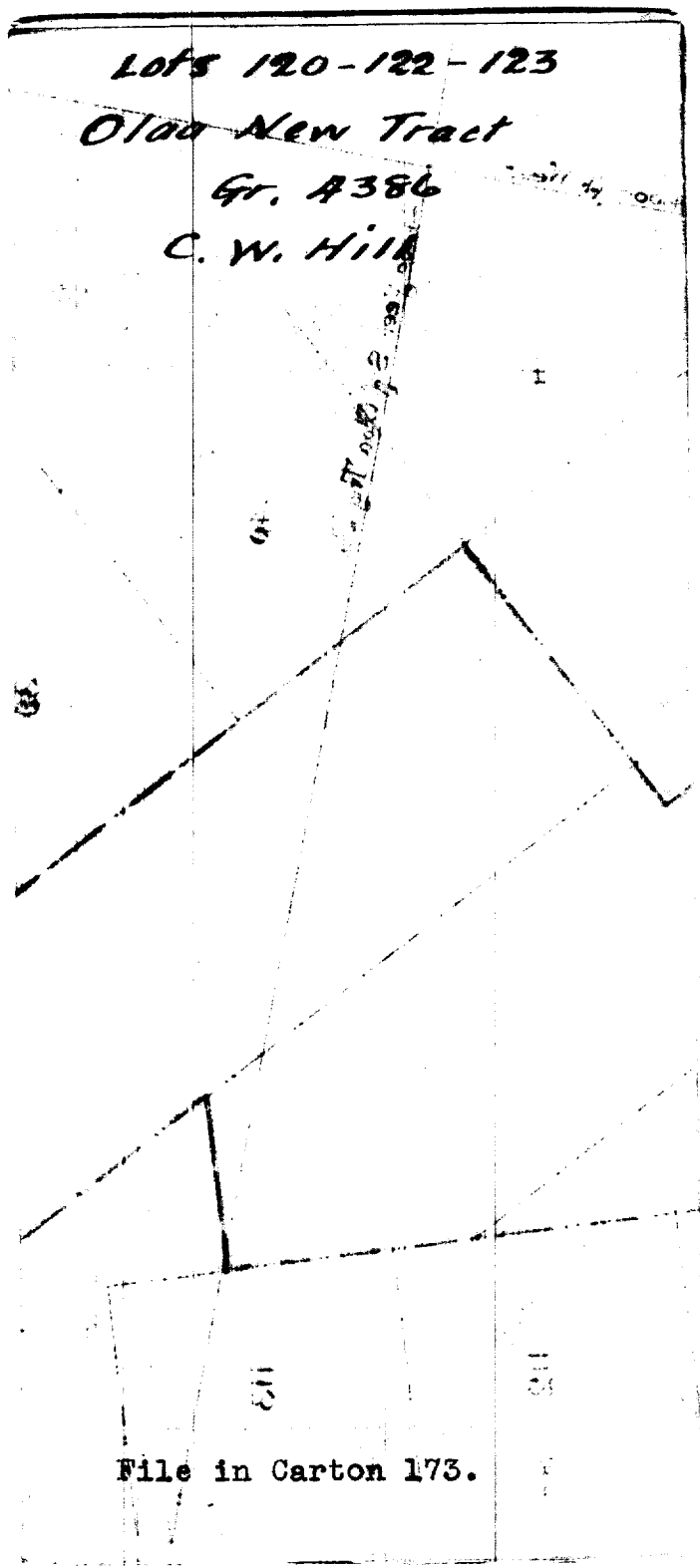

File in Carton 173.

Notes of Survey and Plan of

Olaa Bots Nos. 120-122 and 123 Section G.

Additional Land under Lease No. 91 to

C.W. Hill

Beginning at the north corner of Lot No. 120, on side road, the same point being the east corner of Lot No. 37 Sec. G. and running:-

S 61 24' E (true)	724.8 feet	along Road ;
S 48 36' W	" 1591	" " Lot No. 114;
S 72 28' E	" 472	" " " " " ;
S 18 00' W	" 1748	" " Lots 113-112&111 ;
S 48 36' W	" 2348	" " " 124 ;
N 72 28' W	" 1350	" " Road ;
N 48 36' E	" 2888	" " Lot No. 121 ;
N 61 24' W	" 861	" " " " " ;
N 48 36' E	" 3005	" " Lots 40-39-38& 37 to

the point of beginning,

Containing 150.00 Acres

Hilo Hawaii

Sept. 12th 1899

E. W. Baldwin.
Surveyor