

Duplicate

Lot 8 Kamaili Sec

Lot 9 Puna Hawaii

Appl of M. Rycroft

Aug 11, 1899

4371

Reg Map 2075

CSF 4371

M. Rycroft

See CSF 14282

file in Carton 194

For Grant to *Markie Rycroft*
 Purchase Price \$ *150⁰⁰*

For the use of the Hawaiian

(Markie Rycroft)
Queen. Hawaii
Vol. 10. Hawaiian 286
Duplicate

NOTES OF SURVEY OF LOT ⁹ (M. RYCROFT.)
Public Lands Map 2. Kamaili Puna Hawaii

Commencing at a point South 85° 15' West (true) 665 feet distant from A. Wilder's corner and run

North	14° 20'	West (true)	1295 feet	along	Government	land.
"	^{ad} 85° ⁰² 8'	"	"	2175	"	"
South	³¹⁶ 43° ⁰⁰ 30'	East	"	2090	"	"
North	84° 8'	"	"	1070	"	" to

the initial point.

Area 50 Acres.

F. Wm. Thrum.

Nov. 1895.

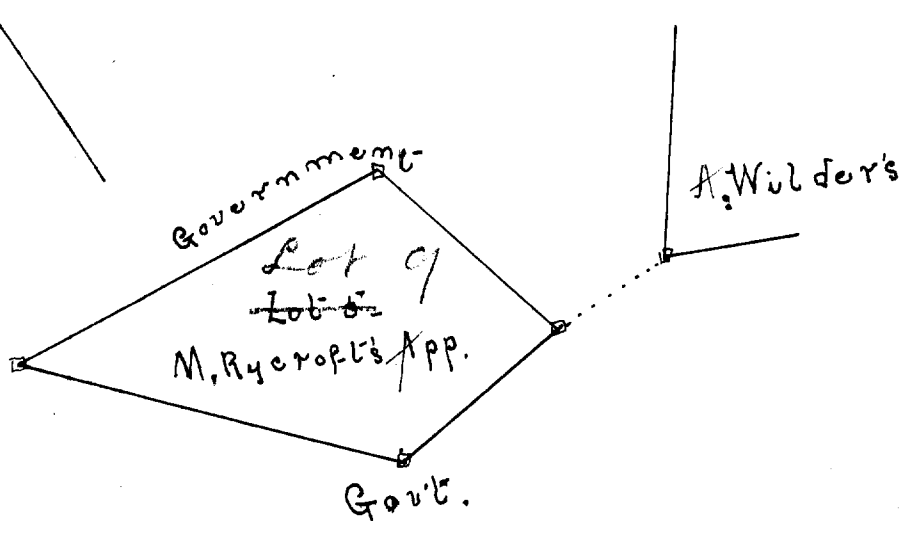

1000 ft. = 1 in.