

Description of Lot 6.

Navassa Map 16

Waipunaia Loc. Hilo, Hawaii

Copy furnished Land
Office July 24th - 1901.

Dec 23 - 1901

Grant No. 4569

TO Arlene Lopez

Date. Mar. 29, 1902

File in Carton 132.

Description of Lot 6.

Homestead Map 16.

Waipunalai Lots, Hilo, Hawaii

Beginning at West corner of this Lot, being South corner of Lot 5. 495 feet South, 390 ft East of reference concrete block at South corner of Lot 4, and running as follows:

- 1 \vee N $44^{\circ} 30'$ true 390 ft along Lot 5 to edge of Pali;
- 2 \vee S $19^{\circ} 38'$ true 553 ft. the edge of Pali being the bdy;
- 3 \vee S $55^{\circ} 00'$ true 87 ft. along edge of Pali;
- 4 \vee S $4^{\circ} 50'$ true 94 ft to middle of Moenoe gulch;
- 5 \vee S $32^{\circ} 40'$ true 236 ft along Moenoe gulch;
- 6 \vee S $5^{\circ} 00'$ true 184 ft along the same;
- 7 \vee N $81^{\circ} 10'$ true 90 ft to point on road near the edge of Moenoe gulch. Steiner
- 8 \vee N. $44^{\circ} 00'$ true 736 ft along road to initial point, and containing an area of $10 \frac{25}{100}$ acres.

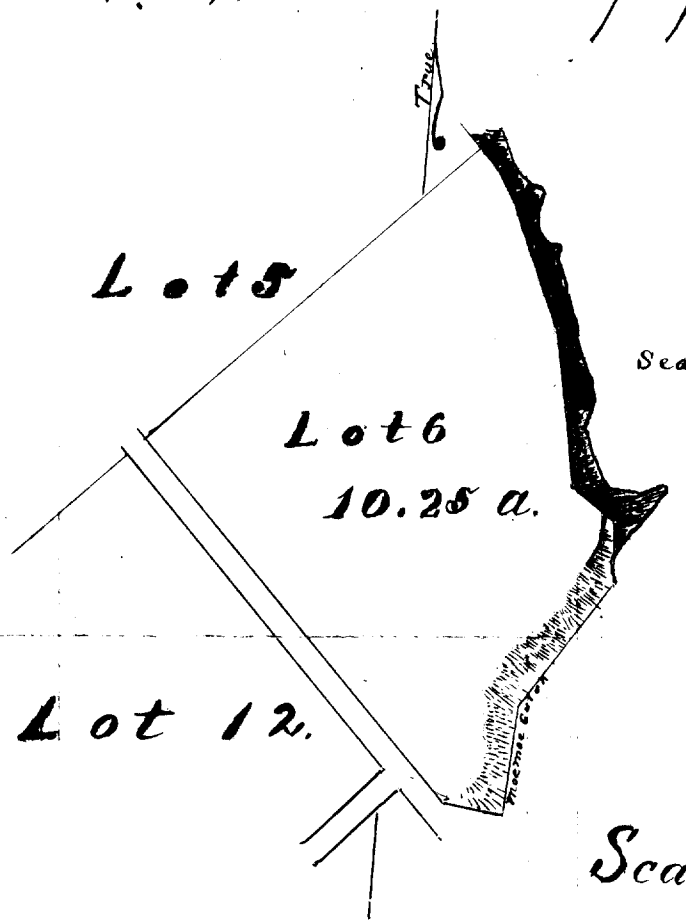

From Map by A. Schuchman
 G. K. Kamae
 Honolulu June 15 1891

S 11.5 E 3.9

Scale 300ft = 1 in.