

Lot 2. Kula.
Pouhala, Waikeli
Ewa, Oahu

Description of Lot 2. Kula,

Beginning at the N corner of Lot 1 and running as follows:-

1. N 49° 50' E. true 55 ft along Grant 150 S. P. Kalama
2. N 71° 00' E. " 121 " " " - do -
3. N 19° 00' W 10 " " " "
4. S 52° 20' E 248 " " Pahoa
5. S 3° 30' E. 238 " " Lot 3 to corner L. C. A. 858^B:2
6. S. 8° 00' E. 101 " " L. C. A. 858^B:2.
7. S. 87° 17' W. 375 " " Road to roadway 15 ft wide.
8. N 7° 40' W. 120 " " 15 ft. Roadway.
9. N 86° 40' E. 212 " " L. C. A. 857:1
10. N 3° 50' E. 81 " " " "
11. S 88° 40' E. W ¹⁴⁵ 245 " " " "
12. N 3° 20' W. 205 " " Lot 1 to the initial point and containing an area of $2\frac{78}{100}$ acres.

Honolulu Jan 3, 196.
Walwall

The rights of L. C. A. 1018 Palawalelo reserved.

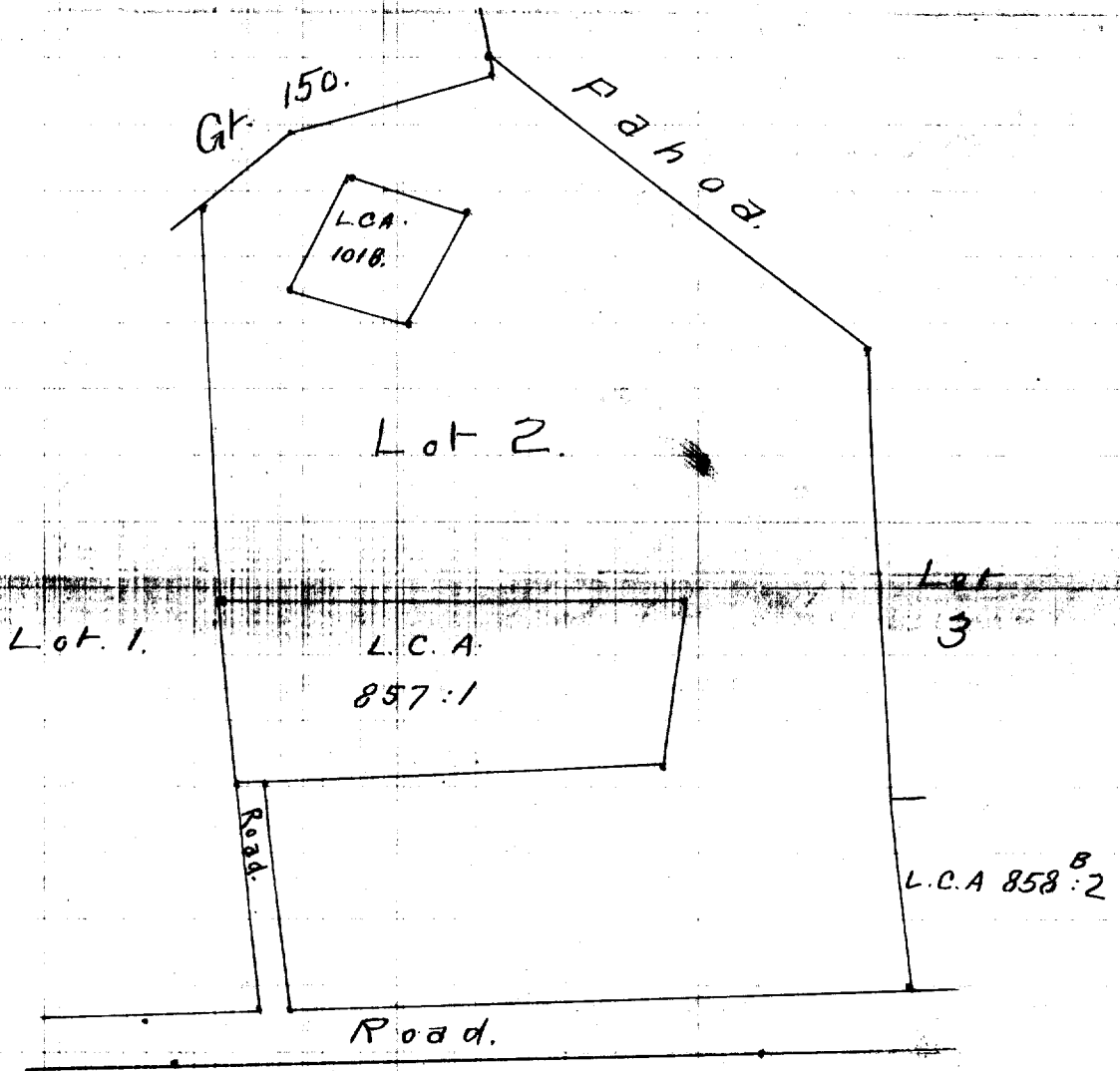

Scale 100. ft = inch