

Sec. 1
Kamaili lots
(Lockenstein's subdivision)

Grant 4461

W. Kamauu

Note - Also covered by
Gr. 7140 to J.K. Puuomoa
See Lot 20
Wrong description used in Gr 4461
Sketch plan is OK.

File in Carton 194

KAMAILE GOV'T. LOTS; PUNA, HAWAII.

LOT #1.

Notes of Survey:-

Beginning at West angle by cocoanut tree and pile of stones, from which point the Haw'n. Gov't. Survey Ref. Point "Makuakane" bears N. $20^{\circ} 37'$ W. "true" dist. 252 ft. the boundary runs by the true meridian:-

- 1.- S. $37^{\circ} 57'$ E. 761 ft along road to stone + and pile stones.
- 2.- S. $59^{\circ} 20'$ E. 358 ft. " " Δ at South angle.
- 3.- N. $47^{\circ} 30'$ E. 1511 ft. along Gov't. remainder to Δ under pile of stones from which an ohia Δ bears N. $56^{\circ} 30'$ W. "true" distant 11 ft.
- 4.- N: $5^{\circ} 05'$ W. 495 ft. along Kanaleau.
- 5.- N. $29^{\circ} 48'$ W. 984 ft. " to ohia X at North angle.
- 6.- S. $24^{\circ} 20'$ W. 959 ft. along Kanane purchase to ohia $\Delta \Delta$.
- 7.- S. $54^{\circ} 05'$ W. 627 ft. " " " to cocoanut Δ at intersection with Gr. 2164 Ap. 1. Kanuhi & al.
- 8.- S. $56^{\circ} 02'$ W. 568 ft. along Gr. 2164 Ap. 1. Kanuhi & al. to the point of beginning.

Containing an area of 47.0 acres more or less.

(Sgd.) A.B. Roebenstein

Surveyor Commission Public Lands.

Sept. 1st. 1896.

Duplicate

Lot 1. Kamaili Sec.
Puna, Hawaii.

(Appl. of H. Rycroft)

Aug. 14, 1899

4372

Reg. Map 2075.

File in Carton 194

See CSF 14285

For Grant to *H. P. Rycroft*
 Purchase Price \$ *1507*

NOTES OF SURVEY ON LOT 1. (App. H. RYCROFT.)

Public Lands Map 2. Kamali Puna Hawaii

Commencing at a point N. 65° 15' W. (true) distant 3178 feet
 from H. Rycroft's S. E. corner and run thence.

North 37° 30' East (true) 1085 feet along Government land.
 " 65° 15' West " 2007 " " " "
 South 37° 30' " " 1085 " " Lot 2.
 " 65° 15' East " 803 " " " to H. Rycroft's
 N. W. corner thence along
 H. R's land.
 South 65° 15' East (true) 1204 feet to the initial point.

Area 50 Acres.

F. Wm. Thrum,

Nov. 1895.

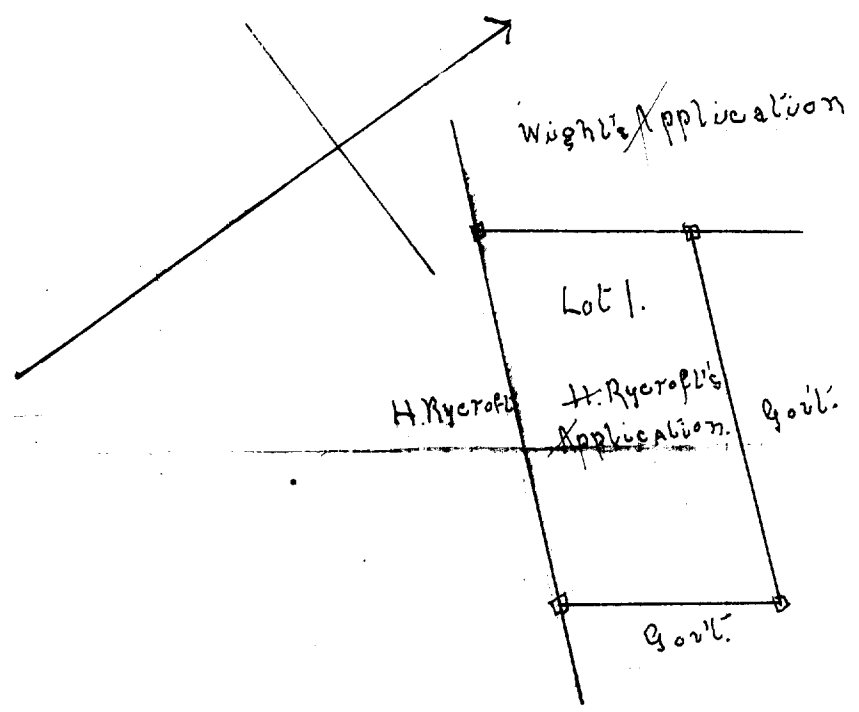

1000 ft. = 1 in.

COPY

App'l of
Aug 4

Reg. M^s

436

FOR GRANT TO H. R. RYCROFT

PURCHASE PRICE \$150.00

NOTES OF SURVEY OF LOT 1. (App. H. RYCROFT.)
Public Lands Map 2, Kamaili, Puna, Hawaii.

Commencing at a point N. 65° 15' W. (true) distant
3178 feet from H. Rycroft's S. E. corner and run thence:

North 37° 30' East (true) 1085 feet along Government land.
 North 65° 15' West " 2007 " " " "
 South 37° 30' " " 1085 " " Lot 2.
 " 65° 15' East " 803 " " " to H. Rycroft's
 N. W. corner thence along H. R's
 land.

South 65° 15' East (true) 1204 feet to the initial point.

AREA 50 ACRES.

F. Wm. Thrum,
Nov. 1895.

- Com. S&P

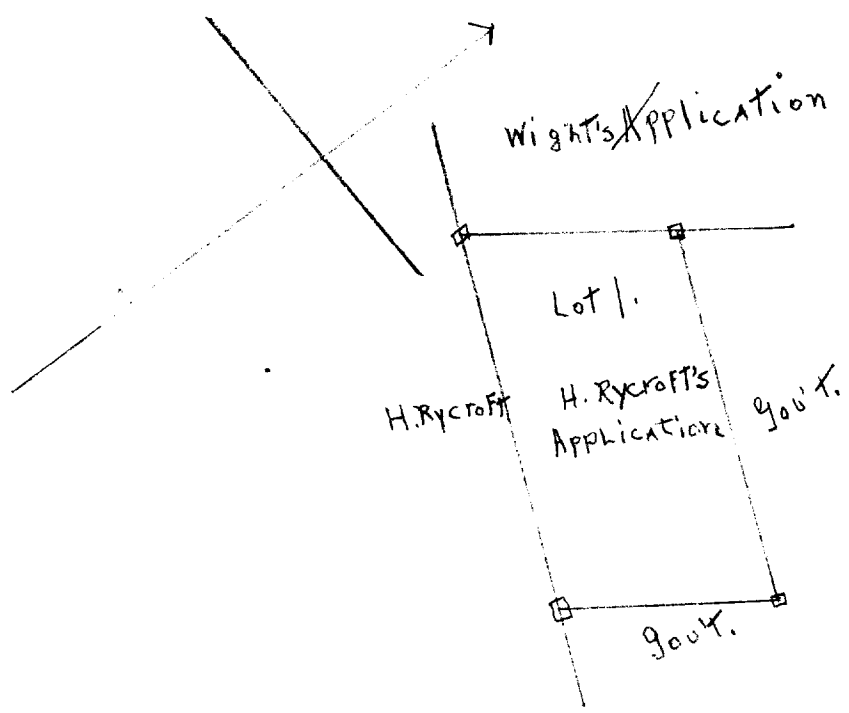

1000 ft. = 1 in.