

Lot 40
Ahualoa Homestead
Map No 18

Clement Francisco

MAR 7 1898

Co. y Furnished for Grant

March 7th 1898

Grant No. 4142

Checked

File in Carton 72

Description of Lot 40.

Ahualoa Homestead Map No 18.

Beginning at a point which is 607.5 feet S. and 6996.8 feet E from paper set-in the ground at the N.W. corner of Homestead Lots Map No 18 - and running as follows:-

1. N 85° 05' W True 485.6 feet along Lot 8 Homestead Map. 2.
2. S. 4° 55' W " 1580.0 " " Lot 39
3. S. 85° 05' E " 485.6 " " Road
4. N 4° 55' E " 1580.0 " " Lot 41 to point of beginning and containing an area of $17 \frac{61}{100}$ acres.

Wawall
Oct 14th 1891

For Grant to Clement Francisco
Purchase Price \$132.75

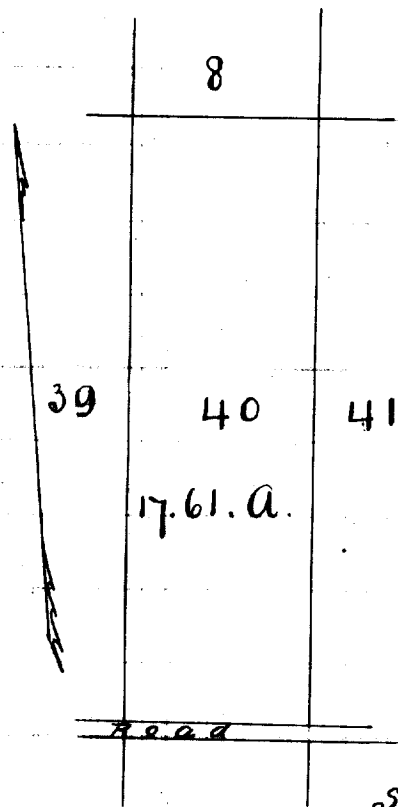

Scale - 500ft - 1. inch.