

Lot 32
Ahualoa Homestead
Map. N^o 18

Antonio de Mabrigo

Copy Furnished for Grant

MAR 7 1898

Grant No. 4141

Checked

File in Carton 72

Description of Lot 32.

Ahualoa Homestead Map No 18.

Beginning at a ~~point~~ which is 293.7 feet S. and 345.0 feet E. from an Iron pipe set in the ground at the N.W. corner of Homestead Lots, Map No 18. and running as follows;

1. N 85° 05' W True 485.6 feet along Lot 17 Homestead Map 2.
2. S. 4° 55' W " 1580.0 " " Lot 31.
3. S. 85° 05' E. " 485.6 " " Road.
4. N 4° 55' E " 1580.0 " " Lot 33 to point of beginning and containing an area of $17\frac{62}{100}$ acres.

W. Wall
Oct 14th 1891.

For Grant to Antonio de Nobring
Purchase Price \$ 132⁰⁰/₁₀₀.

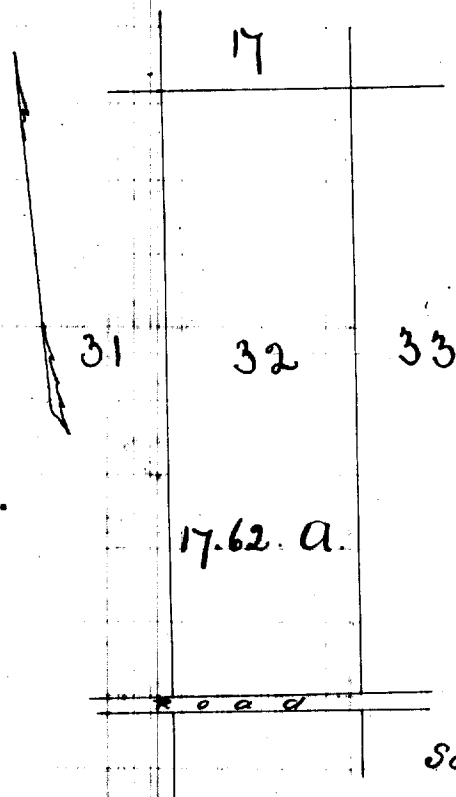

Scale 500 - 1 in.