

Ponahawai, Hilo, Hawaii

Government Lots.

Lot 25.

Grant 4666

To

Walter W. McFarlan.

File in Carton 125.

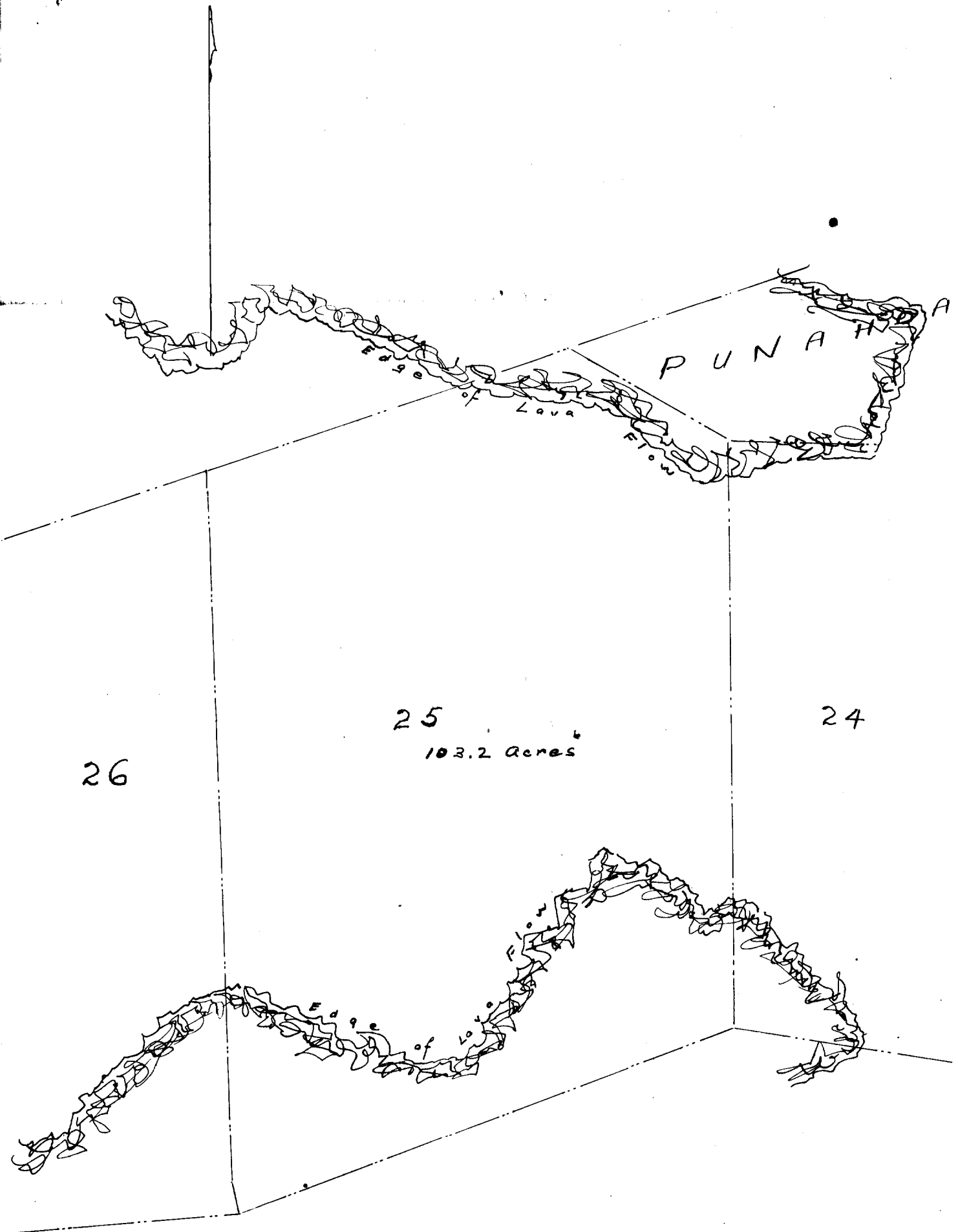

Scale 500ft = 1 in.

PONAHAWAI, HILO, HAWAII, GOV'T. LOTS.

LOT #25.

Notes of Survey:-

Beginning at the South West angle of lot #24, at large pile of stones on lava alongside of which are cut in the rock the figures XVII marking the West angle of Kaumana lot #17 the boundary runs by the true bearings:

- 1.- S.  $70^{\circ} 00'$  W. 2162 ft. to large pile of stones set over the figures <sup>25</sup>/<sub>26</sub> at South angle.
- 2.- N.  $2^{\circ} 05'$  W. 3000 ft. along lot #26 to post marked <sup>25</sup>/<sub>26</sub> at intersection with boundary of Punahoa 2nd. R.P. 1624.
- 3.- N.  $71^{\circ} 30'$  E. 1152 ft. along said boundary to North angle at pile of stones set up over the figures 25 cut in rock.
- 4.- S.  $75^{\circ} 30'$  E. 1049 ft. along lava to North East angle, marked by pile of stones over the figures <sup>25</sup>/<sub>24</sub> cut in the rock.
- 5.- S.  $0^{\circ} 00'$  W. 2374 ft. along lot #24 to the point of beginning.

Containing (103.2) acres exclusive of open lava:

*126.8 Patent & original*

(Sgd.) A.B. Loebenstein. Surveyor Bureau Public Lands.

Hilo, Jan. 27th. 1896.