

Lat. 22.

Ahualoa Homestead

Map No. 18

Grant No. 4706

TO Mojii Tagawa

Date. May 21, 1903

Copy

checked -

File in Carton 72

DESCRIPTION OF LOT #22.

Ahualoa Homestead Map No. 18.

---o0o---

Beginning at a point which is 1636.3 ft. S. and 106.0 ft. E. from an iron pipe set in the ground at the N.W. corner of Homestead Lots Map No. 18 and running as follows:-

1.- S. $4^{\circ} 55'$ W. true 1580.0 ft. along Lot #23.

2.- S. $85^{\circ} 05'$ E. " 550 ft. feet along Gov't.

3.- N. $4^{\circ} 55'$ E. " 1580.0 ft. along Lot #21.

4.- N. $85^{\circ} 05'$ W. " 550.0 ft. along Road to point of beginning
and containing an area of 19 95/100

acres.

W.A.Wall.

Oct. 15th. 1891.

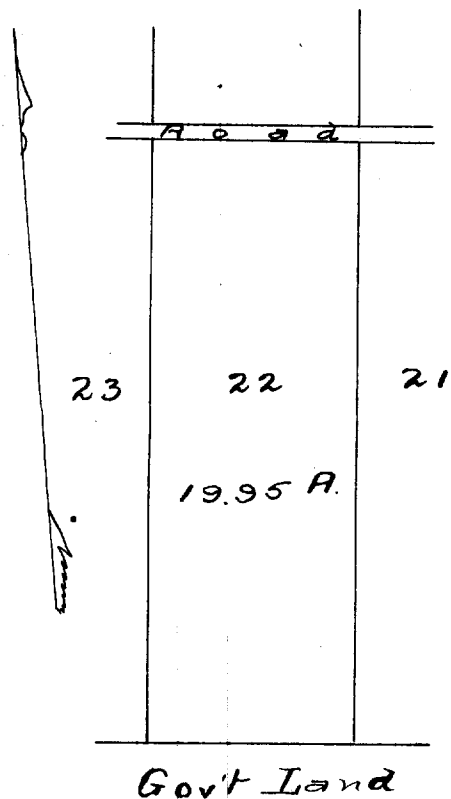

Scale 500ft = 1 in.