

Lot 22.

Homestead Map No 8.

Waiakoa.

Grant No. 3866

TO Francisco da Cambra

Date.

File in Carton 5.

Lot 22.

Homestead Map. No 8. Waiakoa Kula, Maui.

Beginning at the N.E. corner, at a stone marked Δ , on the makai edge of road; and running:—

1. S. $41^{\circ} 45' W$ (true) 719 feet along road to a stone marked Δ ; on edge of gulch;
2. Thence along edge of gulch to a stone marked \rightarrow on line of L.C.A. 2383 Ap.1 Kaauwai; direct bearing and distance being N. $53^{\circ} 35' W$ (true) 918 feet.
3. N. $34^{\circ} 32' E$ (true) 346 feet along L.C.A. 2383 Ap.1 Kawaalau, to a stone marked +;
4. N. $74^{\circ} 15' W$ (true) 231 feet along L.C.A. 2383. Ap.1 Kawaalau to a stone marked +;
5. N. $61^{\circ} 00' W$ (true) 264 feet along L.C.A. 2383. Ap.1, to a stone marked Δ ;
6. N. $63^{\circ} 42' W$ (true) 168 feet along L.C.A. 2383. Ap.1;
7. N. $47^{\circ} 9' E$ (true) 80 " across old road, and along Gr. 1207 Ap.2 Napela to a stone marked +;
8. N. $22^{\circ} 00' E$ (true) 137.5 feet along Gr. 1207 Ap.2, to a stone with hole in it, marked Δ ;
9. S. $57^{\circ} 28' E$ (true) 381 feet along L.C.A. 7971^F Ap.2 Nauliuli, to a stone marked +;
10. S. $76^{\circ} 9' E$ (true) 501.5 feet along L.C.A. 7971^F Ap.2. to a stone marked Δ ;
11. S. $59^{\circ} 42' E$ (true) 818 feet along Lot 21, to the point of beginning and containing an area of $16 \frac{85}{100}$ Acres.

May 1889.

Surveyed by E.D. Baldwin
Asst Gov't Survey.

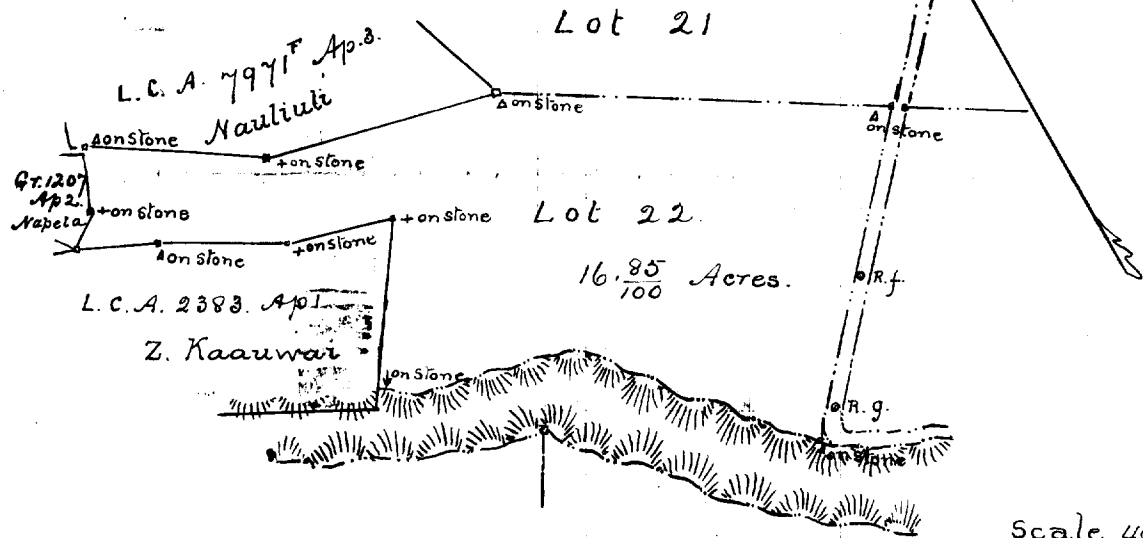

Scale 400ft = 1inch.