

Lot 20,
Ualapue Lots, (parts 1 & 2),
Kona, Molokai.

*Simon
Grant*

*Grant 3799
Simon Kahalehale*

File in Carton 53.

Lot - 104

Description of Allotment No 20. Malapue. Makai ..

Beginning at angle of stone wall makai side of main road, this point being South 1093 ft and West 1186 ft from coral rock B of Malapue Survey, thence the boundary runs by true bearings:

S 34° 40' E	127	ft	along stone wall + lot 21
S 15° 00' E	42 L.C.A. 6516 Ap 3. (Wailiki)
S 27° 30' E	38 " " " "
N 61° 30' E	26 " " " "
S 39° 40' E	46 " " " "
S 59° 15' W	47 L.C.A. 6516 Ap 2 (Wailiki)
N 26° 40' W	46 " " " "
S 62° 15' W	51 " " " "
N 33° 20' W	39 L.C.A. 3840 Ap 2 (Paluki)
N 23° 30' W	62 " " " "
S 69° 30' W	72 " " " "
S 20° 50' E	125 " " " "
S 56° 45' W	22 " " 3975 Ap 2 (Hulihae)
S 65° 00' W	122 L.C.A. 10505 Ap 2. (Kaulowaa)
N 19° 15' W	29 " " " "
S 73° 20' W	72 " " " "
N 25° 40' W	116 middle of stone wall joining Konohiki
N 53° 9' E	354 along makai side of main road to initial point

Area $1 \frac{15}{100}$ Acres

J. J. Brown. April 10th 1895

(Plan inside)

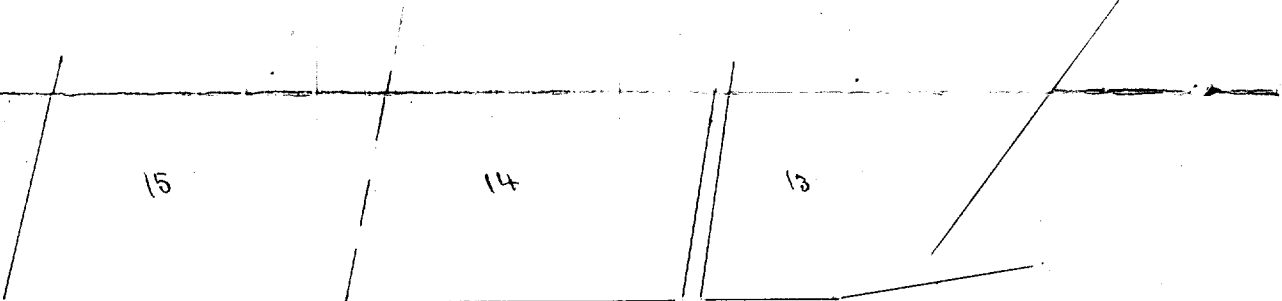

Main Road

Konohiki
(Peahi)

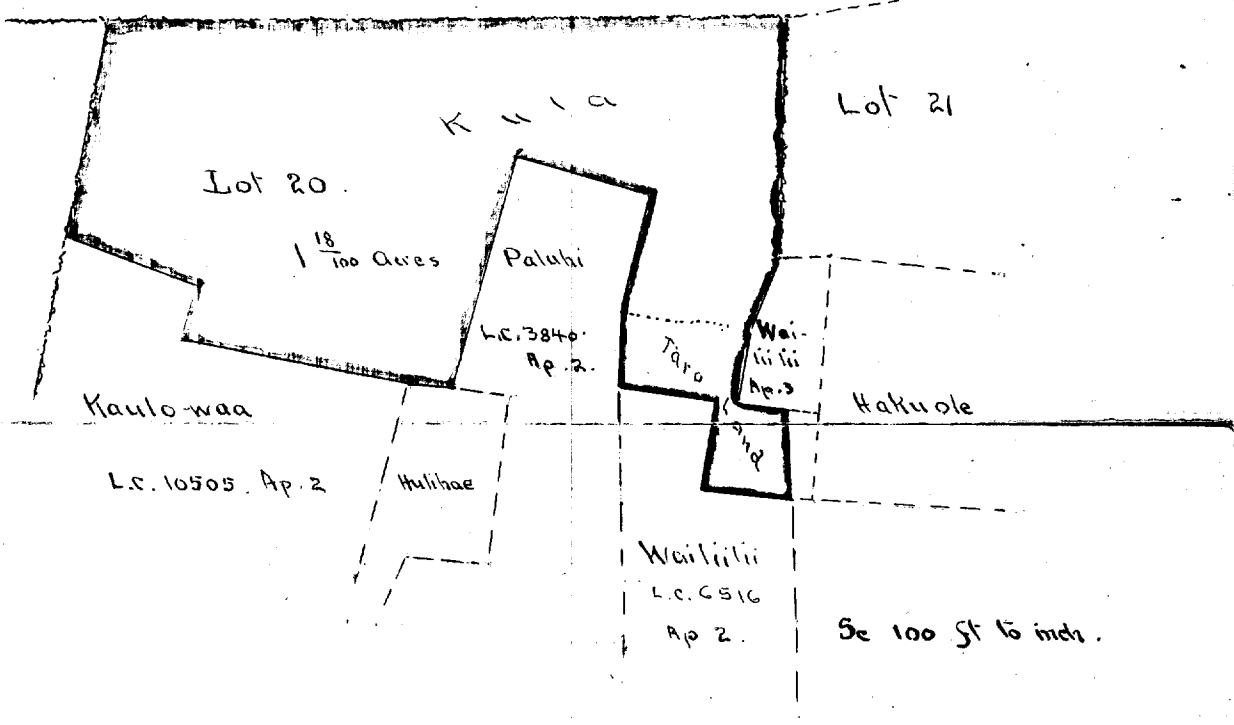

See 100 St to inch.