

Lot 18  
Honokaa  
Hamakua Hawaii

Grant H457  
H. A. Swift

File in Carton 73

# Description of Lot 18 Honokaa Hamakua Hawaii

Beginning at a point which bears  $N 85^{\circ} 05' W$ . true 70 ft from the S.E. corner of Honokaa Homesteads and running as follows by true bearings.

- |     |    |                  |    |      |    |       |     |                      |
|-----|----|------------------|----|------|----|-------|-----|----------------------|
| 1.  | N  | $85^{\circ} 05'$ | W  | 937  | ft | along | old | Homesteads.          |
| 2.  | S. | $15^{\circ} 16'$ | W  | 720  | "  |       |     | reserve to road.     |
| 3.  | S  | $82^{\circ} 27'$ | E. | 250. |    |       |     | 50 ft road.          |
| 4.  | N  | $62^{\circ} 36'$ | E. | 233  | "  |       |     | -do-                 |
| 5.  | S  | $6^{\circ} 09'$  | W. | 117  | "  |       |     | -do-                 |
| 6.  | S. | $24^{\circ} 17'$ | W. | 115  | "  |       |     | -do-                 |
| 7.  | S. | $33^{\circ} 15'$ | W. | 200  | "  |       |     | -do-                 |
| 8.  | E  | ast.             |    | 160  | "  |       |     | -do-                 |
| 9.  | S  | $45^{\circ} 46'$ | E. | 144  | "  |       |     | -do-                 |
| 10. | N  | $83^{\circ} 05'$ | E. | 187  | "  |       |     | -do-                 |
| 11. | N  | $27^{\circ} 30'$ | E. | 110  | "  |       |     | -do-                 |
| 12. | N  | $70^{\circ} 56'$ | E. | 130  | "  |       |     | -do-                 |
| 13. | N  | $15^{\circ} 16'$ | E. | 880  | "  |       |     | Go to reserve to the |

initial point, and containing  
an area of  $18 \frac{24}{100}$  acres.

200  
7/14

Homesteads.

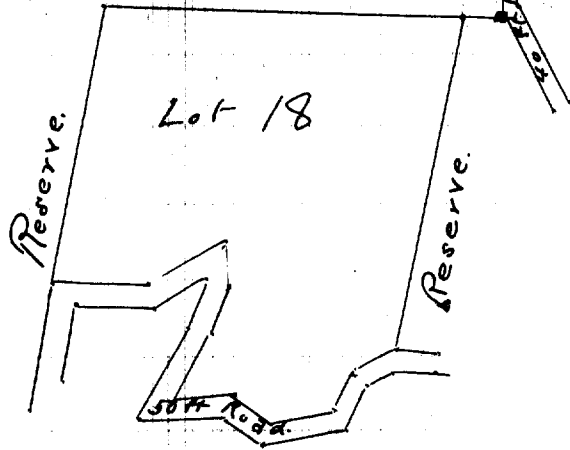

Lot 11.

True.

500 ft = 1 inch