

Lat 18
Ahualoa Homestead
Map No. 18

~~Antone Suwa~~

MAR 7 1898

Copy Furnished for Grant

~~Antone Suwa~~ 7th 1988

Grant No. 4150

Checked

File in Carton 72

For Grant to *Agutaro Suwa*
Purchase Price \$ 104.70

DESCRIPTION OF LOT #18.

Ahualoa Homestead Map No. 18.

---0:0---

Beginning at a point which is 1794.1 ft. S. and 1942.2 ft. E. from an iron pipe set in the ground at the N.W. corner of Homestead Lots Map No. 18, and running as follows:-

- 1.- S. 4° 55' W. true 1580.0 f. along Lot #19.
- 2.- S. 85° 05' E. " 387.5 ft. " Gov't.
- 3.- N. 4° 55' E. " 1580.0 ft.. " Lot #17.
- 4.- N. 85° 05' W. " 387.5 ft. " Road to point of beginning
and containing an area of 13 96/100
acres.

W.A.Wall.
Oct. 15th. 1891.

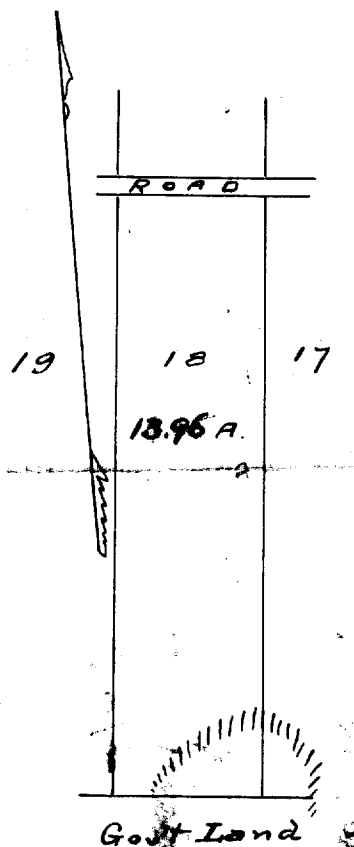

Scale 500ft = 1 in