

Lot 18
Pouahawaii Govt. Lots,
Keolu, Hawaii,
Grant 4778
To
Maria Tarao

File in Carton 125.

PONAHAWAI, HILO, HAWAII, GOV'T. LOTS.

LOT #18.

Notes of Survey:-

Beginning at North angle in Waipahoehoe stream, at a point where the figures $\frac{18}{17} / \frac{15}{16}$ have been cut in rock, the boundary runs by true bearings:

- 1.- S. $75^{\circ} 34'$ W. 968 ft. along middle stream to point marked $\frac{12}{18} / 14$ at North angle lot #19.
- 2.- S. $0^{\circ} 10'$ E. 1505 ft. along lot #19 to South angle at post marked $\frac{12}{20} / \frac{18}{17}$.
- 3.- N. $81^{\circ} 35'$ E. 931 ft. along lot #17 to South East angle in Kapoowai stream, at point marked $\frac{16}{17} / \frac{15}{16}$.
- 4.- N. $0^{\circ} 30'$ E. 1611 ft. along lot #15 to point of beginning.

Containing 32.7 acres.

(Sgd.) A.B.Loebenstein. Surveyor Bureau Public Lands.

Reserving strip 30 ft. wide along West boundary for purpose of road. The area 32.7 acres is exclusive of road reserve.

(Sgd.) J.F.B.

May 2nd. 1896

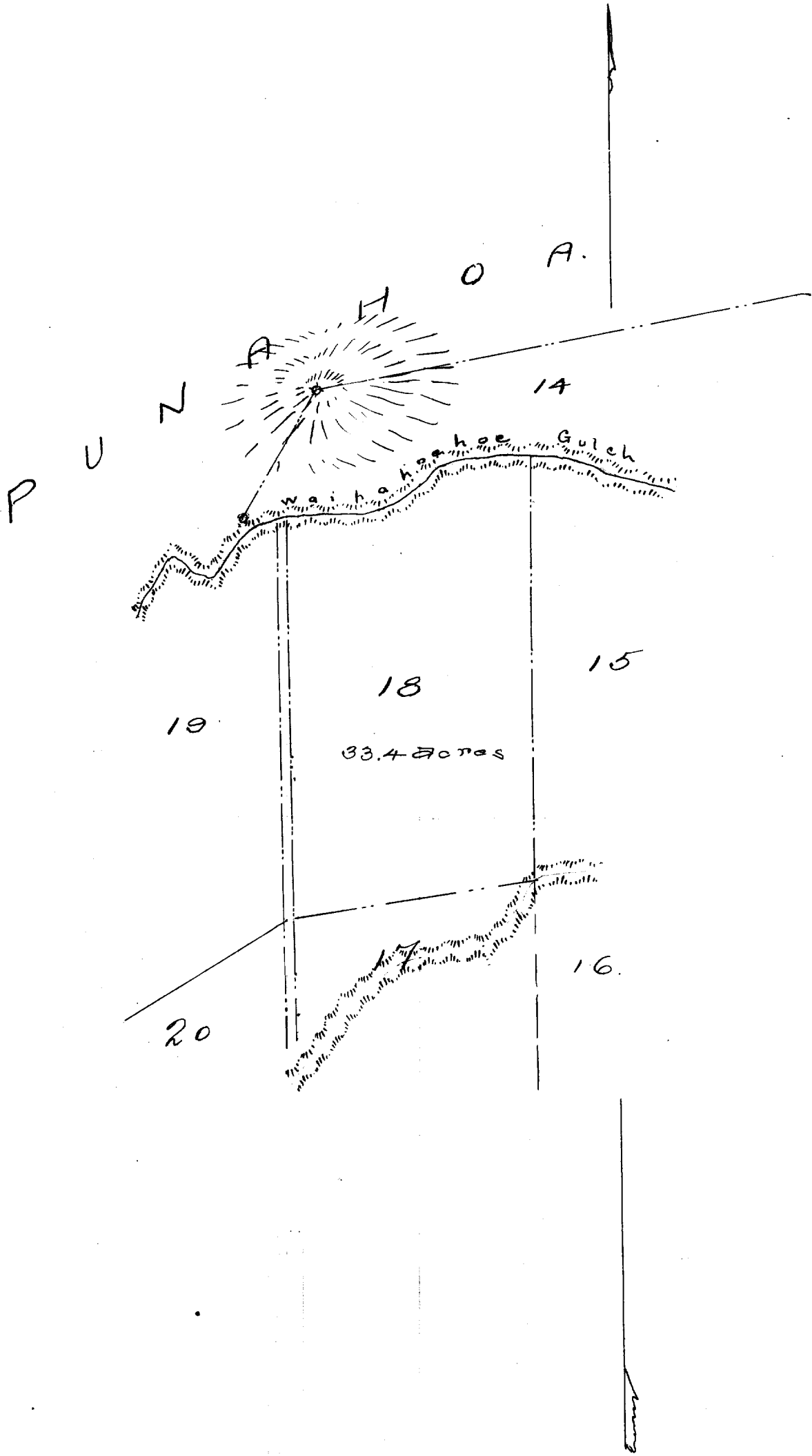

Scale 500ft = 1 inch

LOT 18

Pohakouai, Hilo, Hawaii, Site Lot

Lot # 18

Notes of Survey.

Copy furnished Land Office
Sept. 16/03

Grant 4778

To

Maria Parao

File in Carton 125.

Ponahawai, Hills, Hawaii Govt Lots
Lot # 18

Notes of Survey :-

Beginning at North angle in Waipahoeke stream at a point where the figures $\frac{18}{17} | \frac{15}{16}$ have been cut in rock, the boundary runs by true bearings

1 - S 75° 34' W - 963 ft. along middle stream to point marked $\frac{19}{18} | \frac{14}{18}$ at North angle lot # 19

2 - S 0° 10' E - 1505 " along lot # 19 to South angle at point marked $\frac{19}{20} | \frac{18}{17}$

3 - N 81° 35' E - 931 " " # 17 to South East angle in Kapeowai stream at point marked $\frac{18}{17} | \frac{15}{16}$

4 - N 0° 30' E - 1611 " along lot # 15 to point of beginning.

Containing 32.7 aces.

A.B. Lockenstien, Surveyor Bureau Public Lands

Hilo January 27 - 1896

Reserving strip 30 ft wide along west boundary for purpose of road. The area 32.7 a is exclusive of road reserve.

J. S. B.
May 2nd 96

N 1.0

E 2.0