

Map 4 Lot 18

Lot 18

Homestead Map No 4

Kaunaloa Hamakua Hawaii

Grant No. 3848

TOB. Abren

Date. Jan. 6, 1896

Copy furnished

Oct 29 95

also Reg Map 1531

Sec. 4.

Description of Lot 18.
Homestead Map No. 4
Kaunaloa Hamakua Hawaii

Beginning at a marked rock + on the makai side of the Government road 1294 feet S. and 4527 feet E. of Kukuilamalahoe Δ Station and running as follows;

1. S $23^{\circ} 10'$ W true 1385 feet along Lot 17 to a rock marked + on N. line of Grant 2450 to "Kaiwi";
2. ^{N.} ~~#~~ $73^{\circ} 36'$ W true 451 feet to rock marked on West side of Kaunamano Gulch;
3. N. $15^{\circ} 30'$ W true ~~415~~ feet the middle of the Gulch being the boundary;
4. N $72^{\circ} 10'$ E. true 390 feet the middle of the Gulch being the boundary;
5. N $34^{\circ} 25'$ E. true 843 feet the middle of the Gulch being the boundary; to a rock marked + being the S.E. corner of Homestead Lot 8. on Kaunamano
6. S $71^{\circ} 41'$ E. true 245.7 feet to initial point. The Government reserving 30ft road right.

This Lot contains an area
 $12 \frac{25}{100}$ Acres

June. 1890. Chas. Nott Jr

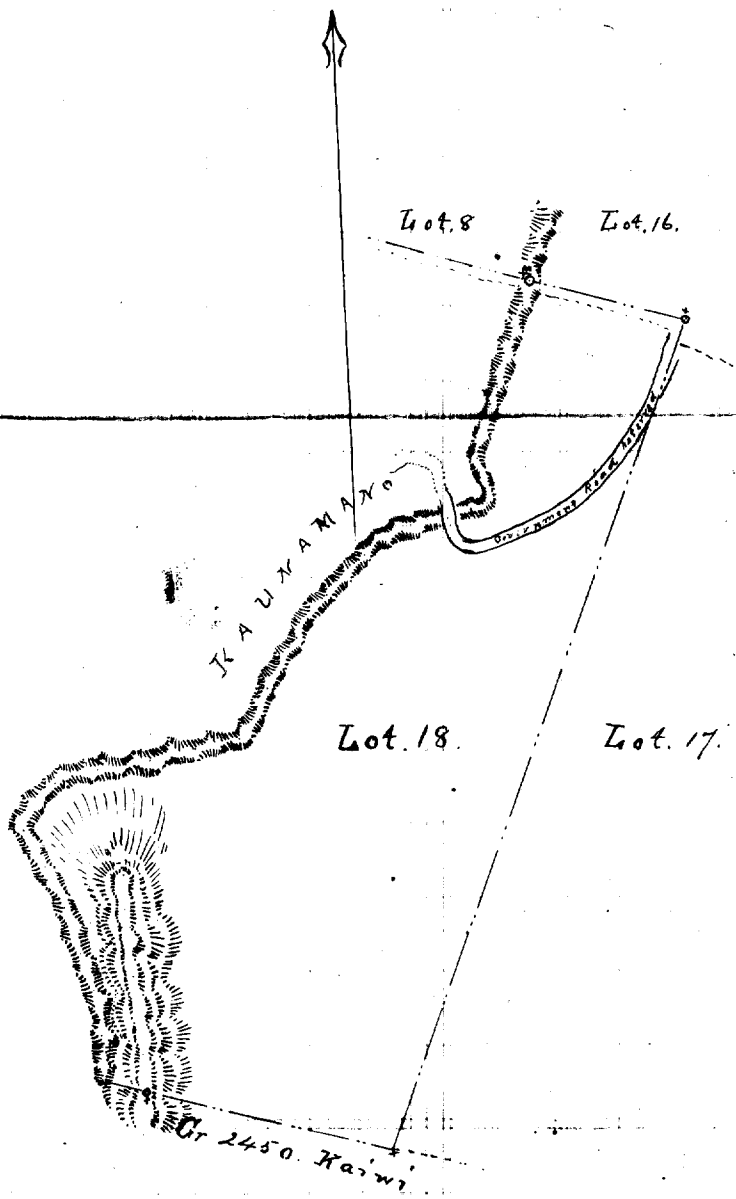

Scale 300ft. 1. inch