

Lot 14

Homestead Map No 5

Pauilo Hamakua

Copy Furnished for Grant

Aug 11 1916 .97

~~Nov 20 96~~

Grant No. 4064

M. A. de Luis

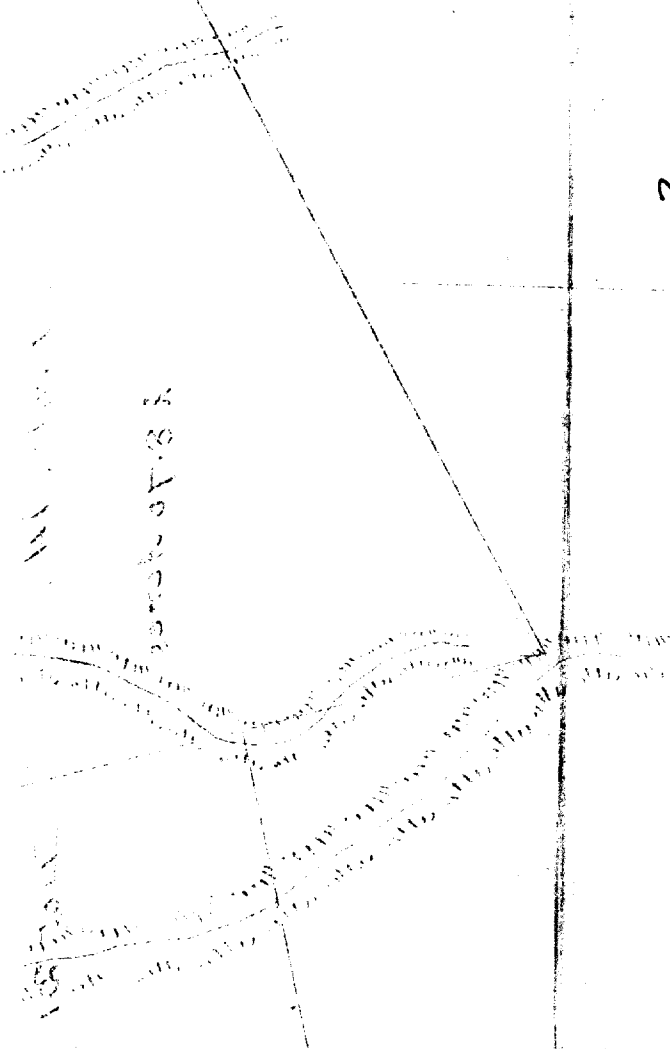

20.70 acres

20.70 acres

File in Carton 81

Homestead Map No. 5.  
Paauilo, Hamakua, Hawaii.  
Lot 14.

Beginning at the north angle, at 30 ft. road, joining Lot 13  
this point being S 3777 ft. W 8472 ft. approx. from Koholalele Sta.  
thence running by true bearings:

1. S 82 40 E 1357 ft. along Lot 13
2. S 15 33 W 1139 ft. along Lot 21
3. N 60 48 W 1698 ft. to 30 ft. road
4. N 65 55 E 160 ft. along 30 ft. road
5. N 48 50 E 71 ft. " " "
6. N 53 30 E 89 ft. " " "
7. N 37 25 E 161 ft. " " "
8. N 26 57 E 162 ft. " " " to point of beginning.

Area 28.70 Acres.

Notes of Survey by O. L. Johnson  
from Map by J. F. Brown.

June 3rd 1896.

