

Lot 11,
Ualapue Lots, (parts 1 & 2),
Kona, Molokai.

Grant 3794.
Lono.

File in Carton 53.

Description of Allotment No 11. Malapue. Motokai

Part 1. Kula.

Beginning at point on mauka side of road S 734.2 ft and West 909.6 from coral rock B of Malapue Survey, thence the boundary runs by true bearings;

N 21° 34' W 306 ft along 10 ft lane.
 S 74° 30' W 60 " " " "
 N 32° 30' W 86 " " " "
 N 54° 30' W 58 " " " "
 S 67° 45' W 76 " " " "
 S 24° 35' E 517 " " lot 12. part 1
 N 43° 48' E 170 " " main road to initial point.

Area $1 \frac{63}{100}$ Acres.

Part 2 (lāro land) Beginning at point on Kuauna of loko, S. 748 and E 537 ft from coral rock B, thence the boundary runs by true bearings:

N 60° 50' E 102 ft along Kouohiki land
 N 27° 15' W 111 " " Keamui L.C.A 4196. Ap 3
 N 41° 00' W 52 " " Kamele L.C.A 3792. Ap 2
 S 86° 00' W 13. " " Muolo L.C.A. 3678. Ap. 2
 N 36° 45' W 51 " " " " " "
 N 45° 30' W 32 " " Kahaka L.C.A 4192
 S 25° 15' W 111 " " Hō (L.C.A 3982. Ap. 1)
 S 42° 15' E 99 " " Kuauna of loko
 S 31° 00' E 88 " " " " " " to initial pt.

J. B. Brown. April 8th 1895

Area $\frac{55}{100}$ Acres

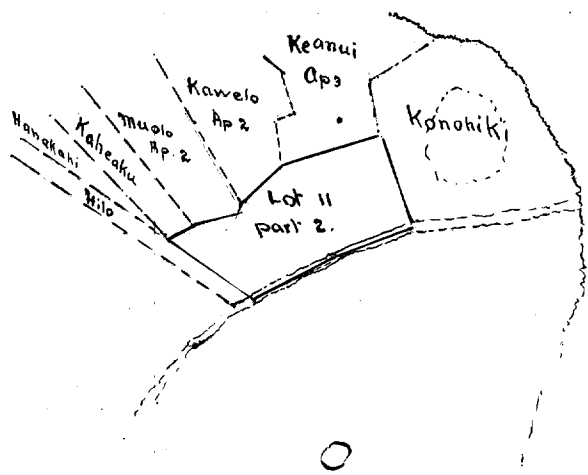

○ Coral rock
B.

O
H
O

L

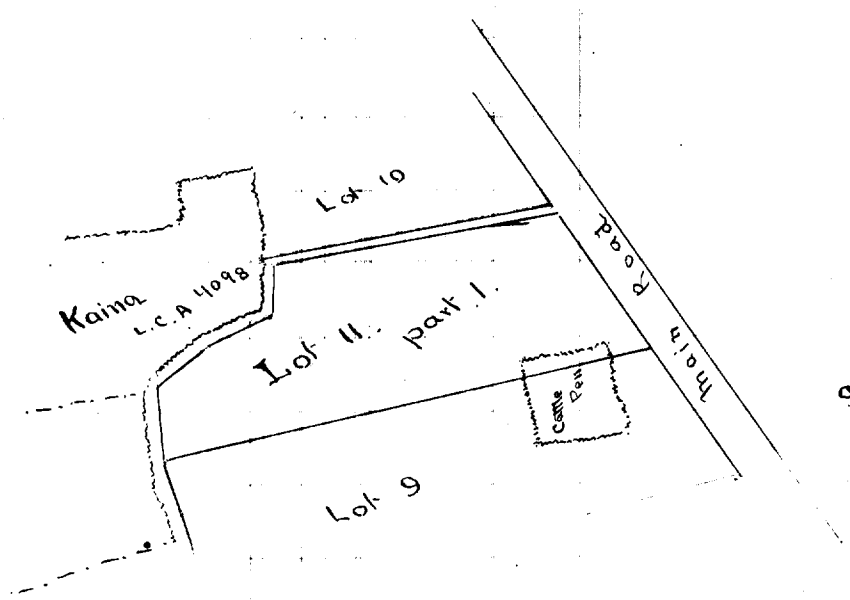

Sc. 200 ft to inch.