

Lot. 11.  
Ninole & Waitau, Kau.  
Homestead Map. No 17

Grant No. 6363

TO Malakina

Date, Apr. 15 - 1915

Copy furnished Land Office  
March 29 1915

✓  
file in Cartanl.

# Description of Lot, 11.

Kinole and Waikau, Kau, Homestead Map, 17

Beginning at a point on road marked + on stone which is 8759 feet North and 4502 feet West from Govt. Survey Station "Puehu" <sup>Fig. 17</sup> and running <sup>as shown on Homestead Map No. 17, 22.</sup> as follows:

1. S. 57° 10' W. true 1185 feet along Lot 10.
2. N 45° 00' W. " 851 " " Hilea iki
- \* 3. N 65° 55' E " ~~1260~~ <sup>1255</sup> " " Lot 12,
4. S. 44° 00' E . 650 " . Road to initial point and containing an area of  $20\frac{12}{100}$  Acres.

Aug. 16<sup>th</sup> 1892,  
 O. A. Wall,

\* changed by Newton March 1907

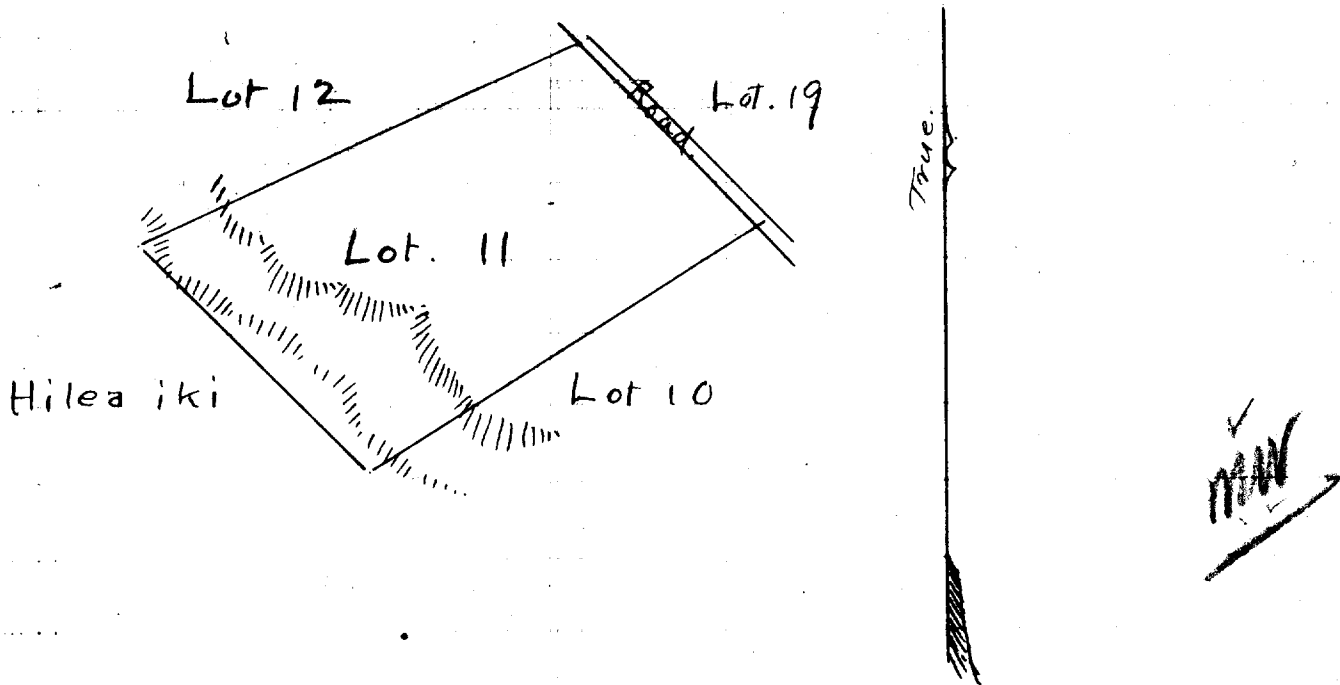

Scale. 500 ft = 1 inch.

N	S	E	W	area
413.8	1110.1	1597.3	1597.4	

Newton - March 1907

File in the Office of the Government Survey.