

Lot 9.

Homestead Map #24

Koolukua.

Kahoolina Duda.

Copy furnished for Grant

Jan 5<sup>th</sup> 1899

Grant No. 4272

File in Carton 51.

Description of Lot 9, Homestead Map No. 24  
Hoolehua, Ap. 1. Kona, Molokai.

Beginning at a point on the makai side of a 25 foot road, said point being 152 feet South and 133 feet West of the point known as Keawe, and running:-

1. S.  $21^{\circ} 54'$  E. True 2628 feet along Lot 10 to sea-shore
2. N.  $76^{\circ} 05'$  W. " 235 feet along sea shore.
3. N.  $21^{\circ} 54'$  W. " 2428 feet along Lot 8 to road
4. N.  $49^{\circ} 35'$  E. " 200 feet along road to Initial point.

Area . 11.02 Acres.

Walter E. Hall. Surveyor.  
February 1892.

For Grant to  
Purchase Price \$

Kahoolina District  
\$ 75<sup>00</sup>

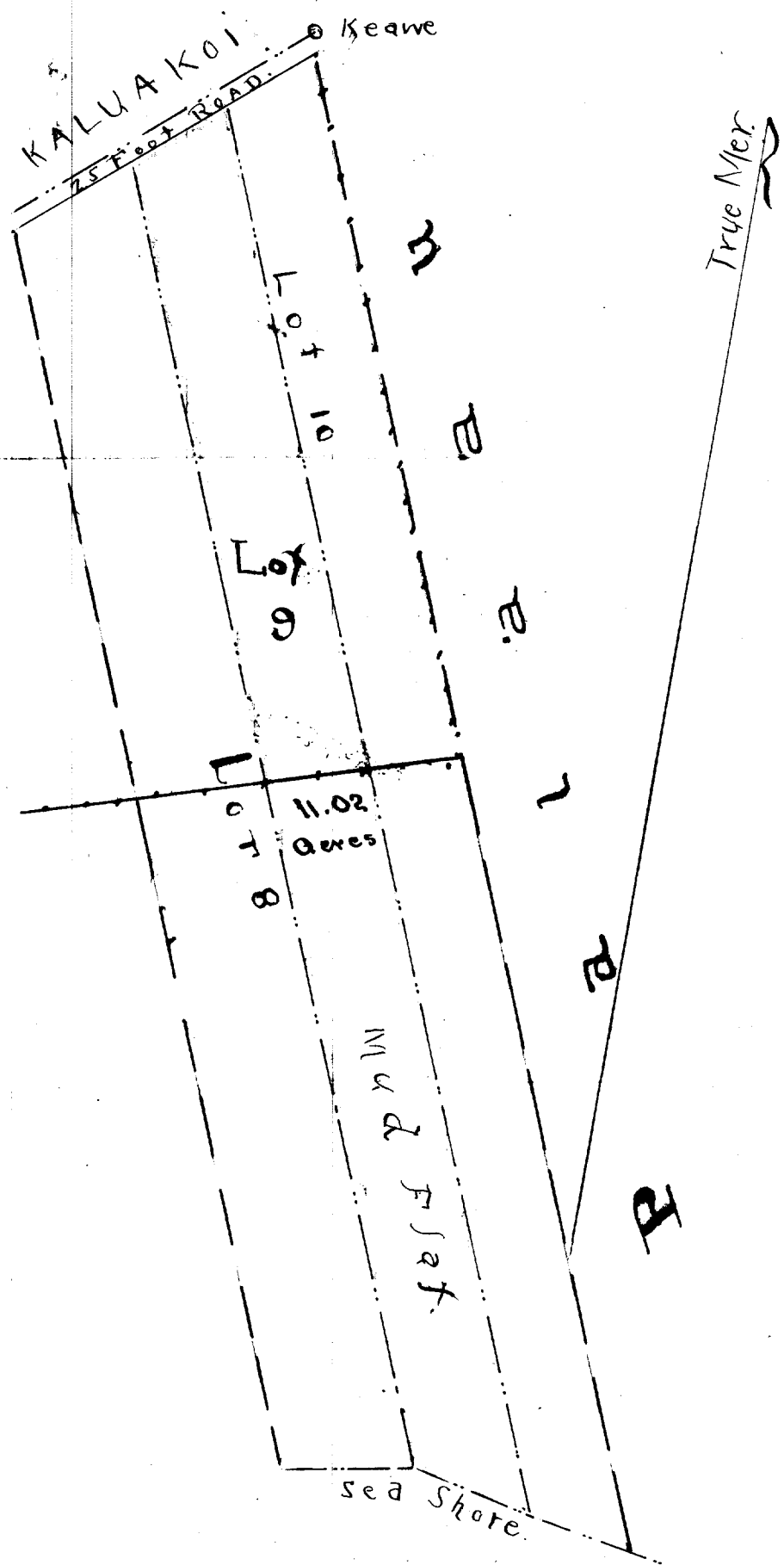

Scale 300 Feet to an Inch.