

Lot 9.
Ninole & Wailan. Kau.
Homestead. Map. No. 17

Grant No.

TO

Date.

Copy furnished Land Of.
November 19, 1920

Checked
File in Carton 1.

Description of Lot 9.

Kuniole and Waialua, Kau, Homestead Maps - 17

Beginning at a point on road marked + on rock which is 8124 feet North and 13890 feet West from local Survey Station "Puehu" ^{as shown on Home-} ~~stead Map No. 17 on file in the Office of the Government Survey and running~~ ^{and running} ~~at following~~ by true bearings:-

- * 1. S. 44° 0' E. line 202 feet along road.
- * 2. S. 0° 10' E. " ~~1427~~ " " Lot 8.
- * 3. N 51° 00' W. " 1310 " " Hilea iki.
- * 4. N ~~46° 35'~~ ^{47° 00'} E. " ~~1140~~ ¹¹⁴⁶ " " Lot 10 to initial point and containing an area of $19 \frac{81}{100}$ Acres.

Aug. 16th 1892,
C. A. Wall

* Changed by O. L. Sorenson Sept 23/04

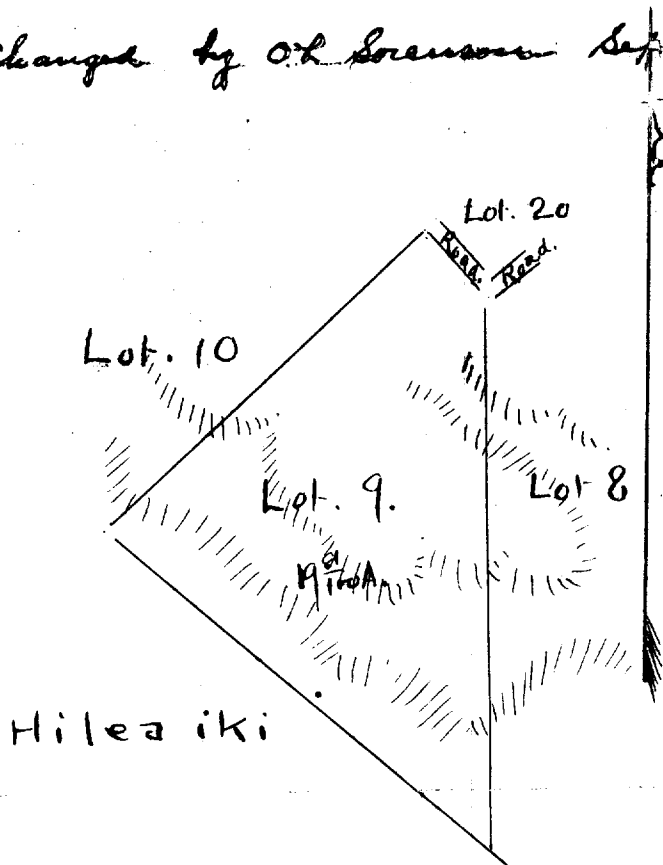

Scale. 500 ft = 1 inch.

7.	5.	2.	1.	area
1106.0	1603.2	1277.0	1187.0	1000

2500 ft - 2500 - 907