

Notes of Survey & Plan  
of Lots 82 and ~~83~~  
Punetapu. Waimoa

(See later surveys  
by C. Holley)

This incorrect

359, 621  
331 5-4  

---

28' 0 8

37 15  
9 6  
27 09

File in Carton 56

116  
1894

6

Commencing North East corner of Lot No 65 - Puntapiu Stone land reservation and running by magnetic N 10 1/2 W 615 ft to the corner post on east side of Puniki gulch. N 14 E 630 ft to a point on west side of Lanimaomas gulch. S 31 E 775 ft by center of the gulch to a point on west side of said gulch S 19 E 270 ft to a point of same gulch S 14 1/2 E 360 ft to a point by side of Puniki gulch and from here to the starting point

In this piece 11 3/4 Acs. more or less

Jan. 5. 1894

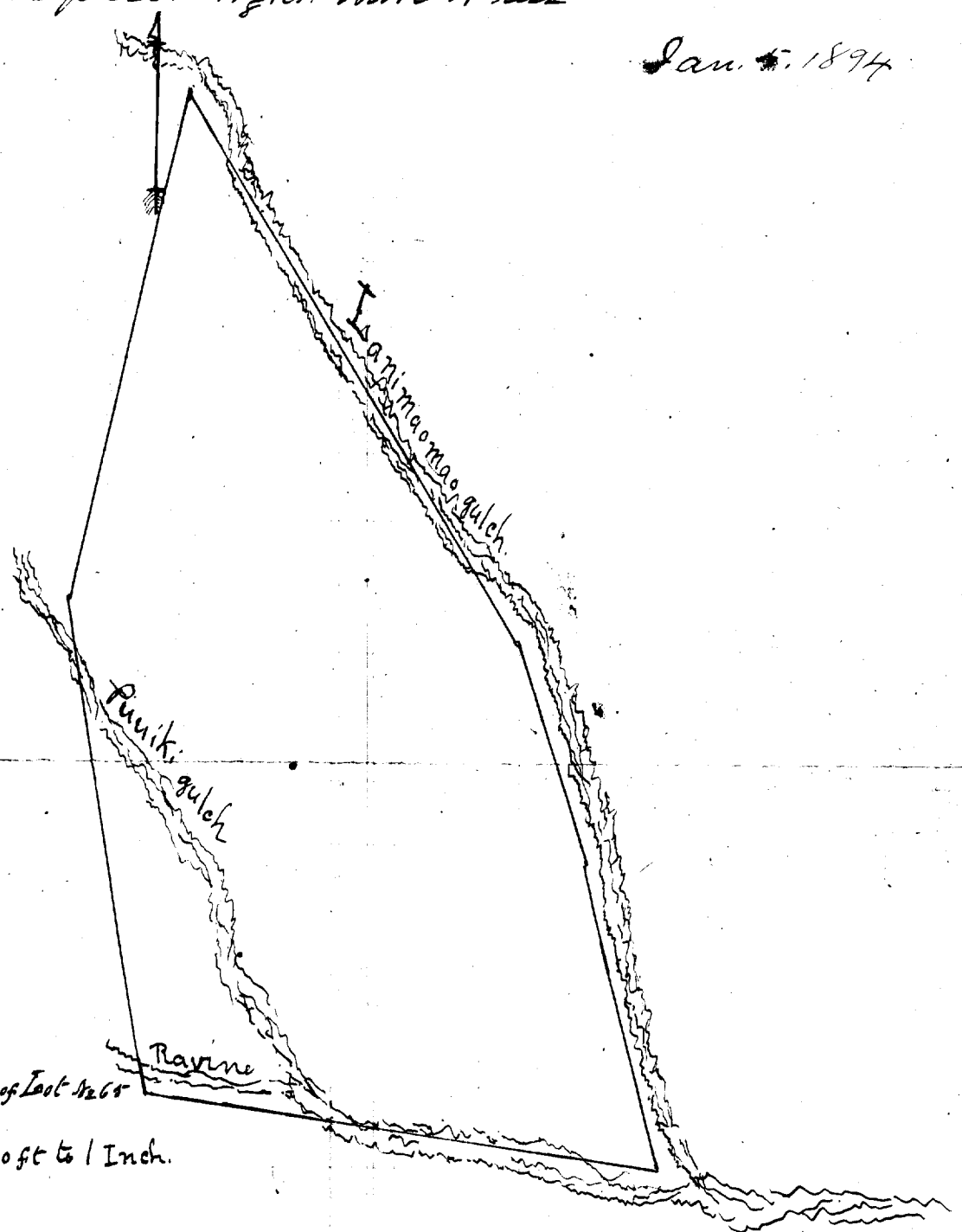

N.E. corner of Lot No 65

Scale 200 ft to 1 Inch.

Lot 82 Puukapu Hmstds.1st Series  
Addn.to Tree Nursery & Forest Ranger  
Station,Puukapu Homesteads.

For description see CSF 6145

*file in Carton 56*

Lot No W. L. Credenberg Leases

Courses:

Beginning at N.E. corner of Lot No and running  
S.  $14^{\circ}$  W. 680 ft. to a point in Puiki gulch. Thence  
up gulch N.  $72^{\circ}$  15' W. 336 ft. to a point on side of said  
gulch. Thence, N.  $73^{\circ}$  30' W. 385 ft. to a point on ridge  
between Puiki gulch and a branch thereof. thence  
N.  $37^{\circ}$  15' W. 269 ft. to Ohia tree on rise near side of  
said Puiki gulch; thence N.  $77^{\circ}$  15' W. 192 ft. to center  
of said gulch thence N.  $28^{\circ}$  15' W. 112 ft. to a point on side  
of gulch making upper corner of said lot thence  
N.  $46^{\circ}$  30' E. 580 ft. to center of Lanimaomas gulch  
thence down center of said gulch to the starting point

See this piece 15 Acs. more or less

Waima S. Kachala Feb. 13/94