

133  
S. H. May 24  
Chas. D. Jones jr  
Copy furnished for Grant  
Jan 5<sup>th</sup> 1899  
4271

file in Carton 51.

Description of Lot 8, Homestead Map. No. 24

Noolehua, Sp. 1. Kona, Molokai.

Beginning at a point on the makai side of a 25 foot road, said point being 282 feet South and 285 feet West of the point known as Keawe, and running:-

1. S. 21° 54' E. One 2428 feet along Lot 9 to sea shore,
2. S. 78° 10' W. " 235 feet along sea shore,
3. N. 21° 54' W. " 2309 feet along Lot 7 to road;
4. N. 49° 35' E. " 245 feet along road to the Initial point.

Area 12.66 Acres

Walter C. Wall.

February 1892

For Grant to Charles Dudaik Jr  
Purchase Price \$ 75<sup>00</sup>

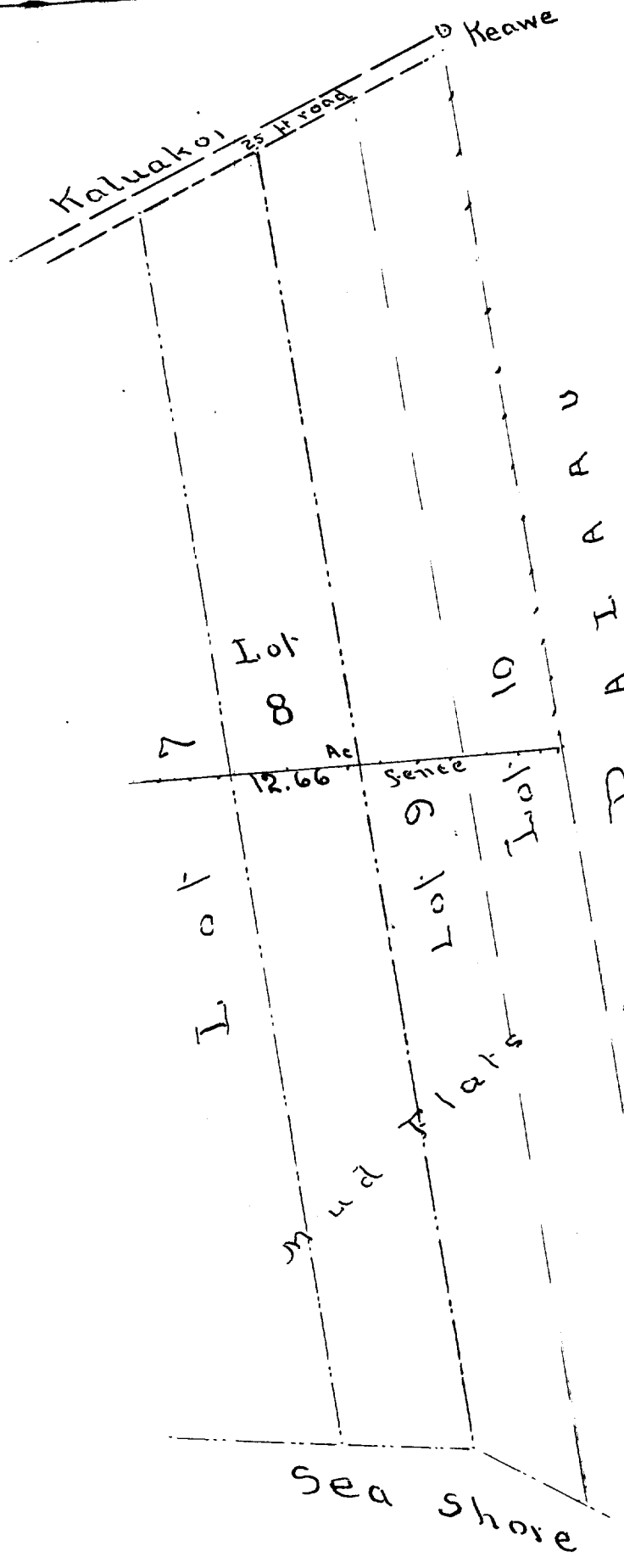

Sc. 300 ft to inch.  
 (Date) 51

*[Faint handwritten notes, possibly including a date like '1951']*