

Lot 7
Ahualoa Homestead
Map 18

Copy Furnished for Grant

Feb 3rd 1897

Grant No. 4008

Monella de Camara

File in Cartm, 72

Description of Lot 7

Abualoa Homestead - Map No-18

Beginning at ~~the point~~ which is 2263.3 feet S. and 7396.4 feet E. - from an iron pipe set in the ground at the N.W. corner of Homestead Lot No 18, and running as follows:

1. S. 4° 55' W true 1580.0 feet along Lot 6 -
2. N 85° 05' W " " 485.6 " " Gov't.
3. N 4° 55' E " 1580.0 " " Lot 8 -
4. S 85° 05' E " 485.6 " " Road to point of beginning and containing an area of $17 \frac{61}{100}$ acres.

C. Wall
Oct 15 1891 -

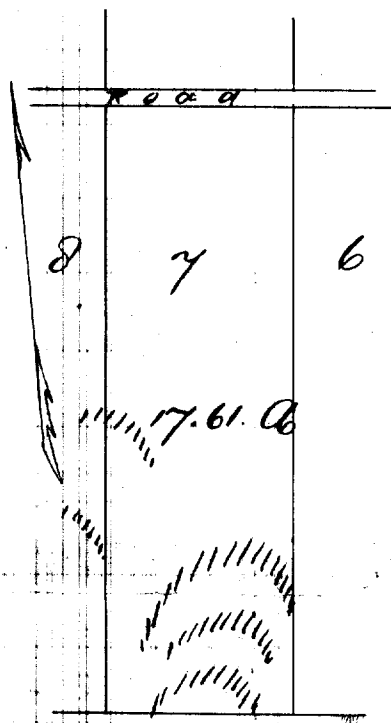

Gov't Land.

Scale 300ft = 1. in