

Lot 6.

Puuikawai Govt. Lots,
Okeo, Hawaii.

Grant 4486

To

William Kinney

Deed: Portion for road, Frederick G. and Eleanor Schoen
to the Territory of Hawaii dated October 21, 1949
Book 2296 page 499 Land Office Deed 8960

Dedication Deed: Portion for road, John N. Smith, Leslie A. Weight, and
Charles L. Murray to the Territory of Hawaii dated
December 18, 1950 Book 2420 page 480
Land Office Deed 9379

File in Carton 125.

Call "M" No. 125

PONAHAWAI, HILO, HAWAII, GOV'T. LOTS.

LOT ~~5~~⁶.

Notes of Survey:-

Beginning at West angle of lot #3 at pile of stones set over the figures $\frac{3}{6} \frac{4}{5}$ cut into the rock by road, the coord. of which point ref. to Govt. Survey Trig. Sta. "Halai" being 5244.2 ft. South and 6475.4 ft. West, as shown on Govt. Survey Reg. Map No. 3312, thad running by true bearings:-

- 1.- S. $26^{\circ} 58'$ W. 533 ft. along road and lot #5.
- 2.- S. $40^{\circ} 24'$ W. 686 ft. along road and lot #5 to West angle at pile of stones over the figures $\frac{8}{7} \frac{5}{6}$ cut in rock by road.
- 3.- S. $72^{\circ} 33'$ E. 2327 ft. along lot #7 to pile stones $\frac{7}{6}$ at South angle.
- 4.- N. $52^{\circ} 41'$ E. 334 ft. on lava flow.
- 5.- N. $7^{\circ} 26'$ E. 530 ft. on lava flow.
- 6.- N. $5^{\circ} 11'$ E. 515 ft. on lava flow to East angle at pile of stones $\frac{3}{6}$.
- 7.- N. $76^{\circ} 31'$ W. 1967 ft. along lot #3 to point of beginning.

Containing 61.5 acres. Reserving however therefrom a right of way 20 ft. wide along North boundary this lot, adjacent to lot #5.

A.B.Loebenstein. Surveyor Bureau Public Lands.

Hilo, Jan. 27th. 1896.

Not same as Grant 4486

PUNAHOA

Puu Ehee Stones

6
61.5 Acres

4

8

Old Timber Reef

5

Scale 500ft = 1 in

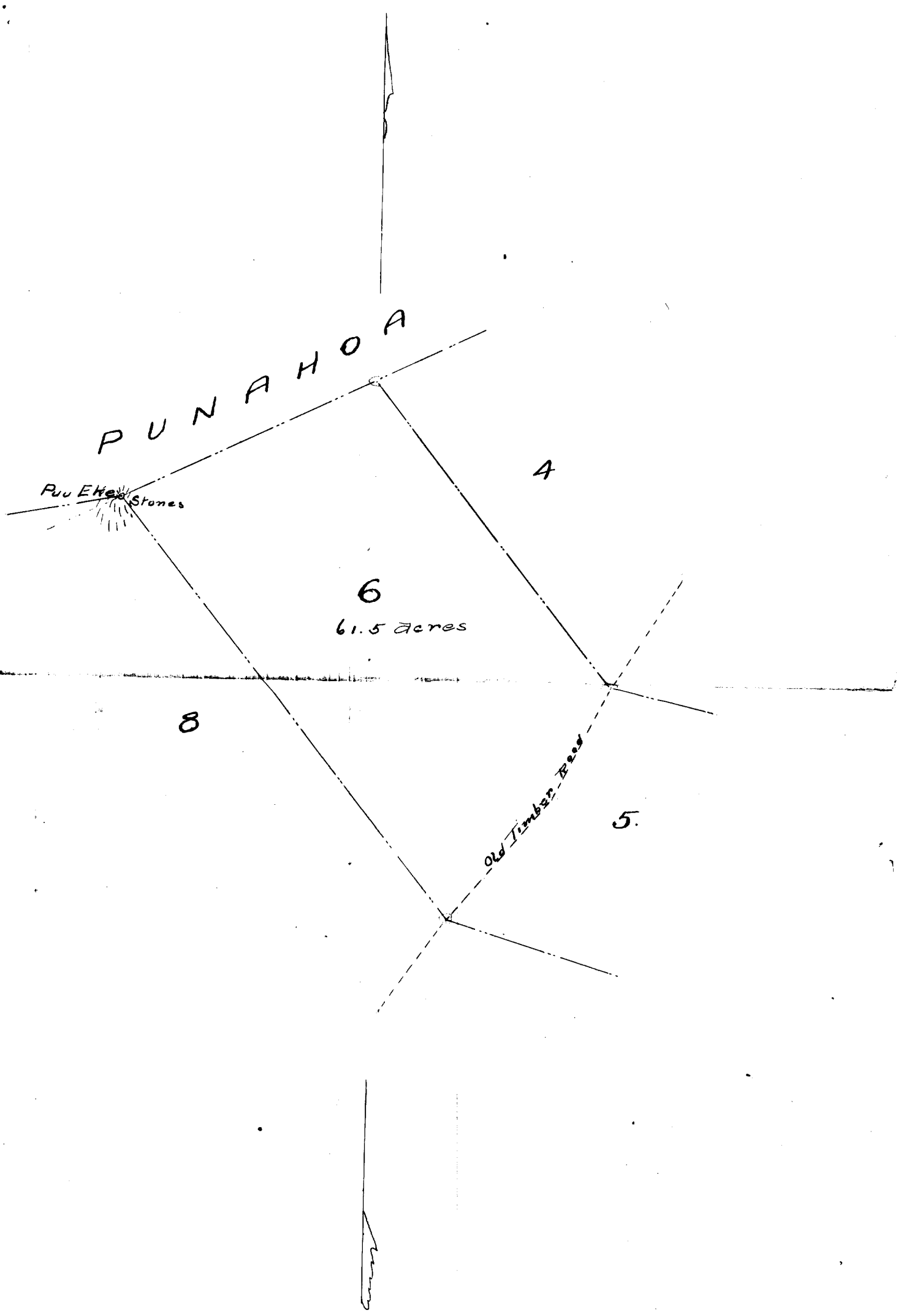

Ponchewai, Hils, Hausie, Gort Lts

Lt #6

Notes of Survey

File in Carton 125.



Puehawai, Hilo, Hawaii, Govt Lots
 Lot # 6

Notes of Survey.

Beginning at West angle of lot # 3 at file of stones
 The co-ords. of which referred to Govt. survey trig. Sta. Hala'i being ~~5844.15~~ ^{5584.15} West
 across the fence ~~3/4~~ cut into the rock by road, ~~the boundary line~~
 as shown on Govt. Survey Registered Map No. 2382, and running by true
 by true bearings bearings:-

- 1 - S 26° 58' W - 533 ft. along road and lot # 8
- 2 - S 40° 24' W - 686 to West angle at file of
 stones on the fence ~~2/5~~ ^{2/6} cut in rock by road
- 3 - S 72° 35' E - 2827 . along lot # 7 to file of stones 7/6 at South angle
- 4 - N 52° 41' E - 334 . on lava flow
- 5 - N 7° 26' E - 530
- 6 - N 5° 11' E - 575 to East angle at file of stones 3/6
- 7 - N 76° 31' W - 1967 . along lot # 3 to point of beginning

Containing 61.5 acres. Reserving however therefrom a right of way
 20 ft. wide along North boundary this lot, adjacent to lot # 5.

A. B. Liebenstein Surveyor Bureau Public Lands

Hilo January 29 - 1896

Not same as Grant 4486

N.	S.	E.	W.	Coords.
1699.5	1695.3	2600.6	2539.1	5584.15 W 6475.37

J. P. S. 5/14/12

~~the~~ Lot 6

Description as described
in Grant 4486

(See Reg Map No 2312.) LAND PATENT NO. 4486

(Grant)

On Cash Freeholds under Part VII of Land Act of 1895.

By this Patent the Governor of the Territory of Hawaii, in conformity with the laws of the United States of America and of the Territory of Hawaii, makes known to all men that he has this day granted and confirmed unto

William Kinney

for the consideration of Four Hundred and five Dollars, \$405.00/100 paid into the Treasury.

And for the further consideration of his having complied with the terms and conditions of Part VII of the Land Act of 1895

all of the land situate at Ponahawai
in the District of Hilo Island of Hawaii bounded and described as follows:

Lot No. 6 Freehold Agreement No. 12 First Land District

Beginning at the North corner of this Lot, which point is the west angle of Lot No. 3, and marked by a pile of stones, set over the figure cut into the rock by old trail, the coordinates of which point are 5844.15 feet south and 6475.37 feet west of Halai Trig. Station and running:-

- S. 76° 31' E. (True) 326 feet along lot No. 3 to point on edge of Kaumana Road;
- S. 1° 10' E. (True) 141 feet along Road;
- S. 29° 45' W. (True) 121 feet along Road;
- S. 16° 00' W. (True) 195 feet along Road;
- S. 53° 15' W. (True) 94 feet along Road;
- S. 63° 30' W. (True) 332 feet along Road;
- S. 38° 11' W. (True) 119 feet along Road;
- S. 29° 00' W. (True) 119 feet along Road;
- S. 72° 33' E. (True) 51 feet across Road;
- N. 29° 00' E. (True) 109 feet along Road;
- N. 38° 11' E. (True) 98 feet along Road;
- N. 63° 30' E. (True) 333 feet along Road;

N. 53° 15' E. (True) 110 feet along Road;
 N. 16° 00' E. (True) 209 feet along Road;
 N. 29° 45' E. (True) 125 feet along Road;
 N. 1° 10' W. (True) 142 feet along Road to line of lot No. 3.
 S. 76° 31' W. (True) 1588 feet along Lot No. 3 to east angle at
 pile of stones 3/6;
 S. 5° 11' W. (True) 515 feet on Lava flow;
 S. 7° 26' W. (True) 530 feet on Lava flow;
 S. 52° 41' W. (True) 334 feet on Lava flow to pile of stones 6/7
 at South Angle;
 N. 72° 33' W. (True) 1973 feet along lot No. 7 to edge of Kaumana
 Road;
 N. 29° 00' E. (True) 200 feet along Road;
 N. 72° 33' W. (True) 311 feet across Road; to West Angle;
 N. 40° 24' E. (True) 471 feet along Lot No. 5;
 N. 26° 58' E. (True) 533 feet along Lot No. 5 to point of begin-
 ning. Containing 59.6 Acres.

Containing 59.6 Acres, more or less.

TO HAVE AND TO HOLD the above granted Land unto the said

William Kinney

and his heirs and assigns forever.

IN WITNESS WHEREOF, The Governor of the Territory of Hawaii,
 has hereto set his hand and caused the Great Seal
 of the Territory to be hereunto affixed, this
28th day of June A. D. 1901.

(Great Seal)

(S) Henry E. Cooper.
Acting Governor

BY THE GOVERNOR

(S) Edward S. Boyd.
Commissioner of Public Lands.