

Lat 6

Homestead Map # 24

Koolohua.

Grant No.

TC

Date.

File in Carton 51.

Signed -

Description of Lot 6, Homestead Map #24
Koolihua, Sp. 1, Kona, Molokai.

Beginning at a point on the makai side of a 25 foot road, said point being 662 feet South and 733 feet West of the point known as Keawe, and running:-

- 1 S. 21° 54' E. True 2136 feet along Lot 7 to Sea shore,
- 2 S. 72° 10' W. . 322 feet along Sea shore,
- 3 N. 21° 54' W. . 2004 feet along Lot 5 to road,
- 4 N. 49° 35' E. . 340 feet along road to the Initial point.

Area 15.35 Acres.

Walter E. Wall.

February, 1892

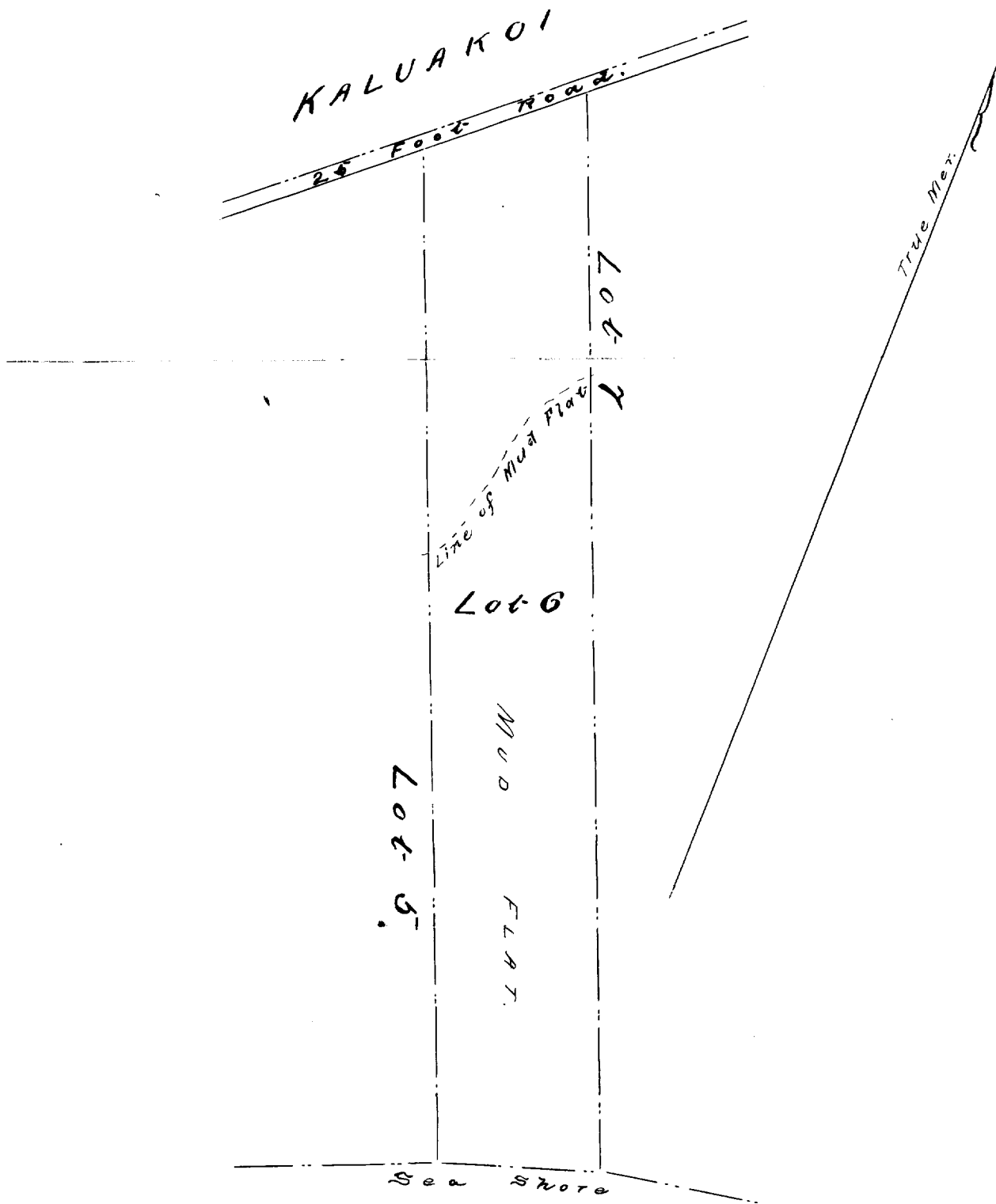

Scale 300 Feet to an Inch.