

Lot no. 5
Hmstd map no. 12
Naauhulu, Hawaii

Grant 3796
Gas. Olson

File in Carton 75

Grant 3776 to Jas. Olesen
 June 21 - 1895

Description of Lot No. 5
 Homestead Map No. 12
 Kaunakakai, Hamakua, Hawaii

Beginning at the N.E. corner of Lot 5

- joining Lot 3, and running
- S 22° - 28' N true 700 feet along boundary of Keahakea;
 - N 67° - 15' W " 712 ft along Lot 7 to a sunken rock marked
 at reserved road;
 - N 30° - 26' E " 186 ft along reserved road;
 - N 8° - 34' E " 559 ft along " " "
 - S 65° - 48' E " 819 ft along Lot 3 to initial point.
- and containing an area of $12\frac{2}{100}$ acres.

Chas. Notley Jr.
 Surveyor

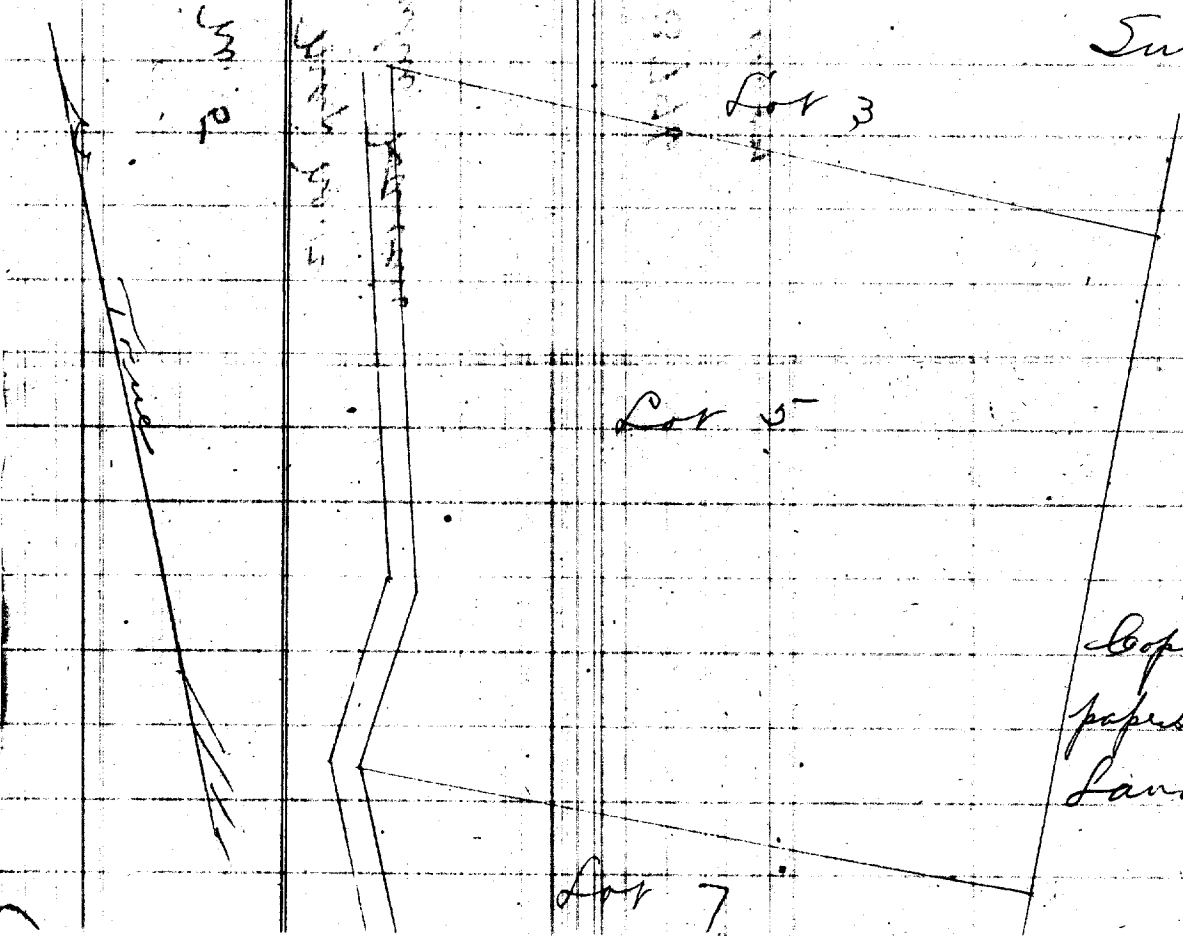

Copied from original
 papers on file in the
 Land Office