

Lot 5

Ninole & Waitau. Kau.
Homestead map. No 17

Grant No. 5277

TO Sarah Ann Searle

Date. Mar. 21-1910

Copy furnished Land Office
Feb. 23, 1910.

File in Carton 1.

Description of Lot 5.

Kinoh and Waialau Homesteads Law, Map, 17

Beginning at a point on road marked ^{by} + on rock which is North 7807 feet, and West 11021 feet from South Survey Station Pukhu, ~~as shown on Homestead~~ ^{as shown on Homestead} Map No. 17 on file in the Office of the Government Survey, and running as follows:

1. S. 34° 30' W true 820 feet along Lot. 4
2. N 40° 50' W " 576 " " Nawali ap. 2.
- * 3. S. ~~40° 40'~~ ^{43° 30'} W " ~~424~~ ⁴⁶⁰ " " " "
4. N 30° 50' W " 460 " " Kapana. ap. 1.
5. N 33° 30' E " 795 " " Lot 6.
6. S. 65° 00' E. " 1090 " " road to initial point and containing an area of $19\frac{43}{100}$ acres.

* Changed by Newton - March 1907

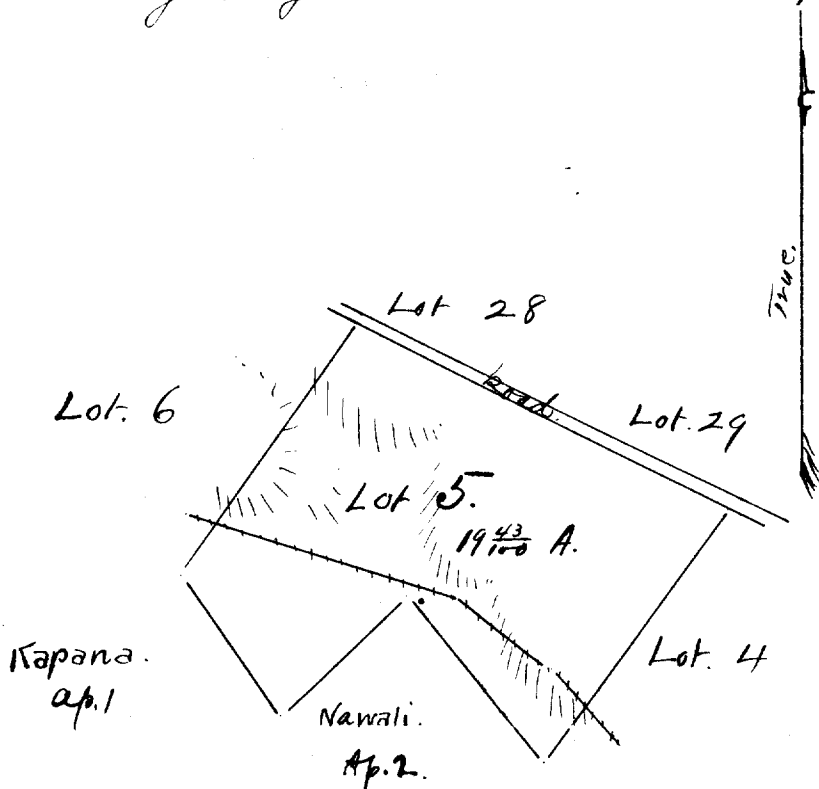

Scale. 500 feet = 1 inch.

11021 7807 1090 795 460 576 820