

Lot 4.

Ninole & Waitan. Kan.

Homestead Map No. 17

Grant No. 5254

TO John C. Searle

Date. Mar. 21 - 1910

Copy furnished Land Office  
Feb. 23, 1910.

Checked  
File in Carton 1.

# Description of Lot 4

Ninole & Wailau Homesteads Map. 17

Beginning at a point on road marked <sup>by</sup> + on rock, which is 7807 feet North and 11021 feet West from South Survey Station "Puehu" see claim on Homestead Map No. 17 on file in the Office of the Government Survey, and running as follows:

1. S. 87° 50' E. true 420 feet along road.
2. S. 16° 10' W " 1070 " " Lot 3.
3. N. 50° 35' W " 818 " " Grant 2103.
4. N. 30° 10' E " 445 " " Nawali ap 2.
5. N. 34° 30' E " 820 " " Lot 5 to initial point and containing an area of  $19\frac{80}{100}$  Acre.

Aug 8<sup>th</sup> 1892,  
Wawae

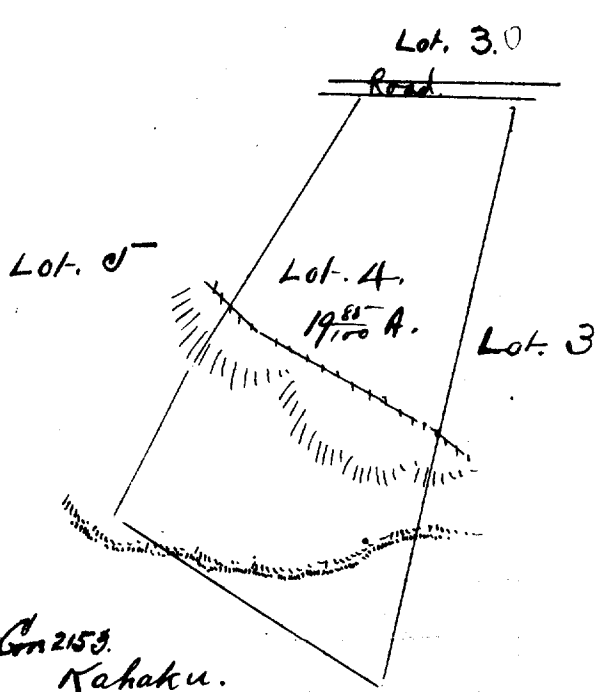

Con 2153  
Kahaku.

Scale. 500ft = 1 inch

1112.0 1114.0 1116.0 1118.0 1120.0

1122.0 1124.0 1126.0 1128.0