

Lot 3.

Homestead Map No. 5

Panama, Panama.

Copy Furnished for Grant

June 10th 96

Grant No. 3964

Manuel dos Santos

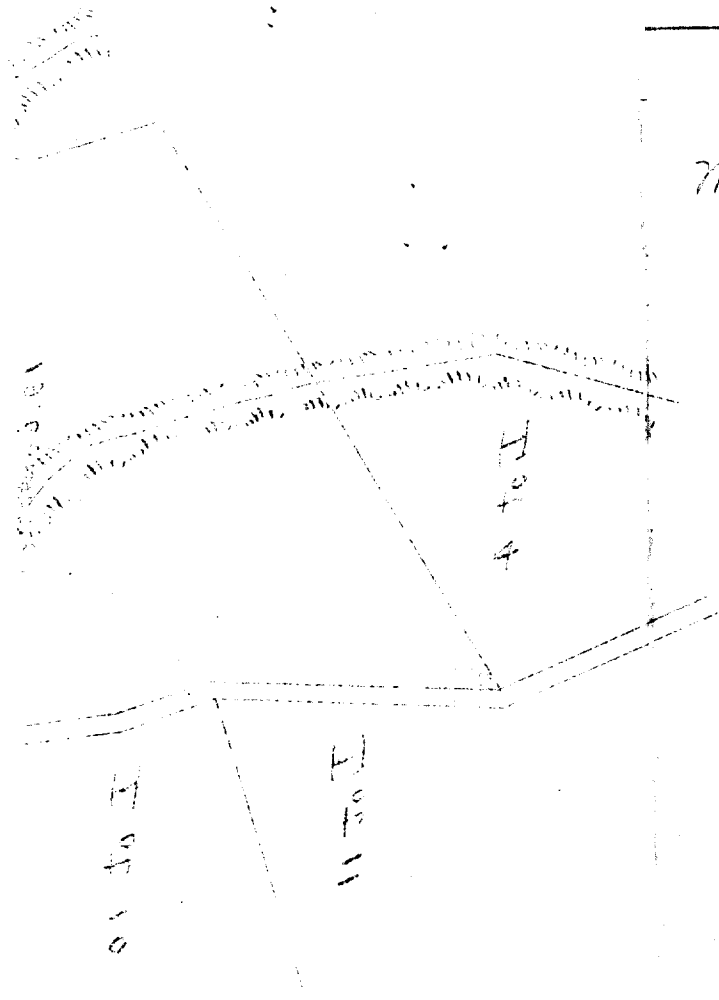

300 ft. long

File in carton 81

Homestead Map No. 5
Paauilo, Hamakua, Hawaii.

Lot 3

Beginning at the east angle, at 30 ft. read, joining Lot 2,
this point being S 772 ft. W 7761 ft. approx. from Kehelalele Sta,
thence running by true bearings:

- I. S 7 28 W 322 ft. along 30 ft. read;
2. S 19 30 W 144 ft. " ;
3. S 2 15 E 201 ft. " ;
4. S 1 23 E . 250 ft. " ;
5. N 59 20 W 1035 ft. along lot 4;
6. N 17 27 E 207 feet;
7. N 5 42 W 154 feet;
8. N 4 10 E 194 feet;
9. N 34 49 E 330 feet;
10. N 45 38 E 147 feet;
- II. S 49 00 E 811 feet along lot 2 to point of beginning.

Area 19.60 acres.

Notes of survey by O.L. Sorenson
from Map by J.F. Brown

June 3rd 1896.

Gov't Land

Lot 2

Lot 3

19.60 acres

Lot 10

Lot 11

Lot 4

Scale 300ft = 1 inch

Lot 2

Government Map No. 2

Quarter of Section

Area 100 acres

Area 100 AC

Area 100 AC

Area 100 acres