

Homestead Map 4

Lot 2

Copy furnished Land Office

Ap. 22 1896

Grant No. 3937

TO H. Hebb

Date

Homestead Map 4.
Hamakua, Hawaii.

Lot 2. in Henchenuka.
Beginning at a point 860 feet South, and
2894 feet East of Kuituilanalamahoe
trig station, and running by true bearings
as follows:

- 1 N 85° 0' E 355 feet along the Government road;
- 2 S 24° 35' E 140 feet along the same;
- 3 S 9° 35' E 354 feet along the middle of gulch;
- 4 S 24° 30' E 175 feet along the same;
- 5 S 2° 30' N 88 feet along the same;
- 6 S 51° 55' N 310 feet along the same;
- 7 S 18° 5' N 140 feet along the same;
- 8 N 67° 35' N 500 feet along S. C. A. 8064. Kueha;
- 9 N 13° 30' E 850 feet along Lot 1, to the initial
point, and containing an area
of 12 $\frac{10}{100}$ acres.

From lines of Homestead Map 4.
March 24, 1896. S. M. Kauakauai,
Asst on Foot Survey,

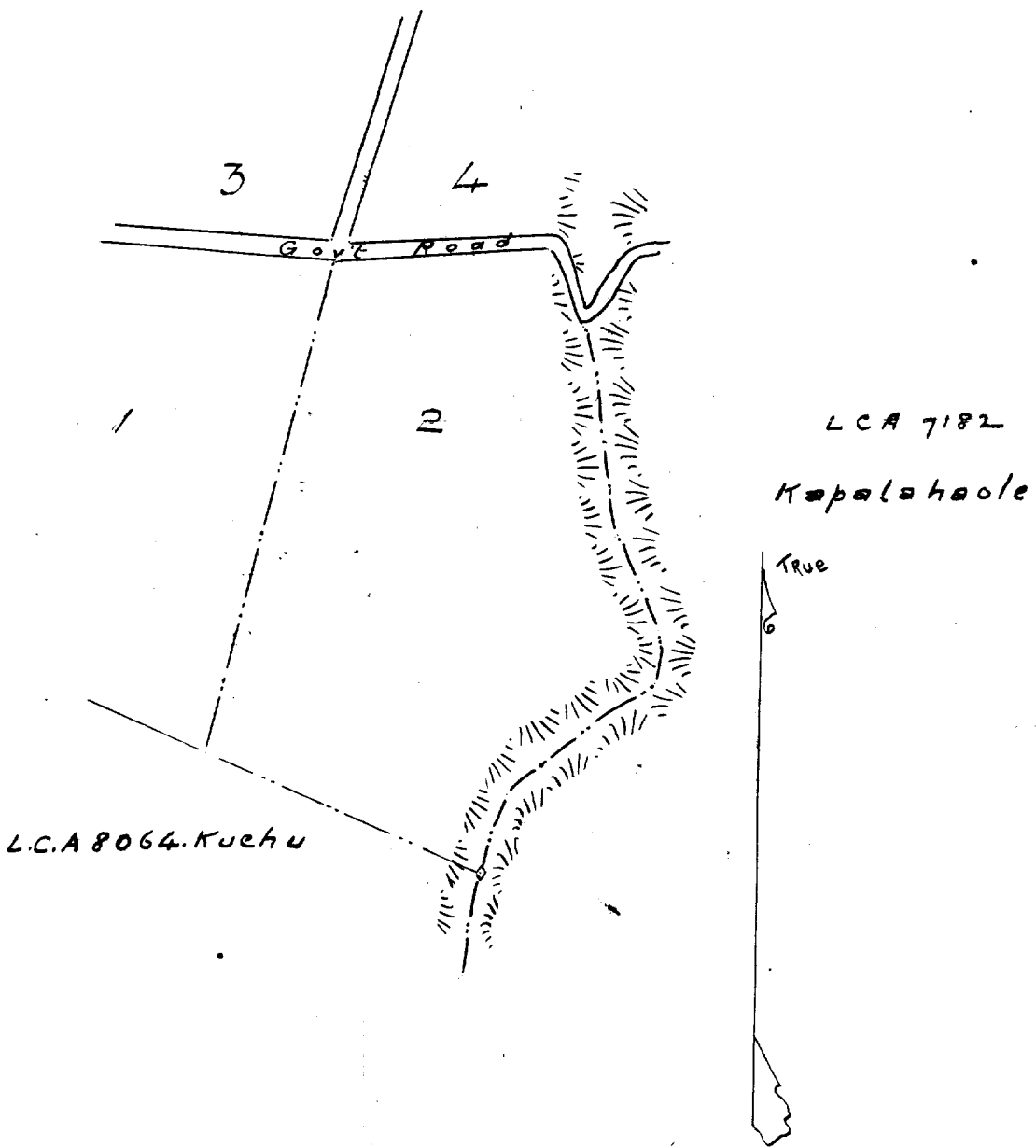

L.C.A 8064. Kuchu

LCA 7182
Kapala haole

Scale 300 feet = 1 inch