

Lot 2

Mannel Pimental

Lot 2.
Homestead Map No. 5
Paaius, Hamakua.

Copy Furnished for Grant

July 23, 1898-

Grant No. 4216

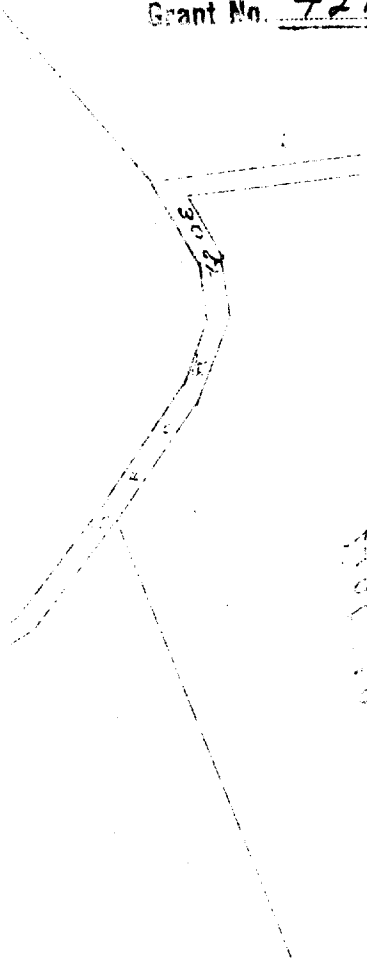

File in Carton 81

Gate 100 ft - 1 inch

Homestead Map No. 5
Paauilu, Hamakua, Hawaii.

Lot 2

Beginning at the east angle, at 30 ft. road, joining Lot I,
this point being S 262 ft. W 6968 ft. approx. from koholalele sta.
thence running by true bearings:

1. S 13 10 W 169 ft. along 30 ft. road;
2. S 30 18 W 152 ft. along 30 ft. road;
3. S 52 00 W 228 ft. along 30 ft. road;
4. S 56 10 W 213 ft. along 30 ft. road;
5. S 68 58 W 110 ft. along 30 ft. road;
6. N 82 37 W 79 ft. along 30 ft. road;
7. N 60 15 W 151 ft. along 30 ft. road;
8. N 49 00 W 811 ft. along Lot 3;
9. N 45 38 E 130 feet; along Govt land
10. N 31 28 E 411 feet; " "
11. S 66 58 E 1196 ft. along Lot I to point of beginning.

Area 19.20 Acres.

Notes of survey by O. L. Sorenson
from Map by J. P. Brown.

June 3rd 1896.

Purchase Price \$ ~~142.50~~ \$ 144⁰⁰

Govt. Land

Lot 1

Lot 2

19.20 Acres

Lot 9

Lot 3

Lot 10

W. M. ...
...

3 to 4
can pass ...
...

1/2
3/4
...



Scale - 300ft = 1 inch

