

Lot 2
Punalhawai Grant. Lots,
Ohilo, Hawaii
Grant 4673
To
Joao Vierra

File in Carton 125.

Territory of Hawaii,

Office of the Government Survey.

Honolulu, T. H.,

Lot 2.
Ponahawai Government Lots,
Hilo, Hawaii.

Beginning at the North corner of this lot and the East corner of Lot 1, the coordinates of which point referred to Government Survey Trig. Station "Halai" being 3623.5 feet South and 4790.4 feet West, as shown on Government Survey Registered Map No. 2312, the boundary runs by true bearings:

1. S 43° 47' W 465 feet along road and Lot 1;
2. S 38° 31' W 716 feet along road and Lot 1;
3. S 24° 13' W 413 feet along road and Lot 1 to West angle at pile of stones over mark $\frac{1}{4} \frac{2}{3}$ cut in rock;
4. S 76° 50' E 1565 feet along Lot 3 to South angle at pile of stones on lava, under which are cut in the rock the figures $\frac{2}{3}$
5. N 15° 24' E 310 feet;
6. N 13° 46' W 629 feet;
7. N 36° 09' W 889 feet to point of beginning.

Containing 33.9 acres. Reserving however therefrom a right-of-way 20 feet in width along the North boundary of this lot adjacent to Lot 1.

*compared
May 15 1896
C.H.*

A. B. LOEBENSTEIN

Surveyor Bureau Public Lands,

Hilo, January 27, 1896.

Grant 4673 to Joao Vierra

not same as in Grant

PONAHAWAI, HILO, HAWAII, GOV'T. LOTS.

LOT #2.

Notes of Survey:

Beginning at ^{the North corner of this lot and} East corner of lot #1, the coordinates of which point referred to Government Survey Trig. Station "Halai" being 3623.5 feet South and 4790.4 feet West, as shown on Government Survey Registered Map No. 2312, the boundary runs by true bearings:

- 1.- S. ⁴³⁻²⁶43° 47' W. 465 ft. along road and lot #1.
- 2.- S. 38° 31' W. 716 ft. " " " "
- 3.- S. 24° 13' W. 413 ft. " " " " to West angle at pile of stones over mark $\frac{1}{4}\frac{2}{3}$ cut in rock
- 4.- S. 76° 50' E. 1565 ft. along lot #3 to South angle at pile of stones on lava, under which are cut in the rock the figures $\frac{2}{3}$
- 5.- N. 15° 24' E. 310 ft.
- 6.- N. ¹³⁻²⁴13° 46' W. 629 ft.
- 7.- N. 36° 09' W. 889 ft. to point of beginning.

Containing 33.9 acres. Reserving however therefrom a right of way 20 ft. in width along the North boundary of this lot, adjacent to lot #1.

A.B.Loebenstein. Surveyor Bureau Public Lands.

Hilo, January 27th. 1896.

*See Hilo Cal. BK. 2 pg. 132 for coord.
Nov. 1914*

*Coord in Gt.
From Halai { 3623.5 ft. S.
4799.09 ft. W.*

*Coords.
3623.5 1V 4790.4
16277-16281-16282-16282
1442*

Lot 2
Description as described
in Grant 4673
(see Reg Map 2312)

LAND PATENT NO. 4673

(Grant)

On Rights of Purchase Lease under Part VII of the Land Act of 1895

By this Patent the Governor of the Territory of Hawaii, in conformity with the laws of the United States of America and of the Territory of Hawaii, makes known to all men that he has this day granted and confirmed unto

Joao Vierra

for the consideration of Three hundred & Thirty-nine 00/100 Dollars, \$339 00/100 paid into the Treasury.

And for the further consideration of his having complied with the terms and conditions of Part VII of the Land Act of 1895

all of the land situate at Ponahawaii
in the District of Hilo Island of Hawaii bounded and described as follows:

Right of Purchase Lease No. 8

Lot No. 2, Public Lands Map No. 3, First Land District.

Beginning at the North corner of this Lot at pile of stones, the coordinates of which point are 3629.21 feet South and 4799.09 feet West of Halai Trig. station, and running:-

- S. 43° 26' W. True 452.5 feet along Lot 1;
- S. 38° 31' W. True 716 feet along Lot 1;
- S. 24° 13' W. True 413 feet along Lot 1 to mark on pahoehoe in old road, ;
- S. 76° 50' E. True 1565 feet along Lot 3, to pile of stones on the 1881 Lava flow marked 2/3;
- N. 15° 24' E. True 310 feet on 1881 lava flow;
- N. 14° 24' W. True 624.8 feet on 1881 lava flow;
- N. 36° 9' W. True 889 feet along Grant 252, to the point of beginning.

33.9 Acres

Less 50 ft. Road Right of Way Reserve 1.6 Acres as described on Plan
32.3 Acres

Containing

Containing 32.3 Acres, more or less.

TO HAVE AND TO HOLD the above granted Land unto the said

Joao Vierra

and his heirs and assigns forever.

IN WITNESS WHEREOF, The Governor of the Territory of Hawaii,
has hereto set his hand and caused the Great Seal
of the Territory to be hereunto affixed, this
20 day of April A. D. 1903.

(Great Seal)

(S) Sanford B. Dole

BY THE GOVERNOR:

(S)

Edward S. Boyd
Commissioner of Public Lands.

Deed No. **S-17895-A**

Class **Warranty Deed**

Grantor
COSTA, Antone B.

Grantee
State of Hawaii

Date of Instrument
2/15/61

Book
4043

Page
,07

Area
9,592 sf.

Consideration
\$1.00

Description
.220 ac.

Grantor conveys a 30-Foot Roadway within the subdivision in Ponahawai Homesteads, situate at Ponahawai, South Hilo, Hawaii.

RECORDED
- 15 -
SUBDIVISION
1961 JUL 22 PM

Lot 2,
Ponahawai Government Lots,
Ponahawai, Hilo, Hawaii.

As contained in Grant No.4673.

File in Carton 125.

Description of Lot 2, situate at Pona-
hawai, Hilo, Hawaii, Public Lands Map
No. 3, First Land District, as is con-
tained in Grant No. 4673 issued to
Joao Vierra.

Beginning at the North corner of this Lot at
pile of stones, the coordinates of which point are 3629.21
feet South and 4799.09 feet West of Halai Trig. Station
and running:-

S. 43°	26' W.	True	452.5	feet	along	Lot 1;
S. 38°	31' W.	"	716	"	"	"
S. 24°	13' W.	"	413	"	"	" to mark on pahoe- hoe in old road $\frac{1}{2}$ <u>3</u> 4
S. 76°	50' E.	"	1565	"	"	Lot 3, to pile of stones on the 1881 Lava flow marked 2/3;
N. 15°	24' E.	"	310	"	on	1881 lava flow;
N. 14°	24' W.	"	624.8	"	"	" "
N. 36°	9' W.	"	889	"	along	Grant 252, to the point of beginning.

33.9 Acres

Less 50 ft. Road Right of Way Reserve 1.6 " as described
on Plan

Containing 32.3 Acres

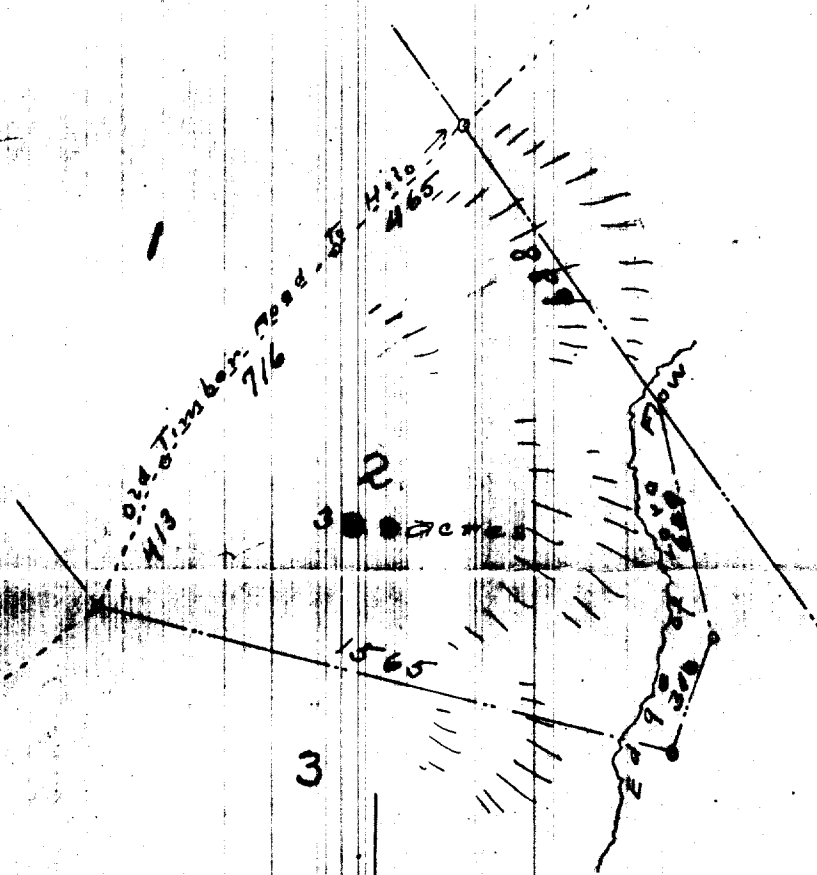

Scale 500ft = 1in.