

Lot 1.
Kauai
Kauai Hawaii

Copy furnished Land Office
May 12 1909

Lot 517 + J. De Silva

File in Case 73

Description of Lot 1. Hanokaa - Hamakua Hawaii

Beginning at a point which bears $N 85^{\circ} 05' W$
as shown on Government Survey Registered Map No. 1878
 true 200 ft. from the S. W. corner of Lot 2, and
 running as follows by true bearings.

1. $N 15^{\circ} 16' E$ ~~277~~²⁰⁵ ft along look. reserve to road.
- 299 2. $S 87^{\circ} 28' W$ ~~270~~²⁹⁹ " " 50 ft road.

3. ~~$S 35^{\circ} 06' W$ 240 " " do~~
- 280 4. $N 82^{\circ} 20' W$ ~~280~~²⁸⁰ " " do -
- 193 5. $N 60^{\circ} 05' W$ ~~200~~¹⁹³ " " do -
6. $S 12^{\circ} 05' W$ 1855 " " 40 ft road.
7. $S 27^{\circ} 00' W$ 830 " " do -
8. $S 85^{\circ} 05' E$ 910 " " Look ^{land} to the initial

point and containing an
 area of ~~48.100~~^{48.165} acres.

OK *W. E. Wall*
 May 12 1909.

2039.6 2741.0 1152 116.6 area 48.0 ^{of 24}

Description corrected to conform to distances on opposite side of road, along Lot 2, which is a more satisfactory description.

Artifical copy of original description and sketch plan
 furnished the Land Commissioner, Aug. 1-1906

W. E. Wall.
 Surveyor.

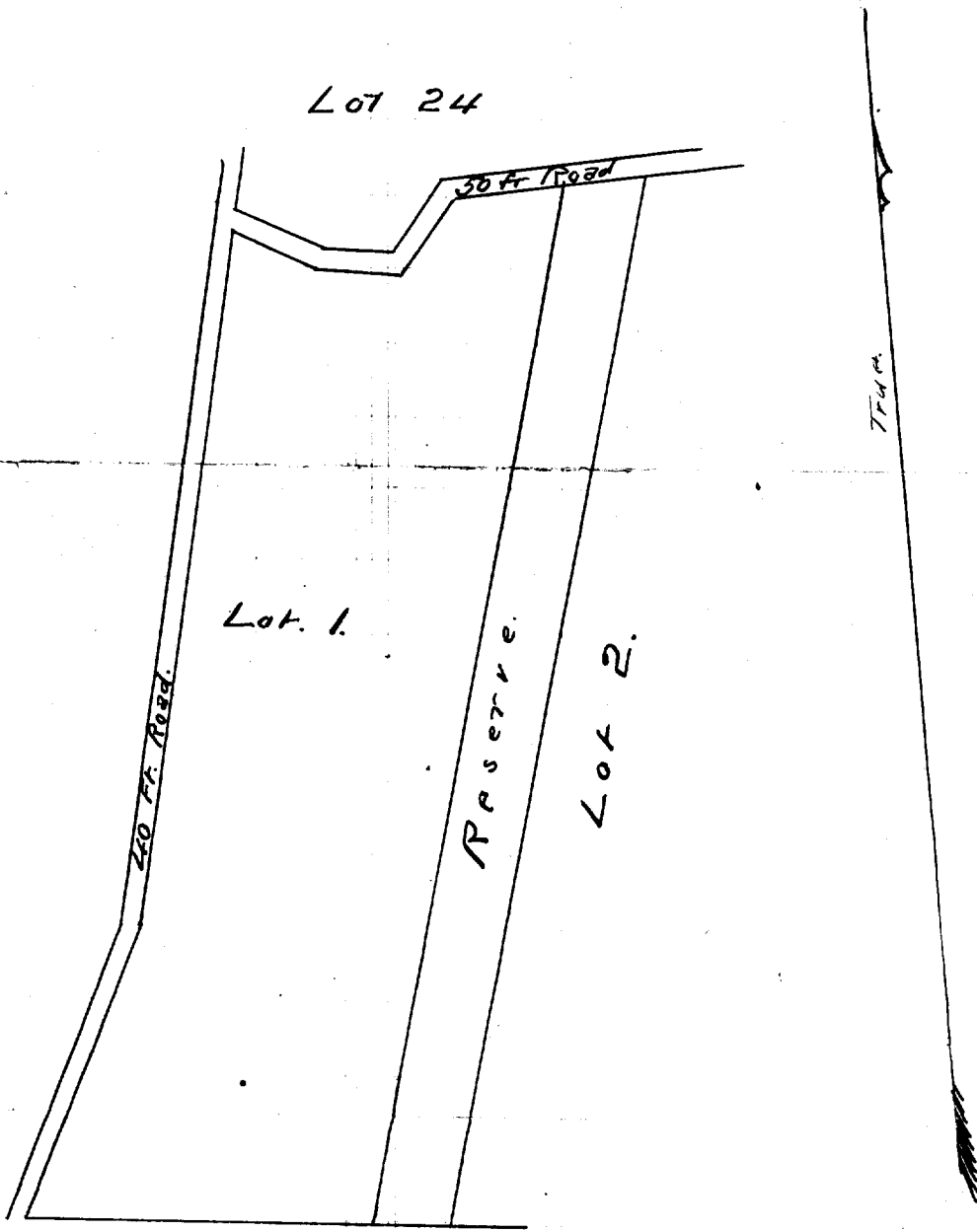

Govt.

500 ft = 1 inch.