

Homestead Lot 13

Map 6

N. Kane, Hawaii

Grant No. 3736

TO L. Kane

Date

Copy furnished

Land Office

Sept 19 1944

File in Carton 18

Description of Homestead lot 13. Map. 6  
in Kohanaiiki - N. Kona. Hawaii

Beginning at a rock marked + by Ahu, on boundary  
of Kaloko, being the common corner of lots 13 & 14  
thence the boundary runs by true bearings:

S 86° 41' W 230 ft. along boundary of Kaloko.

N 3° 45' W 703 .. .. lot 12

N 73° 16' E 242.3 .. .. (Kohohakaiki Road)

S 3° 20' E 760 .. .. lot 14 to initial point

Area  $3 \frac{92}{100}$  Acres

J. F. Brown  
Sept 21<sup>st</sup> 1914

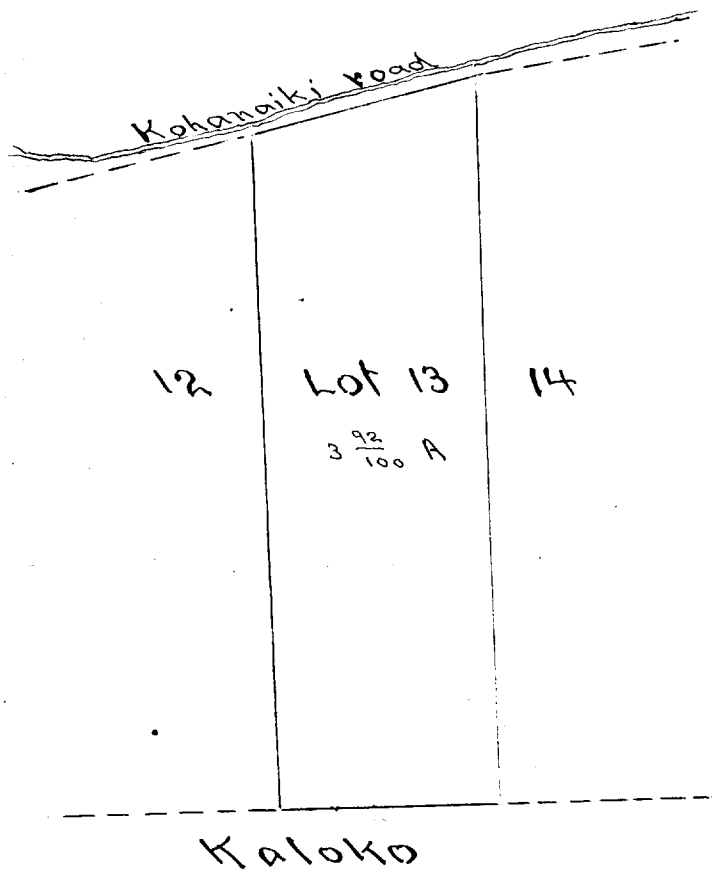

Scale: 200 ft. to inch