

Lot 5
Waiaha
North Kona
Hawaii

Norm = Flood 915.2

Amended description

by

W. A. Wall.

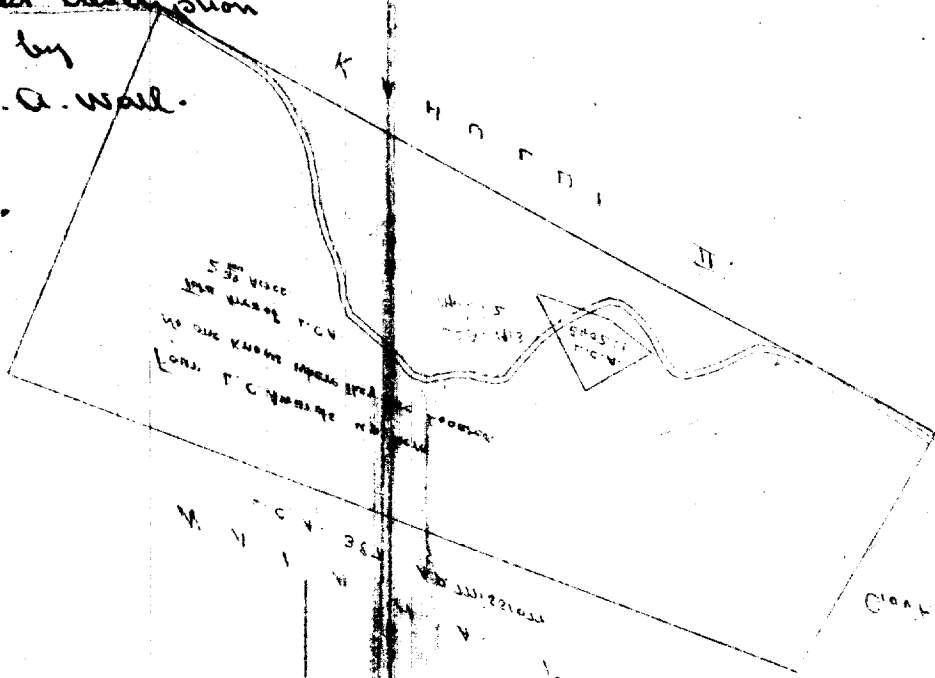

Description of Lot 5.

Waiaha II, North Kona Hawaii

Beginning at the S.E. corner ^{with} Lot 4¹ and running ^{from which point see sketch & bearings 178 27 E 1130.0 ft.} as follows by true bearings -

1. N $61^{\circ} 20'$ E. 2300 ft along Kahului II
2. ~~N $30^{\circ} 00'$ W~~ ^{N $29^{\circ} 35'$ W} 410 " " " " I (Eok)
3. S $69^{\circ} 40'$ W. 2200 " " Waiaha I
4. S $22^{\circ} 35'$ E ~~1020~~ ^{1035.0} " " Lot 4 to the initial point and containing an area of 43 acres.

The rights of Native Kuleanas reserved.
Also 30 ft roadways as shown on map.

Honolulu Aug. 23, 1898
W. W. Wall

Corrected Geo F. Wright
Jan - 07.

S 1720.78	E 2415.55
N 1720.9	" 2413.47
0.69	2.13

Carton 23

N	S	E	W
1720.7	1719.1	2415.6	2413.4
		G.B.L.	Jan - 19 - 07

5. P. L. Map. No 5. Waiaha.

Description of Lot 4, North Kona, Hawaii.

Beginning at the South East corner of Lot and
running as follows by true bearings,

1. N. 61° 20' E. 2300 ft. along Kahului 2,
2. N. 30° 00' W. 690 ft. along Kahului I, Gov't,
3. S. 69° 40' W. 2200 ft. along 20 ft. Roadway,
4. S. 22° 35' E. 1000 ft. along Lot to the Initial Point,

and containing an area of 43.11 acres.

The rights of two Native Kuleanas reserved as shown
by plan.

Honolulu, May 13th, 1896.

W. W. Wall.

Approx
 2 year lease
 1000 sq ft

Primary operation

Lot
 N. S. M.

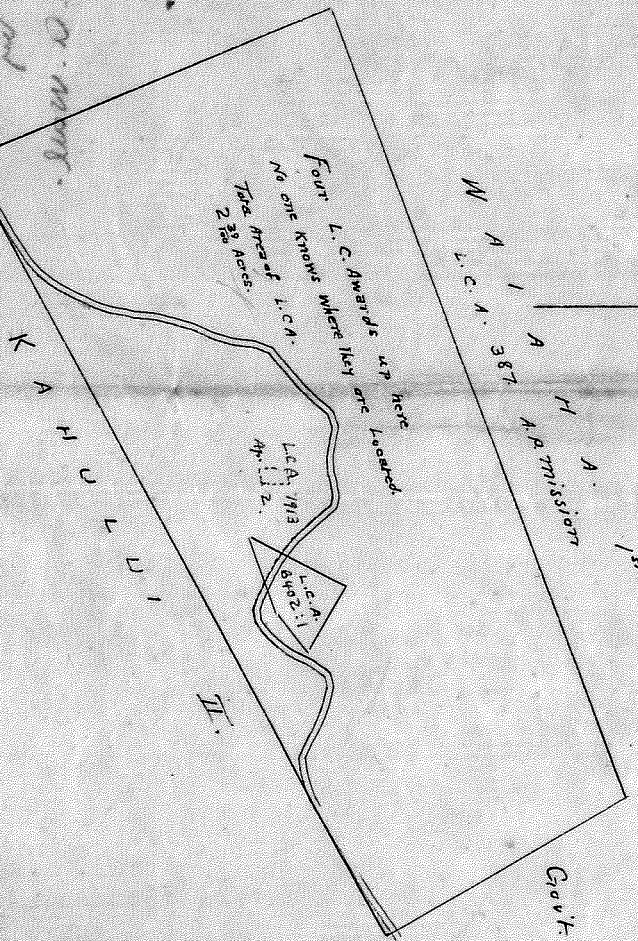

Scale 500 F = inch.