

IT IS AGREED that this map is the map referred to and made a part of the LEASE between the KANEHOE RANCH CO. LTD. and LIBBY, McNEILL & LIBBY OF HONOLULU LTD., dated Sept. 22, 1914.

Dated at Honolulu this 22nd day of Sept. 1914.

KANEHOE RANCH CO. LTD.
by its President *D. L. Williams*
by its Treasurer *H. K. Castle*

LIBBY, McNEILL & LIBBY OF HONOLULU, LTD.
by its President *H. K. Castle*
by its Treasurer *H. K. Castle*

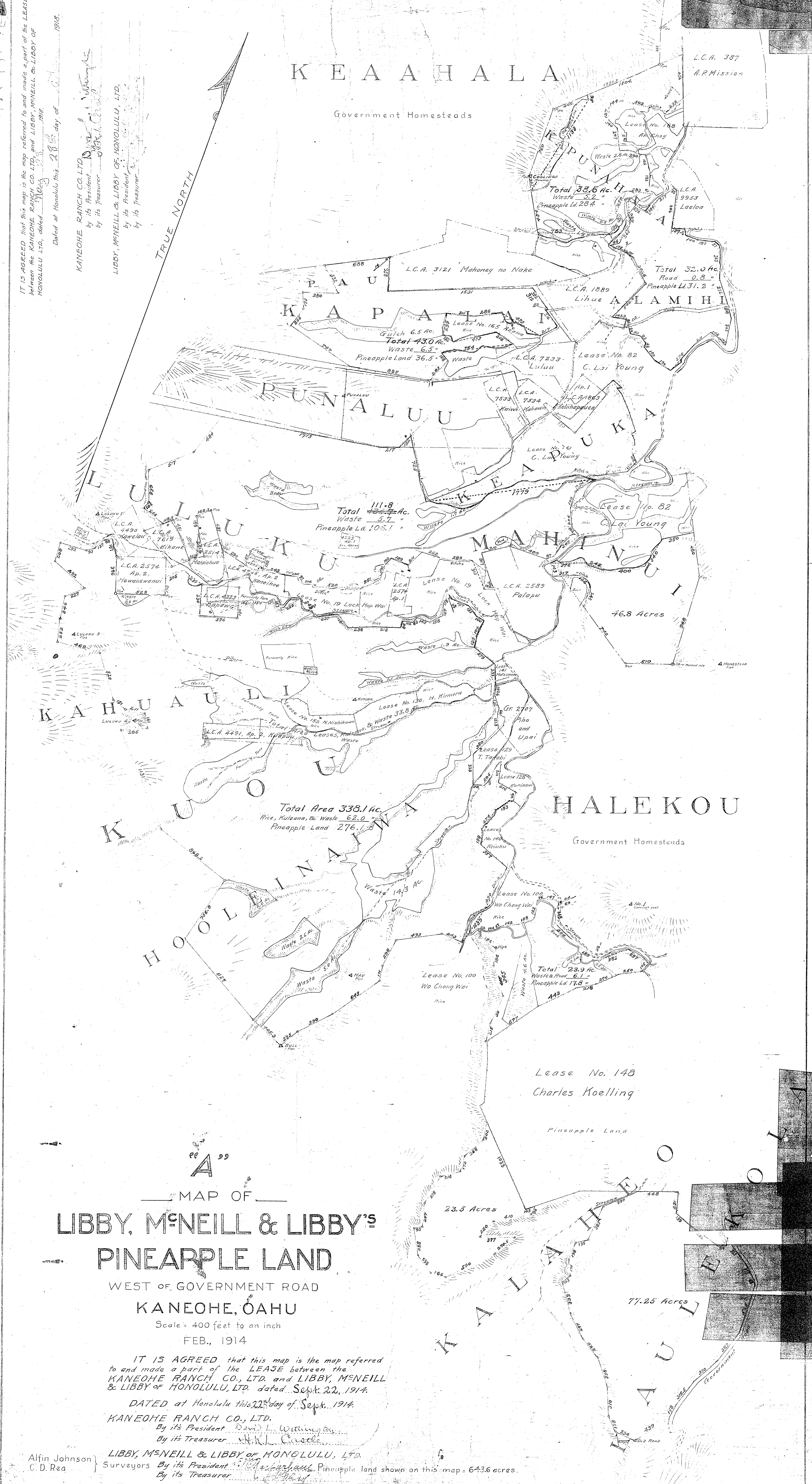

MAP OF
**LIBBY, McNEILL & LIBBY'S
PINEAPPLE LAND**

WEST OF GOVERNMENT ROAD
KANEHOE, OAHU
Scale: 400 feet to an inch
FEB., 1914

IT IS AGREED that this map is the map referred to and made a part of the LEASE between the KANEHOE RANCH CO., LTD. and LIBBY, McNEILL & LIBBY OF HONOLULU, LTD. dated Sept. 22, 1914.

DATED at Honolulu this 22nd day of Sept. 1914.
KANEHOE RANCH CO., LTD.
By its President *D. L. Williams*
By its Treasurer *H. K. Castle*

Alfin Johnson } LIBBY, McNEILL & LIBBY OF HONOLULU, LTD.
C. D. Rea } Surveyors By its President *H. K. Castle*
By its Treasurer *H. K. Castle*

Pineapple land shown on this map = 643.6 acres.