

K O H E O

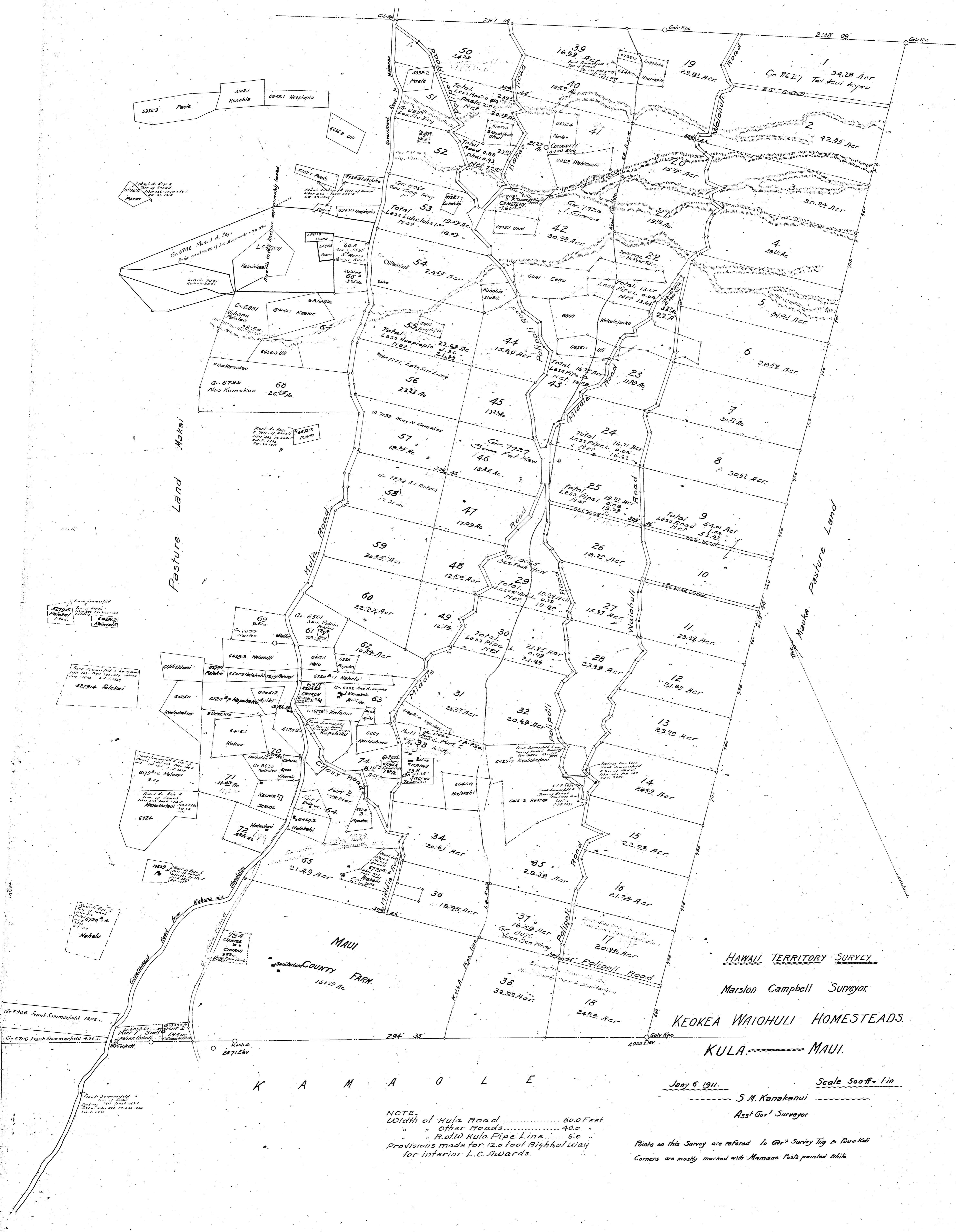

HAWAII TERRITORY SURVEY,
 Marston Campbell Surveyor.
 KEOKEA WAIQHULI HOMESTEADS.
 KULA. MAUI.

Jan'y 6, 1911. Scale 500ft = 1 in
 S. M. Kananui
 Asst. Govt. Surveyor

NOTE:
 Width of Kula Road..... 60.0 Feet
 " " " other Roads..... 40.0 "
 " " " R.O.W. Kula Pipe Line..... 6.0 "
 Provisions made for 12.0 foot Right of Way
 for interior L.C. Awards.

Points on this Survey are referred to Gov't Survey Tty & Buvo Kali
 Corners are mostly marked with Mamane Posts painted white

K A M A O L E