

MAP OF THE
AHUPUAA OF KAHANANUI
 ISLAND OF MOLOKAI

1/2 TERRITORY OF HAWAII (PAGE 2168, R.L. OF HAWAII 1925)
 1/2 MAHELE AWARD 48 TO KAELIWAI
 ACCOMPANYING APPLICATION FOR SETTLEMENT OF BOUNDARIES
 BY THE TERRITORY OF HAWAII, OWNER OF ONE-HALF INTEREST, AND
 MRS. HATTIE KAHELE FOUNTAIN AND MRS. SARAH KALEI KEKOA
 HEIRS OF C.W. KALAMA, DECEASED, OWNER OF ONE-FOURTH
 UNDIVIDED INTEREST, FILED

SCALE: 1 INCH = 500 FEET

MAP COMPILED FROM SURVEYS MADE BY
 M.D. MONSARRAT IN MAY, 1897,
 JAMES M. DUNN IN OCTOBER, 1931,
 THOMAS J.K. EVANS IN JANUARY, 1937.

TERRITORY OF HAWAII
 BY *[Signature]*
 COMMISSIONER OF PUBLIC LANDS

MRS. HATTIE KAHELE FOUNTAIN
 BY *and Hattie Kahele Fountain*

MRS. SARAH KALEI KEKOA
 BY *and Sarah Kalei Kekoa*
Per Mrs. Rellia Defalon
 (daughter)

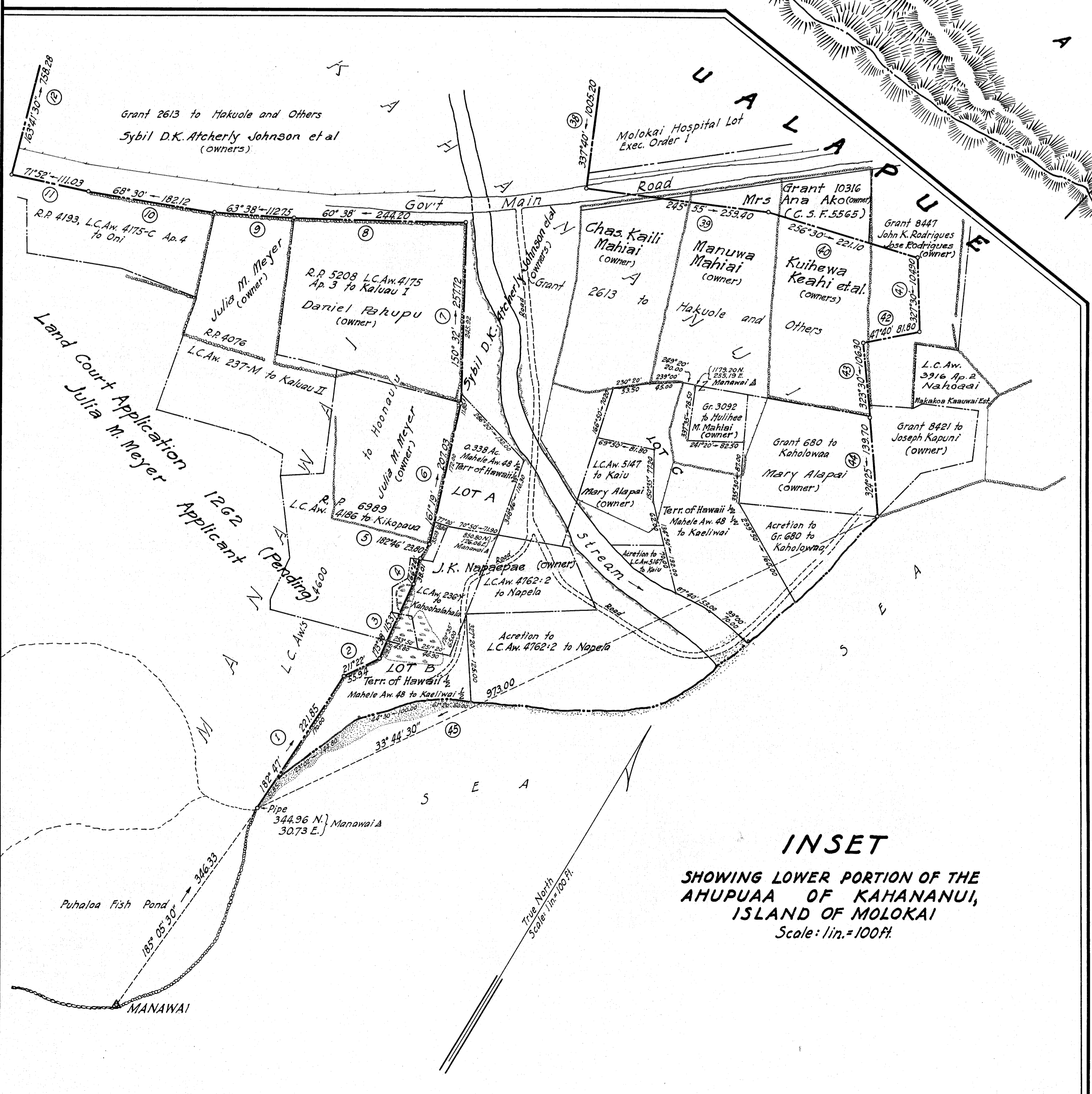

INSET
 SHOWING LOWER PORTION OF THE
 AHUPUAA OF KAHANANUI,
 ISLAND OF MOLOKAI
 Scale: 1 in. = 100 ft.

Total Area of Ahupuaa	307.89 Acres
Area of Grants	18.30 Acres
Area of L.C. Awards	3.61 Acres
Net Area to Applicants	285.98 Acres

NOTE:
 ① Denotes Number of Course in Description of Survey.
 Owners of Adjoining Lands From Taxation Maps Bureau.