

Note: This survey has been made from the stone monuments established on center lines of Oahu Kamehameha avenues as shown.

Sizes of Water Mains
 6 inches in diameter
 3
 1 1/2

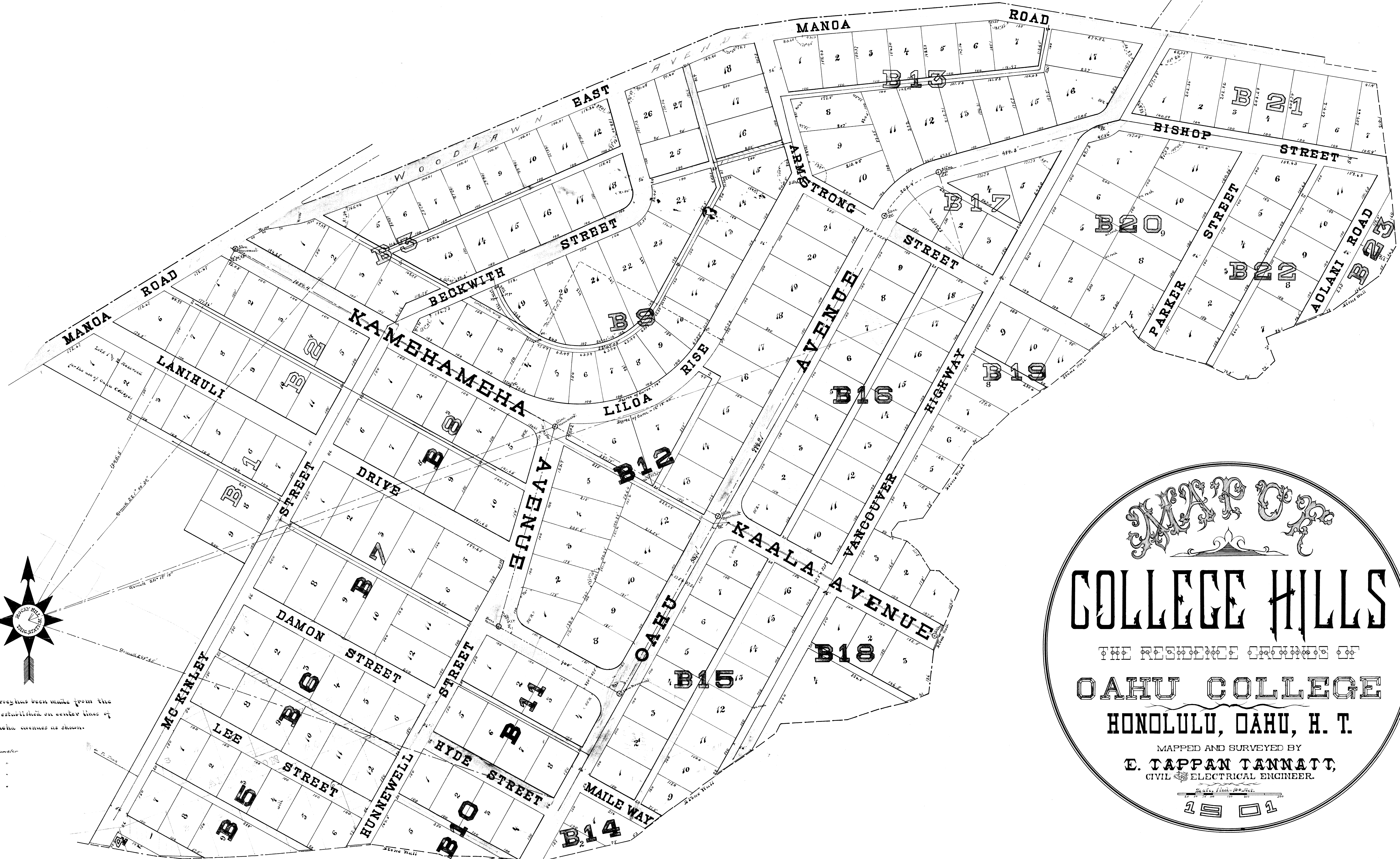

COLLEGE HILLS
 THE RESIDENCE GROUNDS OF
OAHU COLLEGE
 HONOLULU, OAHU, H. T.
 MAPPED AND SURVEYED BY
E. CAPPAN TANNATT,
 CIVIL ELECTRICAL ENGINEER.
 Scale 1 inch = 100 feet.
 1901

E. C. Tannatt

4 5 2 2528